

N 1/2 20-36-20 SHT. NO. 543

N 1/2 22-36-20 SHT. NO. 547

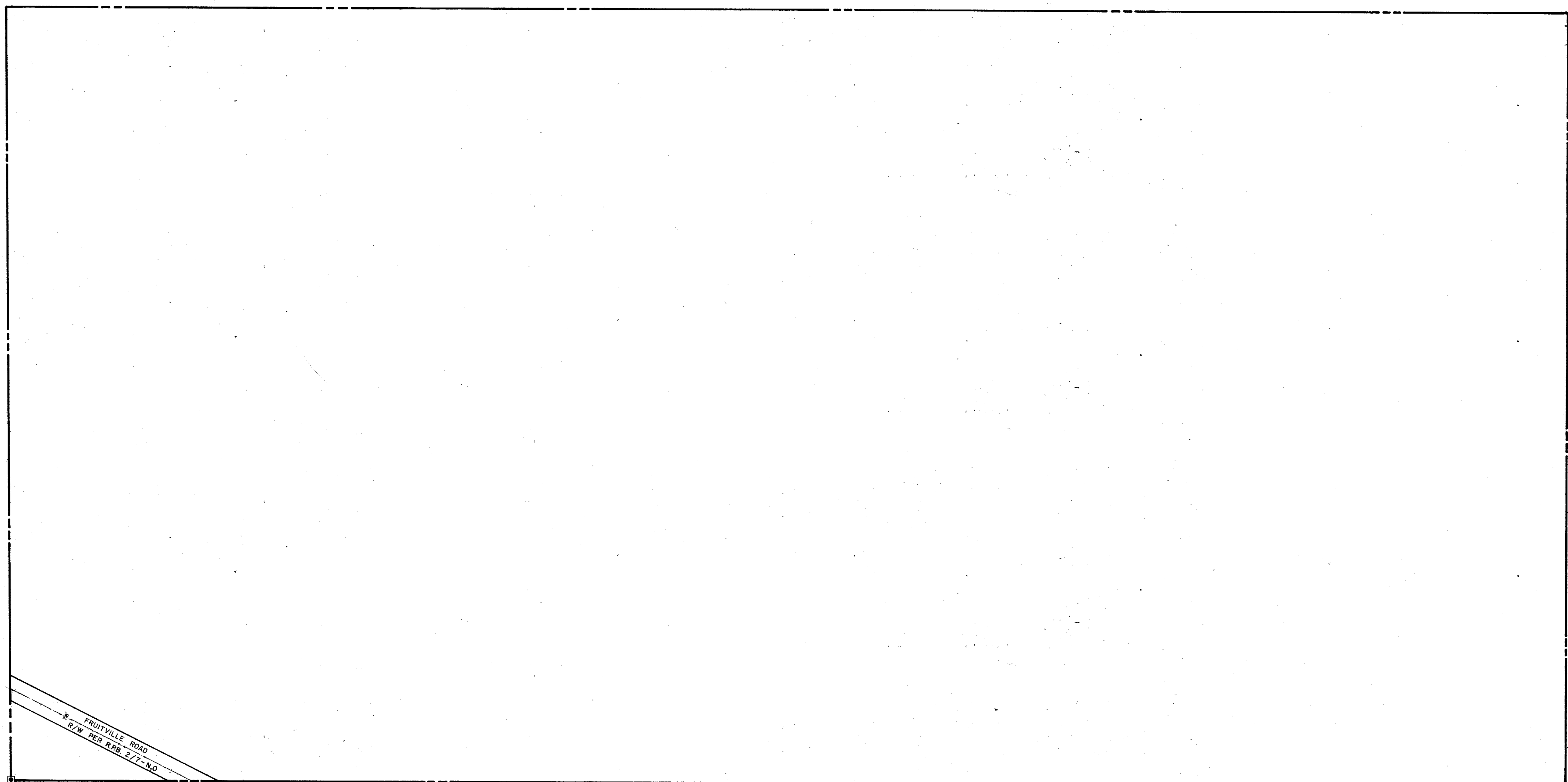

SEC. COR. 1267

SEC. COR. 1389

SUBDIVISION INDEX

NO.	NAME

- LEGEND:
- ☐ County Section Corner Monument
 - ⊕ County Bench Mark
 - Permanent Ref. Mon. for Subs.
 - ① Subdivision Index Number

REVISIONS	
DATE	DESCRIPTION
JULY 1990	ADDED FRUITVILLE RD. R/W

SARASOTA COUNTY, FLORIDA

Scale: 1" = 200' Date: JULY 1990

Drawn By: SDS

N. 1/2 SECTION 21
TWP. 36 S. RGE. 20 E.

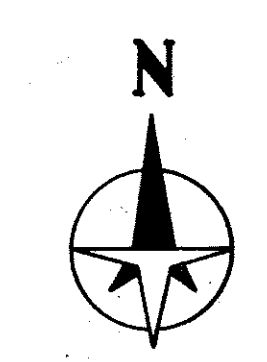

Sheet No.

545