

BUP 2003 - 03458

U.S. DEPARTMENT OF HOMELAND SECURITY
Federal Emergency Management Agency
National Flood Insurance Program

ELEVATION CERTIFICATE

OMB No. 1660-0008
Expires February 28, 2009

Important: Read the instructions on pages 1-8.

03-044477

SECTION A - PROPERTY INFORMATION

A1. Building Owner's Name GEORGE & WANDA OLIVIER

A2. Building Street Address (including Apt., Unit, Suite, and/or Bldg. No.) or P.O. Route and Box No.
801 CASEY KEY ROAD

City NOKOMIS State FLORIDA ZIP Code 34275

A3. Property Description (Lot and Block Numbers, Tax Parcel Number, Legal Description, etc.)
PART OF LOT 16, TREASURE ISLAND SHORES SUBDIVISION (SEE SURVEY)

A4. Building Use (e.g., Residential, Non-Residential, Addition, Accessory, etc.) RESIDENTIAL

A5. Latitude/Longitude: Lat. 27.13458 N. Long. 82.47421 W. Horizontal Datum: NAD 1927 NAD 1983

A6. Attach at least 2 photographs of the building if the Certificate is being used to obtain flood insurance.

A7. Building Diagram Number 5

A8. For a building with a crawl space or enclosure(s), provide:
a) Square footage of crawl space or enclosure(s) _____ sq ft
b) No. of permanent flood openings in the crawl space or enclosure(s) walls within 1.0 foot above adjacent grade _____
c) Total net area of flood openings in A8.b _____ sq ft

A9. For a building with an attached garage, provide:
a) Square footage of attached garage 400 sq ft
b) No. of permanent flood openings in the attached garage walls within 1.0 foot above adjacent grade _____
c) Total net area of flood openings in A9.b _____ sq ft

SECTION B - FLOOD INSURANCE RATE MAP (FIRM) INFORMATION

B1. NFIP Community Name & Community Number
NOKOMIS 125144

B2. County Name SARASOTA

B3. State FLORIDA

B4. Map/Panel Number <u>0239</u>	B5. Suffix <u>D</u>	B6. FIRM Index Date <u>5/1/84</u>	B7. FIRM Panel Effective/Revised Date <u>5/1/84</u>	B8. Flood Zone(s) <u>A-12</u>	B9. Base Flood Elevation(s) (Zones, AO, use base flood depth) <u>11.0</u>
-------------------------------------	------------------------	--------------------------------------	--	----------------------------------	--

B10. Indicate the source of the Base Flood Elevation (BFE) data or base flood depth entered in Item B9.
 FIS Profile FIRM Community Determined Other (Describe) _____

B11. Indicate elevation datum used for BFE in Item B9: NGVD 1929 NAVD 1988 Other (Describe) _____

B12. Is the building located in a Coastal Barrier Resources System (CBRS) area or Otherwise Protected Area (OPA)? Yes No
Designation Date _____ CBRS OPA

SECTION C - BUILDING ELEVATION INFORMATION (SURVEY REQUIRED)

C1. Building elevations are based on: Construction Drawings* Building Under Construction* Finished Construction
*A new Elevation Certificate will be required when construction of the building is complete.

C2. Elevations - Zones A1-A30, AE, AH, A (with BFE), VE, V1-V30, V (with BFE), AR, AR/A, AR/AE, AR/A1-A30, AR/AH, AR/AO. Complete Items C2.a-g below according to the building diagram specified in Item A7.

Benchmark Utilized D.N.R. MONUMENT B-14 Vertical Datum 1929 N.G.V.D

Conversion/Comments BUILDING ON PILES, GARAGE FLOOR BELOW HAS BREAKAWAY WALLS

Check the measurement used:

a) Top of bottom floor (including basement, crawl space, or enclosure floor)	<u>13 LIVING FLOOR</u>	<u>20.3</u> <input checked="" type="checkbox"/> feet	<input type="checkbox"/> meters (Puerto Rico only)
b) Top of the next higher floor	<u>NA</u>	_____ <input type="checkbox"/> feet	<input type="checkbox"/> meters (Puerto Rico only)
c) Bottom of the lowest horizontal structural member (V Zones only)	<u>NA</u>	_____ <input type="checkbox"/> feet	<input type="checkbox"/> meters (Puerto Rico only)
d) Attached garage (top of slab)	<u>GARAGE FLOOR BELOW LIVING FLOOR</u>	<u>12.4</u> <input checked="" type="checkbox"/> feet	<input type="checkbox"/> meters (Puerto Rico only)
e) Lowest elevation of machinery or equipment servicing the building (Describe type of equipment in Comments)	<u>A/C'S OUTSIDE</u>	<u>11.7</u> <input checked="" type="checkbox"/> feet	<input type="checkbox"/> meters (Puerto Rico only)
f) Lowest adjacent (finished) grade (LAG)		<u>11.6</u> <input checked="" type="checkbox"/> feet	<input type="checkbox"/> meters (Puerto Rico only)
g) Highest adjacent (finished) grade (HAG)		<u>12.2</u> <input checked="" type="checkbox"/> feet	<input type="checkbox"/> meters (Puerto Rico only)

SECTION D - SURVEYOR, ENGINEER, OR ARCHITECT CERTIFICATION

This certification is to be signed and sealed by a land surveyor, engineer, or architect authorized by law to certify elevation information. I certify that the information on this Certificate represents my best efforts to interpret the data available. I understand that any false statement may be punishable by fine or imprisonment under 18 U.S. Code, Section 1001.

Check here if comments are provided on back of form.

Certifier's Name BRUCE LINDH License Number P.L.S. 4306

Title LAND SURVEYOR Company Name BRUCE LINDH LAND SURVEYOR, INC.

Address 1380 CAMBRIDGE DR. City VENICE State FL. ZIP Code 34293

Signature Bruce Lindh Date 6/14/07 Telephone 941-488-6612

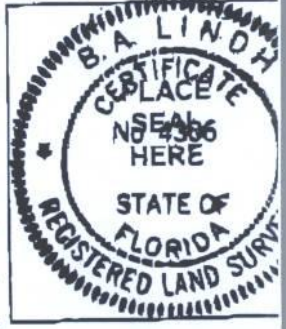

IMPORTANT: In these spaces, copy the corresponding information from Section A.

Building Street Address (Including Apt., Unit, Suite, and/or Bldg. No.) or P.O. Route and Box No.

City State ZIP Code

SECTION D - SURVEYOR, ENGINEER, OR ARCHITECT CERTIFICATION (CONTINUED)

Copy both sides of this Elevation Certificate for (1) community official, (2) insurance agent/company, and (3) building owner.

Comments

Signature

Date

Check here if attachment

SECTION E - BUILDING ELEVATION INFORMATION (SURVEY NOT REQUIRED) FOR ZONE AO AND ZONE A (WITHOUT BFE)

For Zones AO and A (without BFE), complete items E1-E5. If the Certificate is intended to support a LOMA or LOMR-F request, complete Sections A, B, and C. For items E1-E4, use natural grade, if available. Check the measurement used. In Puerto Rico only, enter meters.

- E1. Provide elevation information for the following and check the appropriate boxes to show whether the elevation is above or below the highest adjacent grade (HAG) and the lowest adjacent grade (LAG).
 - a) Top of bottom floor (including basement, crawl space, or enclosure) is _____ feet _____ meters above or below the HAG.
 - b) Top of bottom floor (including basement, crawl space, or enclosure) is _____ feet _____ meters above or below the LAG.
- E2. For Building Diagrams 6-8 with permanent flood openings provided in Section A items 8 and/or 9 (see page 8 of Instructions), the next higher floor (elevation C2.b in the diagrams) of the building is _____ feet _____ meters above or below the HAG.
- E3. Attached garage (top of slab) is _____ feet _____ meters above or below the HAG.
- E4. Top of platform of machinery and/or equipment servicing the building is _____ feet _____ meters above or below the HAG.
- E5. Zone AO only: If no flood depth number is available, is the top of the bottom floor elevated in accordance with the community's floodplain management ordinance? Yes No Unknown. The local official must certify this information in Section G.

SECTION F - PROPERTY OWNER (OR OWNER'S REPRESENTATIVE) CERTIFICATION

The property owner or owner's authorized representative who completes Sections A, B, and E for Zone A (without a FEMA-issued or community-issued BFE) or Zone AO must sign here. The statements in Sections A, B, and E are correct to the best of my knowledge.

Property Owner's or Owner's Authorized Representative's Name

Address City State ZIP Code

Signature Date Telephone

Comments

Check here if attachment

SECTION G - COMMUNITY INFORMATION (OPTIONAL)

The local official who is authorized by law or ordinance to administer the community's floodplain management ordinance can complete Sections A, B, C (or E), and G of this Elevation Certificate. Complete the applicable item(s) and sign below. Check the measurement used in items G8 and G9.

- G1. The information in Section C was taken from other documentation that has been signed and sealed by a licensed surveyor, engineer, or architect who is authorized by law to certify elevation information. (Indicate the source and date of the elevation data in the Comments area below.)
- G2. A community official completed Section E for a building located in Zone A (without a FEMA-issued or community-issued BFE) or Zone AO.
- G3. The following information (items G4.-G9.) is provided for community floodplain management purposes.

G4. Permit Number	G5. Date Permit Issued	G6. Date Certificate Of Compliance/Occupancy Issued
-------------------	------------------------	---

G7. This permit has been issued for: New Construction Substantial Improvement

G8. Elevation of as-built lowest floor (including basement) of the building: _____ feet _____ meters (PR) Datum _____

G9. BFE or (in Zone AO) depth of flooding at the building site: _____ feet _____ meters (PR) Datum _____

Local Official's Name Title

Community Name Telephone

Signature Date

Comments

Check here if attachment

Building Photographs

See Instructions for Item A6.

Building Street Address (including Apt., Unit, Suite, and/or Bldg. No.) or P.O. Route and Box No.

801 CASEY KEY ROAD

City

NOKOMIS

State

FLORIDA

ZIP Code

34275

If using the Elevation Certificate to obtain NFIP flood insurance, affix at least two building photographs below according to the instructions for Item A6. Identify all photographs with: date taken; "Front View" and "Rear View"; and, if required, "Right Side View" and "Left Side View." If submitting more photographs than will fit on this page, use the Continuation Page, following.



FRONT VIEW



REAR VIEW