

ELEVATION CERTIFICATE

OMB No. 1660-0008
 Expiration Date: November 30, 2018

IMPORTANT: In these spaces, copy the corresponding information from Section A.

Building Street Address (including Apt., Unit, Suite, and/or Bldg. No.) or P.O. Route and Box No. 1200 ORANGE AVE		FOR INSURANCE COMPANY USE Policy Number:
City NOKOMIS	State Florida	Company NAIC Number
	ZIP Code 34275	

SECTION G – COMMUNITY INFORMATION (OPTIONAL)

The local official who is authorized by law or ordinance to administer the community's floodplain management ordinance can complete Sections A, B, C (or E), and G of this Elevation Certificate. Complete the applicable item(s) and sign below. Check the measurement used in Items G8–G10. In Puerto Rico only, enter meters.

- G1. The information in Section C was taken from other documentation that has been signed and sealed by a licensed surveyor, engineer, or architect who is authorized by law to certify elevation information. (Indicate the source and date of the elevation data in the Comments area below.)
- G2. A community official completed Section E for a building located in Zone A (without a FEMA-issued or community-issued BFE) or Zone AO.
- G3. The following information (Items G4–G10) is provided for community floodplain management purposes.

G4. Permit Number 17-111995 B1	G5. Date Permit Issued	G6. Date Certificate of Compliance/Occupancy Issued
--	------------------------	---

- G7. This permit has been issued for: New Construction Substantial Improvement
- G8. Elevation of as-built lowest floor (including basement) of the building: _____ feet meters Datum _____
- G9. BFE or (in Zone AO) depth of flooding at the building site: _____ feet meters Datum _____
- G10. Community's design flood elevation: _____ feet meters Datum _____

Local Official's Name	Title
Community Name	Telephone
Signature	Date

Comments (including type of equipment and location, per C2(e), if applicable)

Check here if attachments.

ELEVATION CERTIFICATE

Important: Follow the instructions on pages 1-9.

Copy all pages of this Elevation Certificate and all attachments for (1) community official, (2) insurance agent/company, and (3) building owner.

SECTION A - PROPERTY INFORMATION

SECTION A - PROPERTY INFORMATION		FOR INSURANCE COMPANY USE	
A1. Building Owner's Name GEORGE W & HEIKE CORDERO		Policy Number:	
A2. Building Street Address (including Apt., Unit, Suite, and/or Bldg. No.) or P.O. Route and Box No. 1200 ORANGE AVE		Company NAIC Number:	
City NOKOMIS	State Florida	ZIP Code 34275	
A3. Property Description (Lot and Block Numbers, Tax Parcel Number, Legal Description, etc.) LOTS 35 & PT LOT 34, HIDDEN BAY ESTATES PID# 0383020021 & 0383020020			

A4. Building Use (e.g., Residential, Non-Residential, Addition, Accessory, etc.) RESIDENTIAL

A5. Latitude/Longitude: Lat. 27°08'13.91"N Long. 82°26'19.6"W Horizontal Datum: NAD 1927 NAD 1983

A6. Attach at least 2 photographs of the building if the Certificate is being used to obtain flood insurance.

A7. Building Diagram Number 1A

A8. For a building with a crawlspace or enclosure(s):
 a) Square footage of crawlspace or enclosure(s) N/A sq ft

b) Number of permanent flood openings in the crawlspace or enclosure(s) within 1.0 foot above adjacent grade 0

c) Total net area of flood openings in A8;b 0.00 sq in

d) Engineered flood openings? Yes No

A9. For a building with an attached garage:

a) Square footage of attached garage 489.00 sq ft

b) Number of permanent flood openings in the attached garage within 1.0 foot above adjacent grade 0

c) Total net area of flood openings in A9;b 0.00 sq in

d) Engineered flood openings? Yes No

SECTION B - FLOOD INSURANCE RATE MAP (FIRM) INFORMATION

B1. NFIP Community Name & Community Number SARASOTA 125144		B2. County Name SARASOTA	B3. State Florida
---	--	-----------------------------	----------------------

B4. Map/Panel Number 12115C 0239	B5. Suffix F	B6. FIRM Index Date 11-04-2016	B7. FIRM Panel Effective/ Revised Date 11-04-2016	B8. Flood Zone(s) AE	B9. Base Flood Elevation(s) (Zone AO, use Base Flood Depth) 10
-------------------------------------	-----------------	-----------------------------------	--	-------------------------	---

B10. Indicate the source of the Base Flood Elevation (BFE) data or base flood depth entered in Item B9:
 FIS Profile FIRM Community Determined Other/Source: _____

B11. Indicate elevation datum used for BFE in Item B9: NGVD 1929 NAVD 1988 Other/Source: _____

B12. Is the building located in a Coastal Barrier Resources System (CBRS) area or Otherwise Protected Area (OPA)? Yes No
 Designation Date: _____ CBRS OPA

ELEVATION CERTIFICATE

OMB No. 1660-0008
Expiration Date: November 30, 2018

IMPORTANT: In these spaces, copy the corresponding information from Section A.

FOR INSURANCE COMPANY USE

Building Street Address (including Apt., Unit, Suite, and/or Bldg. No.) or P.O. Route and Box No.
1200 ORANGE AVE

Policy Number:

City NOKOMIS State Florida ZIP Code 34275

Company NAIC Number

SECTION C - BUILDING ELEVATION INFORMATION (SURVEY REQUIRED)

C1. Building elevations are based on: Construction Drawings* Building Under Construction* Finished Construction
*A new Elevation Certificate will be required when construction of the building is complete.

C2. Elevations - Zones A1-A30, AE, AH, A (with BFE), VE, V1-V30, V (with BFE), AR, AR/A, AR/AE, AR/A1-A30, AR/AH, AR/AO.
Complete items C2.a-h below according to the building diagram specified in Item A7. In Puerto Rico only, enter meters.

Benchmark Utilized: SARASOTA CO BM 383-H Vertical Datum: NGVD

Indicate elevation datum used for the elevations in items a) through h) below.

NGVD 1929 NAVD 1988 Other/Source: _____

Datum used for building elevations must be the same as that used for the BFE.

Check the measurement used.

- a) Top of bottom floor (including basement, crawspace, or enclosure floor) _____ 12.48 feet meters
- b) Top of the next higher floor _____ N/A feet meters
- c) Bottom of the lowest horizontal structural member (V Zones only) _____ N/A feet meters
- d) Attached garage (top of slab) _____ 10.79 feet meters
- e) Lowest elevation of machinery or equipment servicing the building (Describe type of equipment and location in Comments) _____ 11.81 feet meters
- f) Lowest adjacent (finished) grade next to building (LAG) _____ 10.20 feet meters
- g) Highest adjacent (finished) grade next to building (HAG) _____ 11.00 feet meters
- h) Lowest adjacent grade at lowest elevation of deck or stairs, including structural support _____ 10.50 feet meters

SECTION D - SURVEYOR, ENGINEER, OR ARCHITECT CERTIFICATION

This certification is to be signed and sealed by a land surveyor, engineer, or architect authorized by law to certify elevation information. I certify that the information on this Certificate represents my best efforts to interpret the data available. I understand that any false statement may be punishable by fine or imprisonment under 18 U.S. Code, Section 1001.

Were latitude and longitude in Section A provided by a licensed land surveyor? Yes No Check here if attachments.

Certifier's Name LAWRENCE R. WEBER License Number 3868

Title PROFESSIONAL SURVEYOR & MAPPER

Company Name WEBER ENGINEERING & SURVEYING, INC.

Address 4596 ASHTON ROAD
City SARASOTA State Florida ZIP Code 34233

Signature *Lawrence R. Weber* Date 12/29/2017 Telephone (941) 921-3914 Ext.

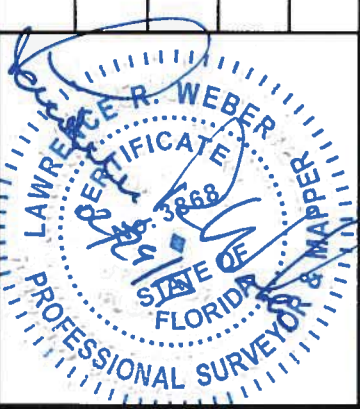

Copy all pages of this Elevation Certificate and all attachments for (1) community official, (2) insurance agent/company, and (3) building owner.

Comments (including type of equipment and location, per C2(e), if applicable)

C2.e - A/C - REAR OF BUILDING

C2.h - POOL DECK

A5 - LAT/LONG FROM FEMA INTERACTIVE MAP

Data in C2.a-h is only accurate to 0.1'; ignore the second decimal place, as this is automatically added by the FEMA form.

ELEVATION CERTIFICATE

OMB No. 1660-0008
 Expiration Date: November 30, 2018

IMPORTANT: In these spaces, copy the corresponding information from Section A.

FOR INSURANCE COMPANY USE

Building Street Address (including Apt., Unit, Suite, and/or Bldg. No.) or P.O. Route and Box No.
 1200 ORANGE AVE

Policy Number:

City NOKOMIS State Florida ZIP Code 34275

Company/NAIC Number

**SECTION E – BUILDING ELEVATION INFORMATION (SURVEY NOT REQUIRED)
 FOR ZONE AO AND ZONE A (WITHOUT BFE)**

For Zones AO and A (without BFE), complete Items E1–E5. If the Certificate is intended to support a LOMA or LOMR-F request, complete Sections A, B, and C. For Items E1–E4, use natural grade, if available. Check the measurement used. In Puerto Rico only, enter meters.

- E1. Provide elevation information for the following and check the appropriate boxes to show whether the elevation is above or below the highest adjacent grade (HAG) and the lowest adjacent grade (LAG).
- a) Top of bottom floor (including basement, crawlspace, or enclosure) is _____ feet meters above or below the HAG.
 - b) Top of bottom floor (including basement, crawlspace, or enclosure) is _____ feet meters above or below the LAG.
- E2. For Building Diagrams 6–9 with permanent flood openings provided in Section A Items 8 and/or 9 (see pages 1–2 of Instructions), the next higher floor (elevation C2.b in the diagrams) of the building is _____ feet meters above or below the HAG.
- E3. Attached garage (top of slab) is _____ feet meters above or below the HAG.
- E4. Top of platform of machinery and/or equipment servicing the building is _____ feet meters above or below the HAG.
- E5. Zone AO only: If no flood depth number is available, is the top of the bottom floor elevated in accordance with the community's floodplain management ordinance? Yes No Unknown. The local official must certify this information in Section G.

SECTION F – PROPERTY OWNER (OR OWNER'S REPRESENTATIVE) CERTIFICATION

The property owner or owner's authorized representative who completes Sections A, B, and E for Zone A (without a FEMA-issued or community-issued BFE) or Zone AO must sign here. The statements in Sections A, B, and E are correct to the best of my knowledge.

Property Owner or Owner's Authorized Representative's Name _____

Address _____ City _____ State _____ ZIP Code _____

Signature _____ Date _____ Telephone _____

Comments _____

Check here if attachments.

BUILDING PHOTOGRAPHS

ELEVATION CERTIFICATE

See Instructions for Item A6.

OMB No. 1660-0008
Expiration Date: November 30, 2018

IMPORTANT: In these spaces, copy the corresponding information from Section A.

FOR INSURANCE COMPANY USE

Building Street Address (including Apt., Unit, Suite, and/or Bldg. No.) or P.O. Route and Box No.
1200 ORANGE AVE

Policy Number:

City
NOKOMIS

State
Florida

ZIP Code
34275

Company NAIC Number

If using the Elevation Certificate to obtain NFIP flood insurance, affix at least 2 building photographs below according to the instructions for Item A6. Identify all photographs with date taken; "Front View" and "Rear View"; and, if required, "Right Side View" and "Left Side View." When applicable, photographs must show the foundation with representative examples of the flood openings or vents, as indicated in Section A8. If submitting more photographs than will fit on this page, use the Continuation Page.



Photo One

Photo One Caption FRONT VIEW 12/29/17

Clear Photo One



Photo Two

Photo Two Caption REAR VIEW 12/29/17

Clear Photo Two

BUILDING PHOTOGRAPHS

Continuation Page

OMB No. 1680-0008
Expiration Date: November 30, 2018

ELEVATION CERTIFICATE

IMPORTANT: In these spaces, copy the corresponding information from Section A.

FOR INSURANCE COMPANY USE

Building Street Address (including Apt., Unit, Suite, and/or Bldg. No.) or P. O. Route and Box No.
1200 ORANGE AVE

Policy Number:

City NOKOMIS State Florida ZIP Code 34275

Company NAIC Number

If submitting more photographs than will fit on the preceding page, affix the additional photographs below. Identify all photographs with: date taken; "Front View" and "Rear View"; and, if required, "Right Side View" and "Left Side View." When applicable, photographs must show the foundation with representative examples of the flood openings or vents, as indicated in Section A8.



Photo Three

Clear Photo Three

Photo Three Caption RIGHT SIDE VIEW 12/29/17



Photo Four

Clear Photo Four

Photo Four Caption LEFT SIDE VIEW 12/29/17