

15-101340 BA

13-5124P15 [FI]

ELEVATION CERTIFICATE

Important: Read the instructions on pages 1-9.

OMB No. 1660-0008
Expiration Date: July 31, 2015

SECTION A - PROPERTY INFORMATION

FOR INSURANCE COMPANY USE

A1. Building Owner's Name STEVENS LAND TRUST

Policy Number:

A2. Building Street Address (including Apt., Unit, Suite, and/or Bldg. No.) or P.O. Route and Box No.
#7315 PERIWINKLE DR

Company NAIC Number:

City SARASOTA

State FL ZIP Code 34231

A3. Property Description (Lot and Block Numbers, Tax Parcel Number, Legal Description, etc.)
LOT 9, BLOCK "C", AMENDED PLAT OF BLOCK "C", CORAL COVE UNIT 3

A4. Building Use (e.g., Residential, Non-Residential, Addition, Accessory, etc.) GARAGE DETACHED

A5. Latitude/Longitude: Lat. 27.24230 Long. -82.53016 Horizontal Datum: NAD 1927 NAD 1983

A6. Attach at least 2 photographs of the building if the Certificate is being used to obtain flood insurance.

A7. Building Diagram Number 1A

A8. For a building with a crawlspace or enclosure(s):

- a) Square footage of crawlspace or enclosure(s) NA sq ft
- b) Number of permanent flood openings in the crawlspace or enclosure(s) within 1.0 foot above adjacent grade NA
- c) Total net area of flood openings in A8.b NA sq in
- d) Engineered flood openings? Yes No

A9. For a building with an attached garage:

- a) Square footage of attached garage NA sq ft
- b) Number of permanent flood openings in the attached garage within 1.0 foot above adjacent grade NA
- c) Total net area of flood openings in A9.b NA sq in
- d) Engineered flood openings? Yes No

SECTION B - FLOOD INSURANCE RATE MAP (FIRM) INFORMATION

B1. NFIP Community Name & Community Number
SARASOTA-125144

B2. County Name
SARASOTA

B3. State
FL

B4. Map/Panel Number
15144-0207

B5. Suffix
E

B6. FIRM Index Date
9-3-92

B7. FIRM Panel Effective/Revised Date
9-3-92

B8. Flood Zone(s)
AE

B9. Base Flood Elevation(s) (Zone AO, use base flood depth)
11'

B10. Indicate the source of the Base Flood Elevation (BFE) data or base flood depth entered in Item B9.

- FIS Profile FIRM Community Determined Other/Source: _____

B11. Indicate elevation datum used for BFE in Item B9: NGVD 1929 NAVD 1988 Other/Source: _____

B12. Is the building located in a Coastal Barrier Resources System (CBRS) area or Otherwise Protected Area (OPA)? Yes No
Designation Date: NA CBRS OPA

SECTION C - BUILDING ELEVATION INFORMATION (SURVEY REQUIRED)

C1. Building elevations are based on: Construction Drawings* Building Under Construction* Finished Construction

*A new Elevation Certificate will be required when construction of the building is complete.

C2. Elevations - Zones A1-A30, AE, AH, A (with BFE), VE, V1-V30, V (with BFE), AR, AR/A, AR/AE, AR/A1-A30, AR/AH, AR/AO. Complete Items C2.a-h below according to the building diagram specified in Item A7. In Puerto Rico only, enter meters.

Benchmark Utilized: 110-A

Vertical Datum: NGVD 29

Indicate elevation datum used for the elevations in items a) through h) below. NGVD 1929 NAVD 1988 Other/Source: _____

Datum used for building elevations must be the same as that used for the BFE.

Check the measurement used.

- a) Top of bottom floor (including basement, crawlspace, or enclosure floor) 11.3 feet meters
- b) Top of the next higher floor NA feet meters
- c) Bottom of the lowest horizontal structural member (V Zones only) NA feet meters
- d) Attached garage (top of slab) NA feet meters
- e) Lowest elevation of machinery or equipment servicing the building (Describe type of equipment and location in Comments) NA feet meters
- f) Lowest adjacent (finished) grade next to building (LAG) 10.6 feet meters
- g) Highest adjacent (finished) grade next to building (HAG) 11.1 feet meters
- h) Lowest adjacent grade at lowest elevation of deck or stairs, including structural support NA feet meters

SECTION D - SURVEYOR, ENGINEER, OR ARCHITECT CERTIFICATION

This certification is to be signed and sealed by a land surveyor, engineer, or architect authorized by law to certify elevation information. I certify that the information on this Certificate represents my best efforts to interpret the data available. I understand that any false statement may be punishable by fine or imprisonment under 18 U.S. Code, Section 1001.

- Check here if comments are provided on back of form. Were latitude and longitude in Section A provided by a licensed land surveyor? Yes No
- Check here if attachments.

Certifier's Name LELAND E. BEDWELL

License Number PSM#5884

Title REGISTERED SURVEYOR

Company Name LELAND E. BEDWELL SURVEYING, INC.

Address 3423 55TH DRIVE EAST

City BRADENTON

State FL ZIP Code 34203

Signature

Date 9-16-2015

Telephone 941-758-6780

Digitally signed by LELAND E. BEDWELL
DN: cn=LELAND E. BEDWELL, o=LELAND E. BEDWELL SURVEYING INC., ou=REGISTERED SURVEYOR and MAPPER, email=lelandbedwell@hotmail.com, c=US
Date: 2015.09.18 14:42:26 -0400

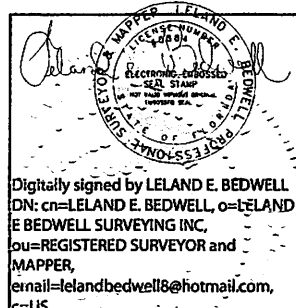

Digitally signed by LELAND E. BEDWELL
DN: cn=LELAND E. BEDWELL, o=LELAND E. BEDWELL SURVEYING INC., ou=REGISTERED SURVEYOR and MAPPER, email=lelandbedwell@hotmail.com, c=US
Date: 2015.09.18 14:42:26 -0400

ELEVATION CERTIFICATE, page 2

IMPORTANT: In these spaces, copy the corresponding information from Section A.		FOR INSURANCE COMPANY USE
Building Street Address (including Apt., Unit, Suite, and/or Bldg. No.) or P.O. Route and Box No. #7315 PERIWINKLE DR		Policy Number:
City SARASOTA	State FL ZIP Code 34231	Company NAIC Number:

SECTION D – SURVEYOR, ENGINEER, OR ARCHITECT CERTIFICATION (CONTINUED)

Copy both sides of this Elevation Certificate for (1) community official, (2) insurance agent/company, and (3) building owner.

Comments JOB # 13-512UP15 [FI], BASE FLOODS ARE SUBJECT TO VERIFICATION—HOUSE LOCATIONS ARE SCALED TO APPROXIMATE PER FEMA MAP PHOTOS TO BE PROVIDED BY OTHERS IF APPLICABLE, LATITUDE LONGITUDE TO BE PROVIDED BY OTHERS IF APPLICABLE, DIAGRAMS ARE SUBJECT TO VERIFICATION AND CHANGE. UPON REVIEW BY OTHERS, BFE TO BE PROVIDED IF APPLICABLE,

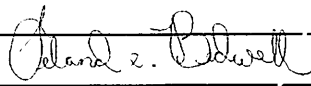
Digitally signed by LELAND E. BEDWELL
 DN: cn=LELAND E. BEDWELL, o=LELAND E. BEDWELL SURVEYING INC, ou=REGISTERED SURVEYOR and MAPPER, email=lelandbedwell8@hotmail.com, c=US
 Signature  Date 9-16-2015

SECTION E – BUILDING ELEVATION INFORMATION (SURVEY NOT REQUIRED) FOR ZONE AO AND ZONE A (WITHOUT BFE)

For Zones AO and A (without BFE), complete Items E1–E5. If the Certificate is intended to support a LOMA or LOMR-F request, complete Sections A, B, and C. For Items E1–E4, use natural grade, if available. Check the measurement used. In Puerto Rico only, enter meters.

- E1. Provide elevation information for the following and check the appropriate boxes to show whether the elevation is above or below the highest adjacent grade (HAG) and the lowest adjacent grade (LAG).
 - a) Top of bottom floor (including basement, crawlspace, or enclosure) is NA feet meters above or below the HAG.
 - b) Top of bottom floor (including basement, crawlspace, or enclosure) is NA feet meters above or below the LAG.
- E2. For Building Diagrams 6–9 with permanent flood openings provided in Section A Items 8 and/or 9 (see pages 8–9 of Instructions), the next higher floor (elevation C2.b in the diagrams) of the building is NA feet meters above or below the HAG.
- E3. Attached garage (top of slab) is NA feet meters above or below the HAG.
- E4. Top of platform of machinery and/or equipment servicing the building is NA feet meters above or below the HAG.
- E5. Zone AO only: If no flood depth number is available, is the top of the bottom floor elevated in accordance with the community's floodplain management ordinance? Yes No Unknown. The local official must certify this information in Section G.

SECTION F – PROPERTY OWNER (OR OWNER'S REPRESENTATIVE) CERTIFICATION

The property owner or owner's authorized representative who completes Sections A, B, and E for Zone A (without a FEMA-issued or community-issued BFE) or Zone AO must sign here. The statements in Sections A, B, and E are correct to the best of my knowledge.

Property Owner's or Owner's Authorized Representative's Name NA

Address NA City NA State FL ZIP Code NA

Signature NA Date NA Telephone NA

Comments NA

Check here if attachments.

SECTION G – COMMUNITY INFORMATION (OPTIONAL)

The local official who is authorized by law or ordinance to administer the community's floodplain management ordinance can complete Sections A, B, C (or E), and G of this Elevation Certificate. Complete the applicable item(s) and sign below. Check the measurement used in Items G8–G10. In Puerto Rico only, enter meters.

- G1. The information in Section C was taken from other documentation that has been signed and sealed by a licensed surveyor, engineer, or architect who is authorized by law to certify elevation information. (Indicate the source and date of the elevation data in the Comments area below.)
- G2. A community official completed Section E for a building located in Zone A (without a FEMA-issued or community-issued BFE) or Zone AO.
- G3. The following information (Items G4–G10) is provided for community floodplain management purposes.

G4. Permit Number <u>NA</u>	G5. Date Permit Issued <u>NA</u>	G6. Date Certificate Of Compliance/Occupancy Issued <u>NA</u>
--------------------------------	-------------------------------------	--

- G7. This permit has been issued for: New Construction Substantial Improvement
- G8. Elevation of as-built lowest floor (including basement) of the building: NA feet meters Datum NA
- G9. BFE or (in Zone AO) depth of flooding at the building site: NA feet meters Datum NA
- G10. Community's design flood elevation: NA feet meters Datum NA

Local Official's Name NA Title NA

Community Name NA Telephone NA

Signature NA Date NA

Comments NA

Check here if attachments.

DATED: 9-16-2015 PROJECT #13-512UP15[F1]

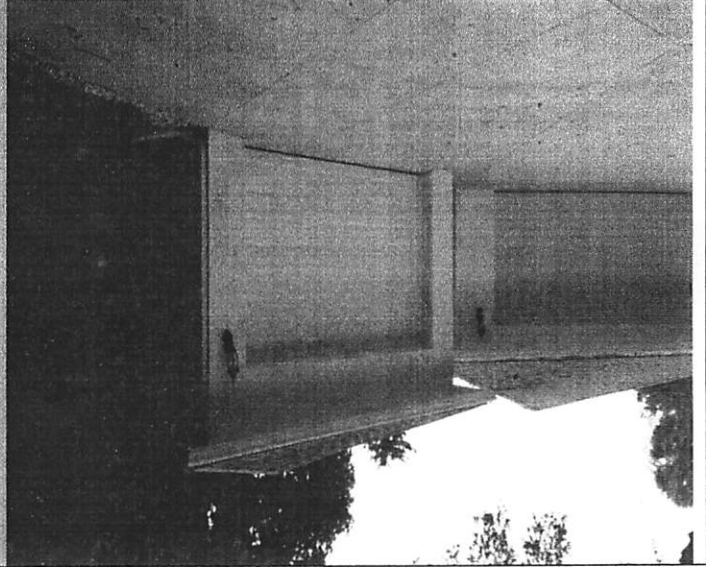
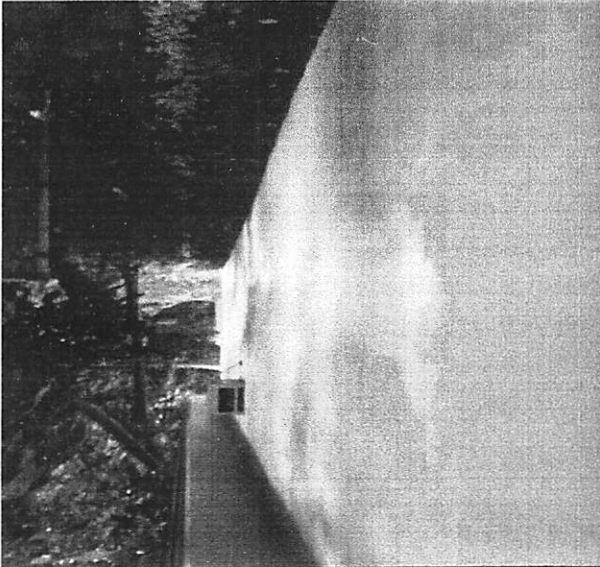
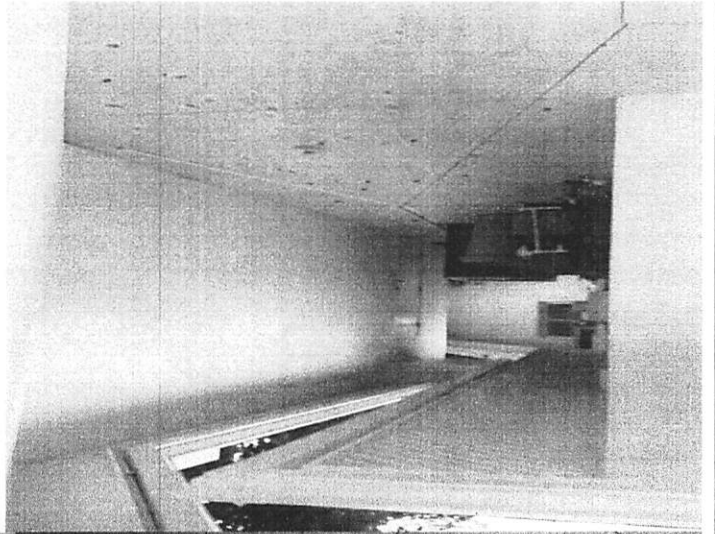

If using the Elevation Certificate to obtain NFIP flood insurance, affix at least 2 building photographs below according to the instructions for Item A6. Identify all photographs with date taken, "Front View" and "Rear View"; and, if required, "Right Side View" and "Left Side View." When applicable, photographs must show the foundation with representative examples of the flood openings or vents, as indicated in Section A8. If submitting more photographs than will fit on this page, use the Continuation Page.

FOR INSURANCE COMPANY USE	Policy Number:	City SARASOTA State FL ZIP Code 34231
	Company NAIC Number:	Building Street Address (including Apt., Unit, Suite, and/or Bldg. No.) or P.O. Route and Box No. #7315 PERIWINKLE DR

Building Photographs

ELEVATION CERTIFICATE, page 3

See Instructions for Item A6.

IMPORTANT: In these spaces, copy the corresponding information from Section A.