

DEPARTMENT OF HOMELAND SECURITY  
Federal Emergency Management Agency  
**ELEVATION CERTIFICATE**

**IMPORTANT: FOLLOW THE INSTRUCTIONS ON PAGES 9-16**

OMB Control Number: 1660-0008  
Expiration: 1/30/2018

Copy all pages of this Elevation Certificate and all attachments for (1) community official, (2) insurance agent/company, and (3) building owner.

**SECTION A - PROPERTY INFORMATION**

FORM INSURANCE COMPANY USE

A1. Building Owner's Name Ashton Tampa Residential, LLC		Policy Number:
A2. Building Street Address (including Apt., Unit, Suite, and/or Bldg. No.) or P.O. Route and Box No. 4550, 4554, 4558, 4562 and 4666 Basket Oak Lane		Company NAIC Number:
City Sarasota	State FL	Zip Code 34232

A3. Property Description (Lot and Block Numbers, Tax Parcel Number, Legal Description, etc.)  
Portion of PID 0040130002 (Lots 1 through 5, of Proposed HAMMOCK PARK)

A4. Building Use (e.g., Residential, Non-Residential, Addition, Accessory, etc.) Residential

A5. Latitude/Longitude: Lat. 27°20'44.24" Long. -82°28'38.05" Horizontal Datum:  NAD 1927  NAD 1983

A6. Attach at least 2 photographs of the building if the Certificate is being used to obtain flood insurance.

A7. Building Diagram Number 1A

A8. For a building with a crawlspace or enclosure(s):

A9. For a building with an attached garage:

- a) Square footage of crawlspace or enclosure(s) N/A sq ft a) Square footage of attached garage N/A sq ft
- b) Number of permanent flood openings in the crawlspace or enclosure(s) within 1.0 foot above adjacent grade N/A b) Number of permanent flood openings in the attached garage within 1.0 foot N/A above adjacent grade
- c) Total net area of flood openings in A8.b N/A sq in c) Total net area of flood openings in A9.b N/A sq in
- d) Engineered flood openings?  Yes  No d) Engineered flood openings?  Yes  No

**SECTION B - FLOOD INSURANCE RATE MAP (FIRM) INFORMATION**

B1. NFIP Community Name & Community Number Sarasota County 125144	B2. County Name Sarasota	B3. State FL
B4. Map/Panel Number 125114 0151	B5. Suffix D	B6. FIRM Index Date May 1, 1994
	B7. FIRM Panel Effective/ Revised Date May 1, 1994	B8. Flood Zone(s) A
		B9. Base Flood Elevation(s) (Zone AO, use base flood depth) 18.33'

B10. Indicate the source of the Base Flood Elevation (BFE) data or base flood depth entered in Item B9:

FIS Profile  FIRM  Community Determined  Other/Source: See comments

B11. Indicate elevation datum used for BFE in Item B9:  NGVD 1929  NAVD 1988  Other/Source:

B12. Is the building located in a Coastal Barrier Resources System (CBRS) area or Otherwise Protected Area (OPA)?  Yes  No  
Designation Date: N/A  CBRS  OPA

**SECTION C - BUILDING ELEVATION INFORMATION (SURVEY REQUIRED)**

C1. Building elevations are based on:  Construction Drawings\*  Building Under Construction\*  Finished Construction  
C2. Elevations - Zones A1 - A30, AE, AH, A (with BFE), VE, V1 - V30, V (with BFE), AR, AR/A, AR/AE, AR/A1 - A30, AR/AH, AR/AO. Complete Items C2.a - h below according to the building diagram specified in Item A7. In Puerto Rico only, enter meters.

\* A new Elevation Certificate will be required when construction of the building is complete.

Benchmark Utilized: Local

Vertical Datum: National Geodetic Vertical Datum of 1929

Indicate elevation datum used for the elevations in items a) through h) below.  NGVD 1929  NAVD 1988

Other/Source:

Datum used for building elevations must be the same as that used for the BFE.

Check the measurement used.

- a) Top of bottom floor (including basement, crawlspace, or enclosure floor) 22.10 -  feet  meters
- b) Top of the next higher floor N/A -  feet  meters
- c) Bottom of the lowest horizontal structural member (V Zones only) N/A -  feet  meters
- d) Attached garage (top of slab) N/A -  feet  meters
- e) Lowest elevation of machinery or equipment servicing the building (Describe type of equipment and location in Comments) 21.57 -  feet  meters
- f) Lowest adjacent (finished) grade next to building (LAG) 21.5 -  feet  meters
- g) Highest adjacent (finished) grade next to building (HAG) 21.7 -  feet  meters
- h) Lowest adjacent grade at lowest elevation of deck or stairs, including structural support N/A -  feet  meters

# ELEVATION CERTIFICATE

OMB Control Number: 1660-0008  
Expiration: 11/30/2018

FL

4550, 4554, 4558, 4562 and 4666 Basket Oak Lane  
Sarasota

34232

## SECTION D - SURVEYOR, ENGINEER, OR ARCHITECT CERTIFICATION

This certification is to be signed and sealed by a land surveyor, engineer, or architect authorized by law to certify elevation information. *I certify that the information on this Certificate represents my best efforts to interpret the data available. I understand that any false statement may be punishable by fine or imprisonment under 18 U.S. Code, Section 1001.*

Check here if attachments. Were latitude and longitude in Section A provided by a licensed land surveyor?

Yes  No

Certifier's Name Jack M. Greene		License Number 6506	
Company Name GeoPoint Surveying, Inc.			
Title Vice President	City Tampa	State FL	Zip Code 33605
Address 1403 E. 5th Avenue	Date May 19, 2016	Telephone +1 (813) 248-8888	

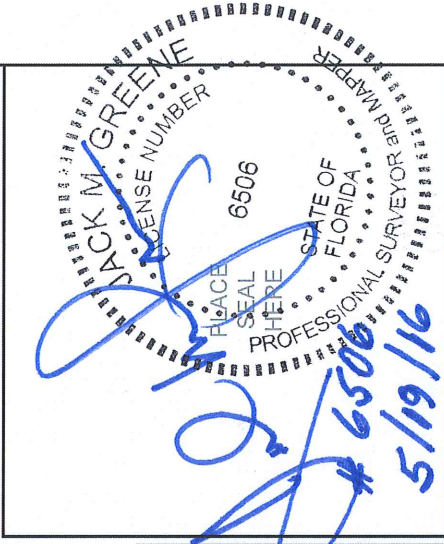

Copy both sides of this Elevation Certificate for (1) community official, (2) insurance agent/company, and (3) building owner.

Comments (including type of equipment and location, per C2(e), if applicable)"

Photographs were taken on May 19, 2016. The Site is located within Basin 31116 of the Phillippi Creek Watershed ICPR model (PCM), with a model date of January 28, 2013. The 100-year Base Flood Elevation (BFE) of Node 31116 is 18.33 ft NGVD29.

[Handwritten Signature]

Signature

Date May 19, 2016

## SECTION E - BUILDING ELEVATION INFORMATION (SURVEY NOT REQUIRED) FOR ZONE AO AND ZONE A (WITHOUT BFE)

For Zones AO and A (without BFE), complete items E1 -E5. If the Certificate is intended to support a LOMA or LOMR-F request, complete Sections A, B, and C. For items E1 -E4, use natural grade, if available. Check the measurement used. In Puerto Rico only, enter meters.

E1. Provide elevation information for the following and check the appropriate boxes to show whether the elevation is above or below the highest adjacent grade (HAG) and the lowest adjacent grade (LAG):

- a) Top of bottom floor (including basement, crawlspace, or enclosure) is \_\_\_\_\_ - \_\_\_\_\_  feet  meters  above or  below the HAG.
- b) Top of bottom floor (including basement, crawlspace, or enclosure) is \_\_\_\_\_ - \_\_\_\_\_  feet  meters  above or  below the LAG.
- E2. For Building Diagrams 6 -9 with permanent flood openings provided in Section A items 8 and/or 9 (see pages 8 -9 of Instructions), the next higher floor (elevation C2.b in the diagrams) of the building is \_\_\_\_\_ - \_\_\_\_\_  feet  meters  above or  below the HAG.
- E3. Attached garage (top of slab) is \_\_\_\_\_ - \_\_\_\_\_  feet  meters  above or  below the HAG.
- E4. Top of platform of machinery and /or equipment servicing the building is \_\_\_\_\_ - \_\_\_\_\_  feet  meters  above or  below the HAG.
- E5. Zone AO only: If no flood depth number is available, is the top of the bottom floor elevated in accordance with the community's floodplain management ordinance?  Yes  No  Unknown. The local official must certify this information in Section G.

## SECTION F - PROPERTY OWNER (OR OWNER'S REPRESENTATIVE) CERTIFICATION

The property owner or owner's authorized representative who completes Sections A, B, and E for Zone A (without a FEMA-issued or community-issued BFE) or Zone AO must sign here. The statements in Sections A, B, and E are correct to the best of my knowledge.

Property Owner or Owner's Authorized Representative's Name:

Address	City	State	ZIP Code
Signature	Date	Telephone	

Comments

Check here if attachments.

**SECTION G - COMMUNITY INFORMATION (OPTIONAL)**

The local official who is authorized by law or ordinance to administer the community's floodplain management ordinance can complete Sections A, B, C (or E), and G of this Elevation Certificate. Complete the applicable item(s) and sign below. Check the measurement used in Items G8 - G10. In Puerto Rico only, enter meters.

- G1.  The information in Section C was taken from other documentation that has been signed and sealed by a licensed surveyor, engineer, or architect who is authorized by law to certify elevation information. (Indicate the source and date of the elevation data in the Comments area below.)
- G2.  A community official completed Section E for a building located in Zone A (without a FEMA-issued or community-issued BFE) or Zone AO.

G3.  The following information (Items G4 -G10) is provided for community floodplain management purposes.

G4. Permit Number	G5. Date Permit Issued	G6. Date Certificate of Compliance/Occupancy Issued
-------------------	------------------------	---

G7. This permit has been issued for:  New Construction  Substantial Improvement

G8. Elevation of as-built lowest floor (including basement) of the building: \_\_\_\_\_ - \_\_\_\_\_  feet  meters Datum \_\_\_\_\_

G9. BFE or (in Zone AO) depth of flooding at the building site: \_\_\_\_\_ - \_\_\_\_\_  feet  meters Datum \_\_\_\_\_

G10. Community's design flood elevation: \_\_\_\_\_ - \_\_\_\_\_  feet  meters Datum \_\_\_\_\_

Local Official's Name \_\_\_\_\_ Title \_\_\_\_\_

Community Name \_\_\_\_\_ Telephone \_\_\_\_\_

Signature \_\_\_\_\_ Date \_\_\_\_\_

Comments \_\_\_\_\_

Check here if attachments.

## BUILDING PHOTOGRAPHS

See instructions for Item A6

OMB Control Number: 1660-0008  
Expiration: 11/30/2018

<b>IMPORTANT: In these spaces, copy the corresponding information from Section A.</b>		FOR INSURANCE COMPANY USE
Building Street Address (including Apt., Unit, Suite, and/or Bldg. No.) or P.O. Route and Box No. 4550, 4554, 4558, 4562 and 4666 Basket Oak Lane		Policy Number:
City Sarasota	State FL	Company NAIC Number:
	Zip Code 34232	

If using the Elevation Certificate to obtain NFIP flood insurance, affix at least 2 building photographs below according to the instructions for Item A6. Identify all photographs with date taken; "Front view" and Rear view"; and, if required, "Right Side View" and "Left Side View." When applicable, photographs must show the foundation with representative examples of the flood openings or vents, as indicated in Section A8. If submitting more photographs than will fit on this page, use the Continuation Page.



FRONT VIEW

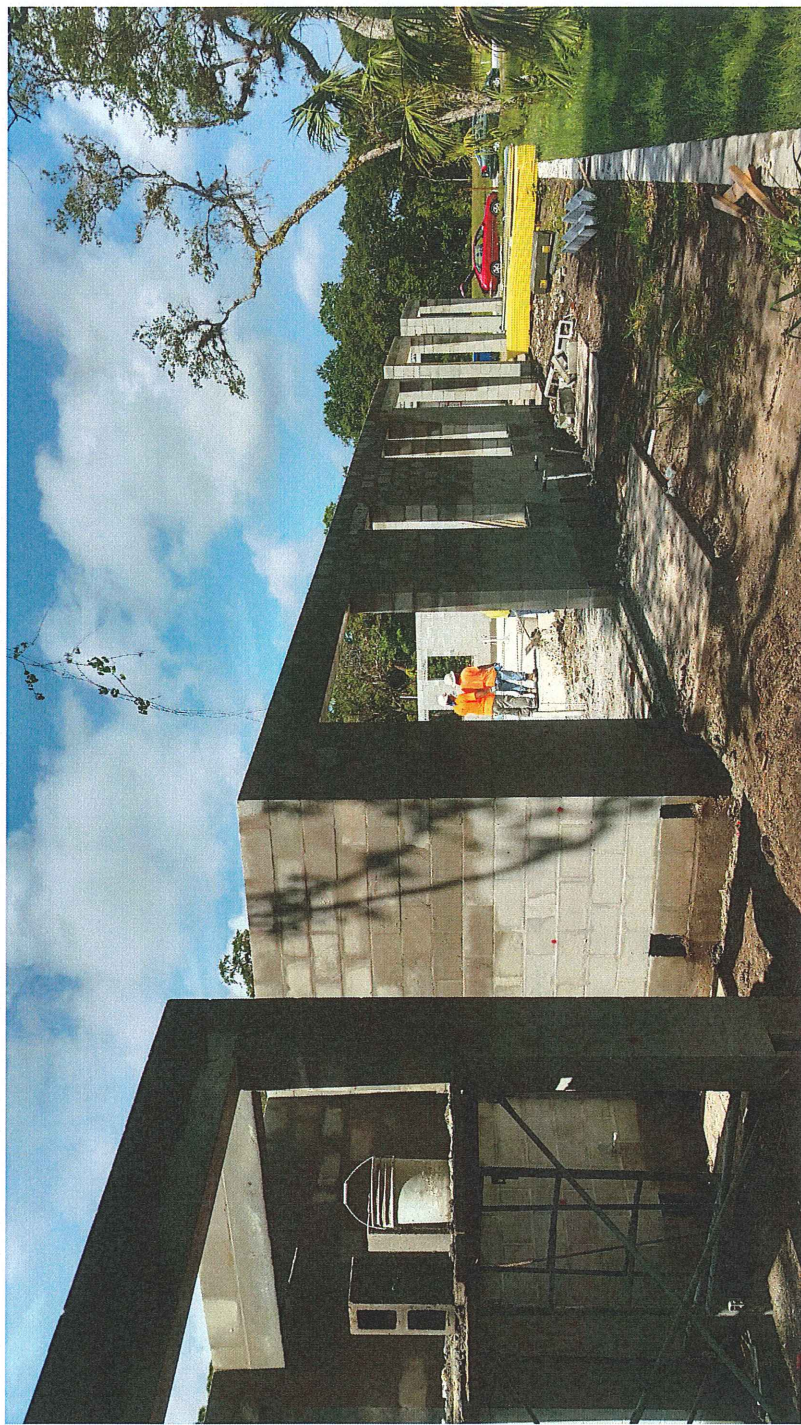

REAR VIEW