

SARASOTA COUNTY
 Geomatics Service Center
 SURVEY/MAPPING SECTION

WGS 84	Lat: N27° 15' 39.4"	REVISIONS / REMARKS	ELEV. 6.78'
	Lon: W82° 32' 38.7"		
FL W. 83	N. 1064416'	DATE DRAWN: 5/03	BY: ND
	E. 479412'	REF.: DL-2	PG. 35
		DATE: 6/3/06	B.M. NO. 106
		SET BY: FDNR	ELEV. BASED ON B.M. NO. SAR 6

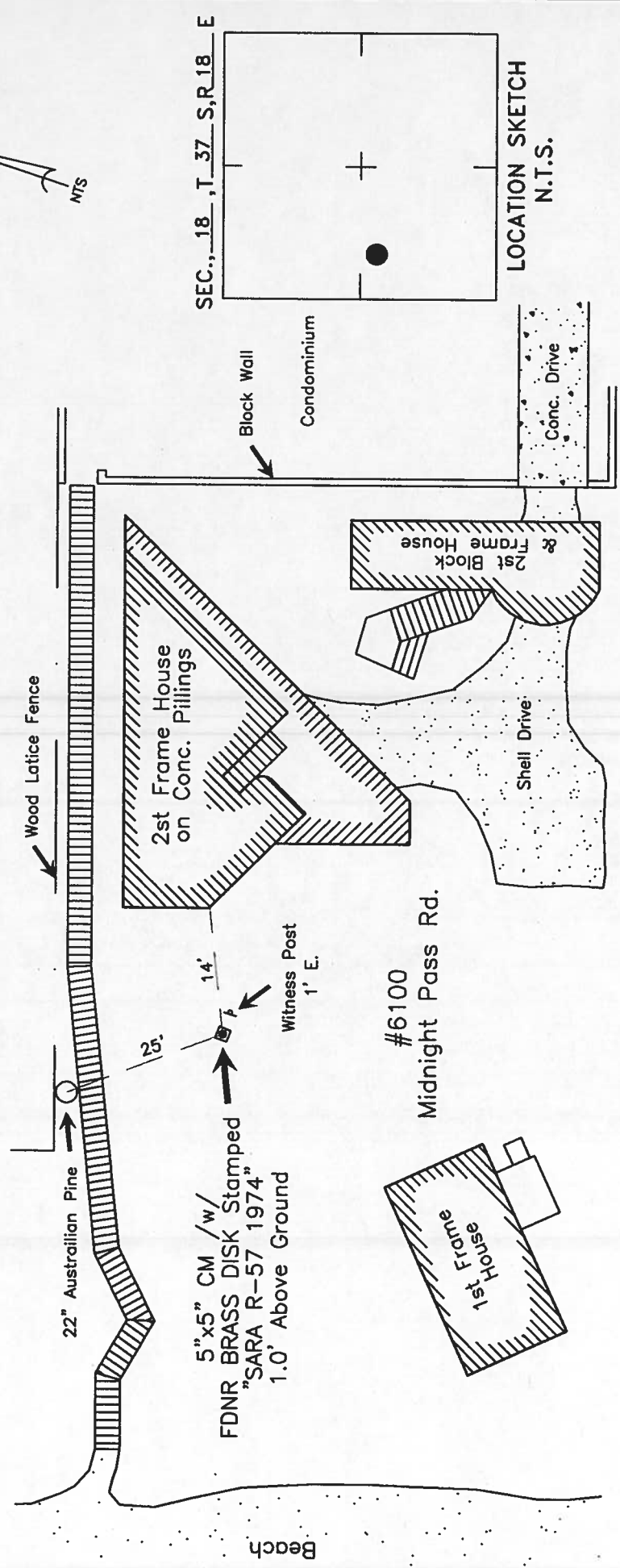

SEC., 18, T. 37, S. R. 18 E

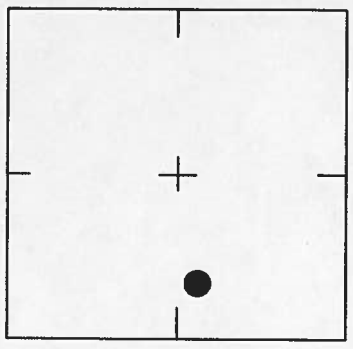

LOCATION SKETCH
N.T.S.

SARASOTA COUNTY
Geomatics Service Center
SURVEY/MAPPING SECTION

BENCH MARK DATA SHEET	ELEV.	6.65'
	NGVD 29'	B.M. NO.
DATE DRAWN: 5/03	BY: ND	106-A
REF.: DL-2	PG. 35	DATE: 6/3/06
ELEV. BASED ON B.M. NO. SAR 6		

WGS	REVISIONS / REMARKS
84	Lat: N27° 15' 31.6"
	Lon: W82° 32' 31.0"
FL W.	N. 1063620'
83	E. 480103'

SET BY: FDNR

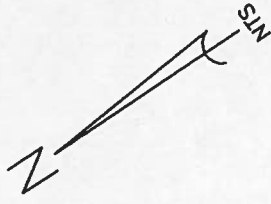

Siesta Dunes Condominium
#6218
Midnight Pass Rd.

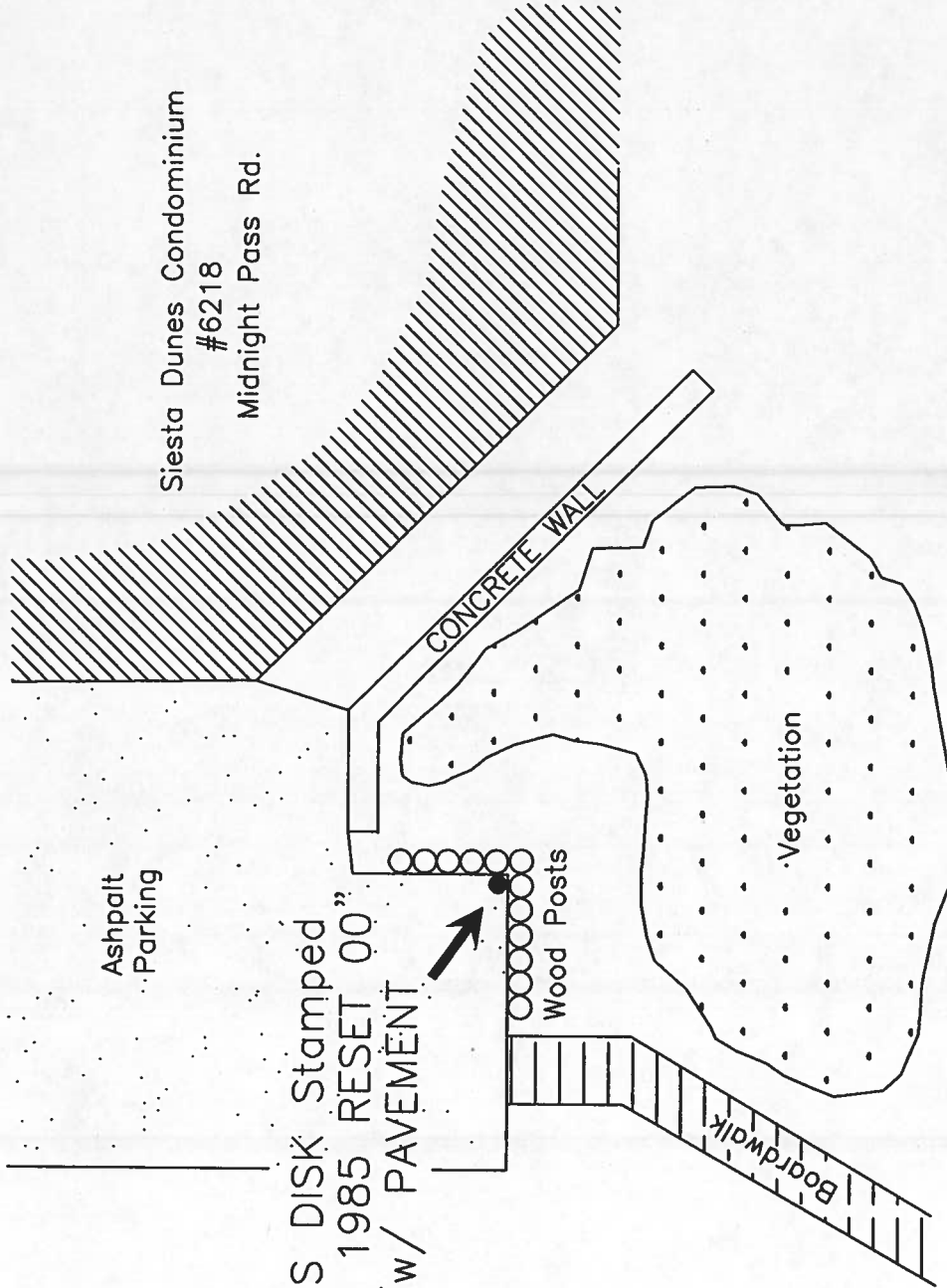

FDNR BRASS DISK Stamped
"SARA R-58 1985 RESET 00"
FLUSH /w/ PAVEMENT

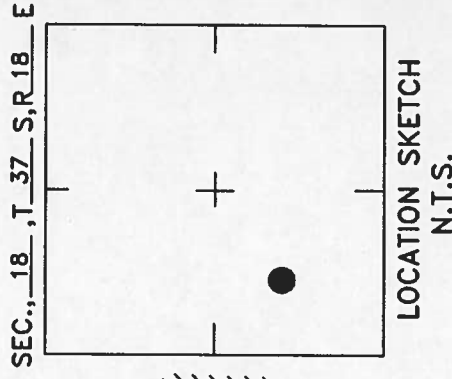

SARASOTA COUNTY
Geomatics Service Center
SURVEY/MAPPING SECTION

WGS 84	Lat: N27° 15' 23.8"	REVISIONS / REMARKS	ELEV. 5.11'
	Lon: W82° 32' 25.2"		
FL W. 83	N. 1062829' E. 480619'	DATE DRAWN: 5/03 REF.: DL-2 ELEV. BASED ON B.M. NO. SAR 6	BY: ND DATE: 6/3/06
SET BY: FDNR			

4" x 4" CM /w/ FDNR Brass Disk
 Stamped "17 84 A32"
 0.5' Below Ground
 NOTE: DISTURBED, Leaning South
 Under Irrigation Pipe

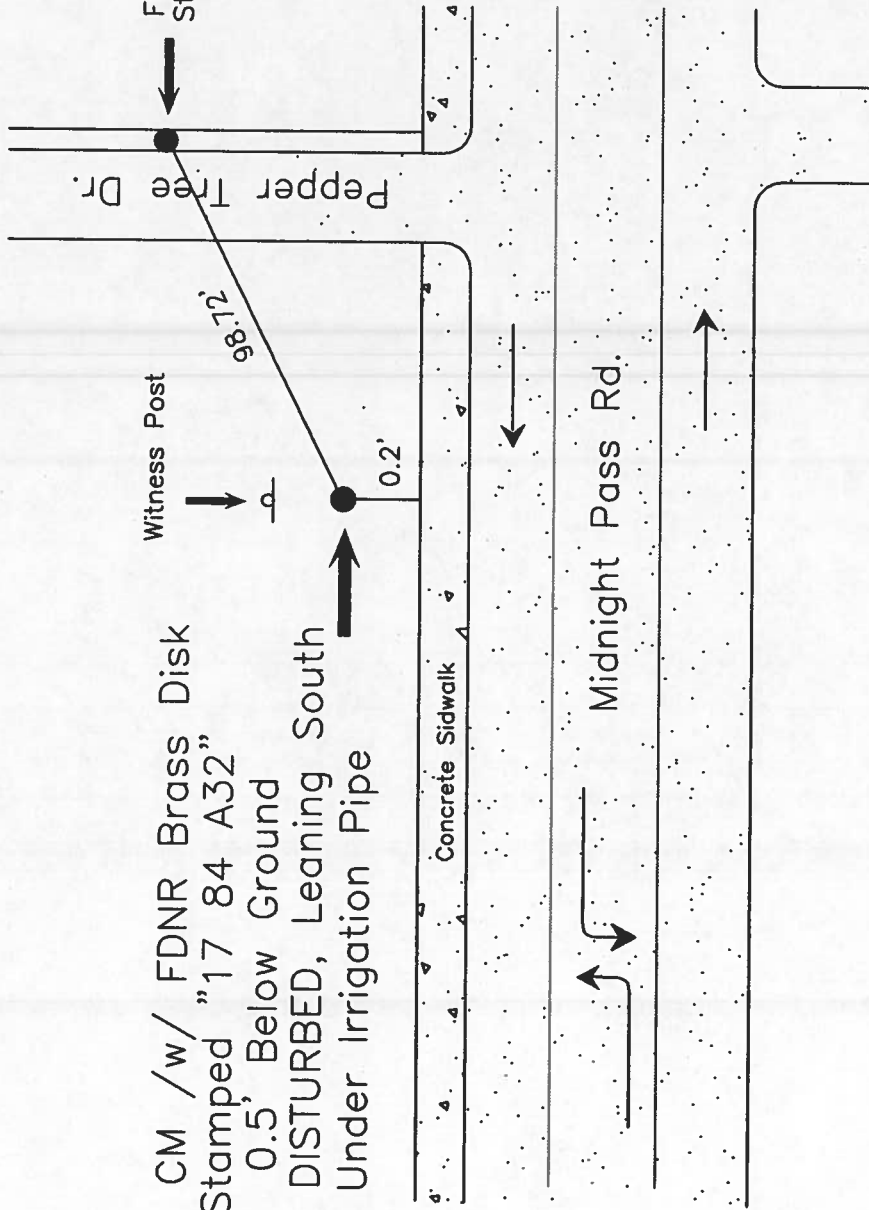

SEC., 18, T. 37, S, R. 18, E

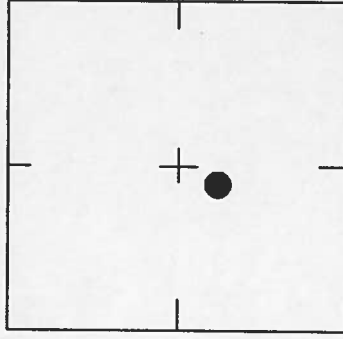

LOCATION SKETCH
N.T.S.

SARASOTA COUNTY
 Geomatics Service Center
 SURVEY/MAPPING SECTION

WGS 84	Lat: N27° 15' 38.7"	REVISIONS / REMARKS	BENCH MARK DATA SHEET	ELEV.
	Lon: W82° 32' 22.9"			6.65'
FL W.	N. 1064333'		DATE DRAWN: 5/03	BY: ND
83	E. 480839'		REF.: DL-2	PG. 35
			DATE: 6/3/06	106-C
		SET BY: FDNR	ELEV. BASED ON B.M. NO. SAR 6	

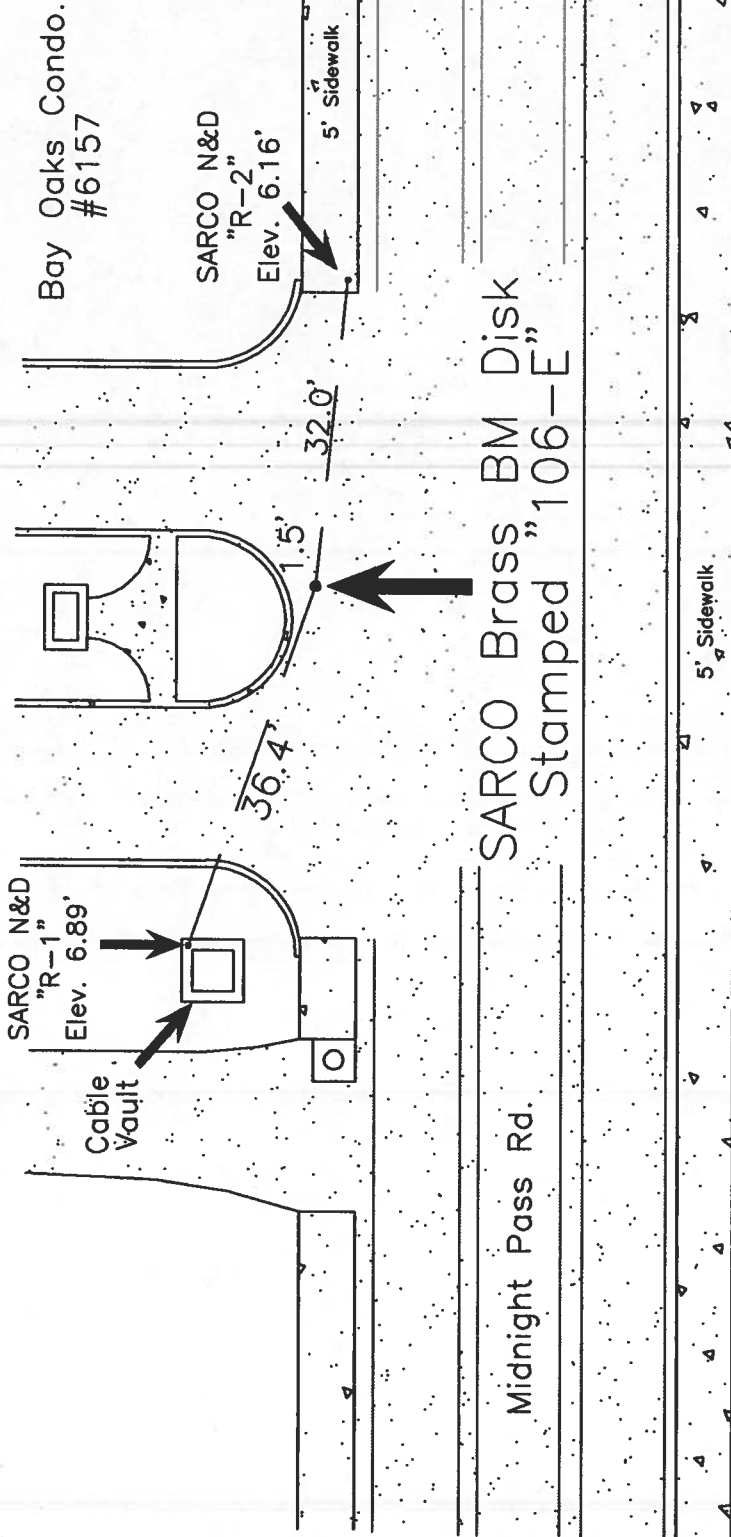
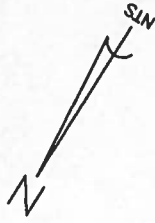

SEC., 18, T 37 S, R 18 E

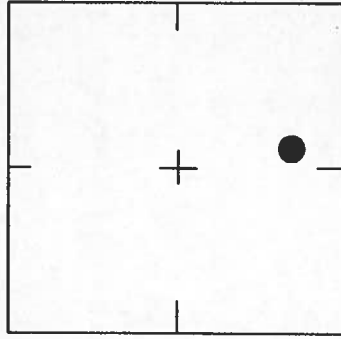

LOCATION SKETCH
N.T.S.

SARASOTA COUNTY
Geomatics Service Center
SURVEY/MAPPING SECTION

WGS 84	Lat: N27° 15' 31.4"	REVISIONS / REMARKS	BENCH MARK DATA SHEET	ELEV.	6.22'
	Lon: W82° 32' 18.3"			NGVD 29'	B.M. NO.
FL W. 83	N. 1063593'		DATE DRAWN: 5/03	BY: ND	
	E. 481252'		REF.: DL-2	PG. 35	DATE: 6/3/06
		SET BY: SARCO	ELEV. BASED ON B.M. NO. SAR 6		

Aloha Kai Condominium 6020
#6020 Midnight Pass Rd.

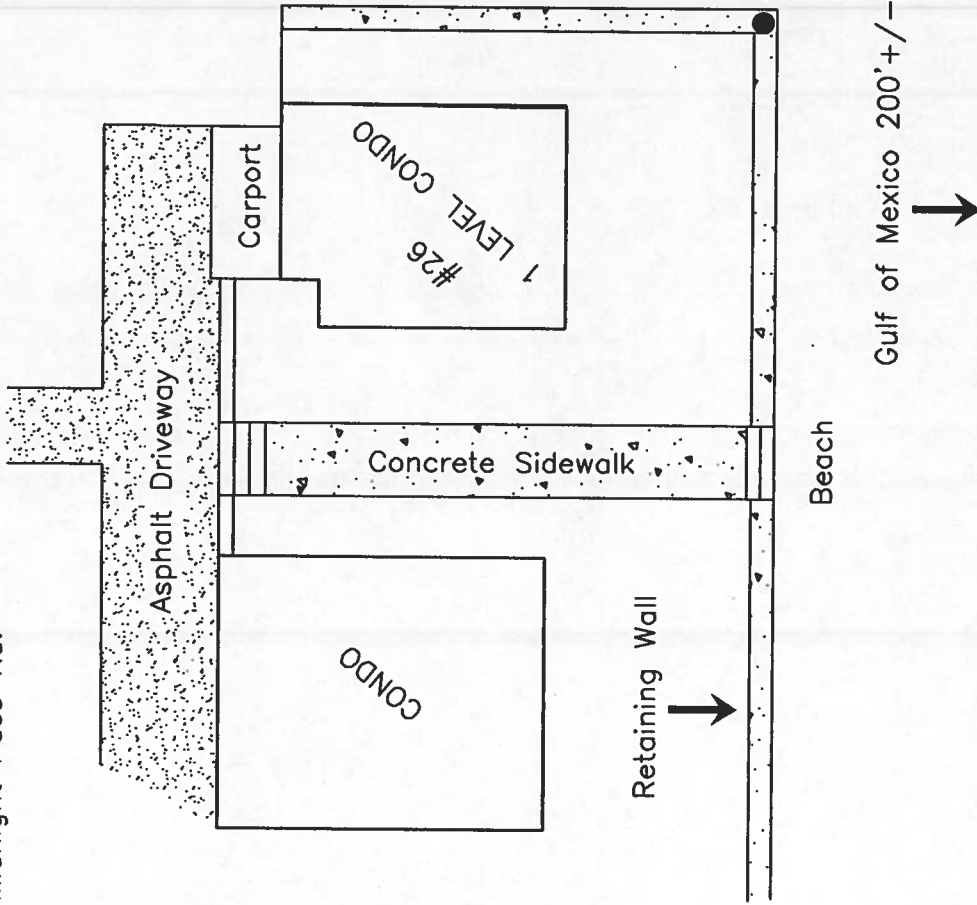

SEC., 18, T. 37 S, R. 18 E

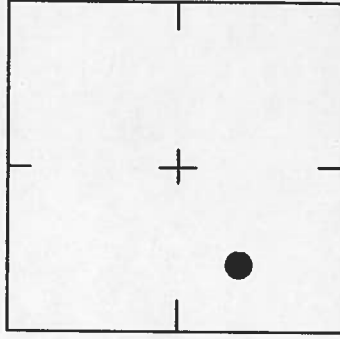

LOCATION SKETCH
N.T.S.

USCOE Brass Disk
Stamped
"SABE 30 1967"

SARASOTA COUNTY
Geomatics Service Center
SURVEY/MAPPING SECTION

WGS 84	Lat: N27° 15' 34.5"	REVISIONS / REMARKS	ELEV. 8.55'
	Lon: W82° 32' 34.6"		
FL W. 83	N. 1063913' E. 479783'	DATE DRAWN: 5/03 BY: ND REF.: DL-2 PG. 35 DATE: 6/3/06 ELEV. BASED ON B.M. NO. SAR 6	
SET BY: USCOE			