

MIDNIGHT PASS ROAD

*****¹⁸***** BENCH MARK DESCRIPTION *****
 DESIGNATION--IWSA ¹⁸ NO 2 STATE--FL COUNTY--SARASOTA
 QIAD--270823 SCALED LAT.--271409 SCALED LONG.--823115
 LOCATED 7.1 MILE SSE FROM THE TOWN OF--SARASOTA
 MONUMENT BY-- USE YR--1959 CP-- MARK TYPE--BM DISK
 RECOVERY AGENCY--FLDNR YR--1980 CP--JWH CONDITION--
 SPECIFIC SETTING--CONCRETE SEAWALL
 STAMPING--IWSA 18 NO 2 JACKSONVILLE OTHER CONTROL--
 ***** RECOVERY DESCRIPTION *****
 BEGIN AT THE INTERSECTION OF US HIGHWAY 41 AND STATE HIGHWAY 72

~~3.33~~
3.33'

(STICKNEY POINT ROAD), GO 1.0 MILE WESTERLY ON STICKNEY POINT ROAD TO ITS JUNCTION WITH STATE ROAD 789 (MIDNITE PASS ROAD), GO 1.55 MILES SOUTHERLY ON MIDNITE PASS ROAD TO THE JUNCTION OF MANDALAY POINT LANE, GO 0.1 MILE WEST ALONG MANDALAY POINT LANE TO 1247 MANDALAY POINT LANE (YATES RESIDENCE) AND THE MARK. THE MARK BEARS 33.0 FEET SOUTH SCUTHWEST OF THE NORTHEAST END OF THE SEAWALL, 44.75 FEET SOUTHEAST OF THE SOUTHEAST CORNER OF THE HOUSE, 31.75 FEET SOUTH OF THE EASTERN MOST OF THREE PALM TREES BEHIND HOUSE, AND 25.78 FEET SOUTH SOUTHEAST OF THE SOUTHEAST CORNER OF THE SHUFFLEBOARD COURT.
 ABOUT LEVEL WITH SEAWALL

1247

MANDALAY POINT LANE

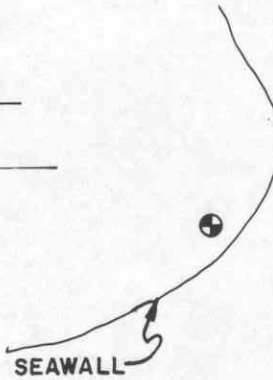

SEC. 29 T. 37 S. R. 18 E

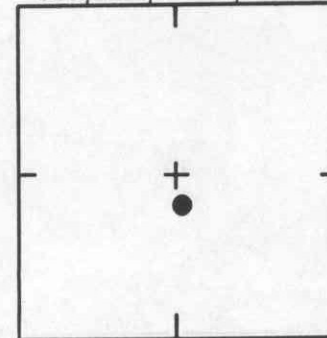

LOCATION SKETCH
N.T.S.

SARASOTA COUNTY
TRANSPORTATION DEPARTMENT
ENGINEERING DIVISION

BENCH MARK
DATA SHEET

ELEV.

3.33

DATE DRAWN: JUNE 1987

BY: RJJ

BM. NO.

DATE

TYPE

FB. PG.

BY

REF: IWSA 18 USF

DATE 1959

127B

REVISIONS

ELEV. BASED ON B.M. NO.

N. RIM OF MANHOLE
ELEV. 2.83'

N. RIM OF MANHOLE ELEV. 3.05'

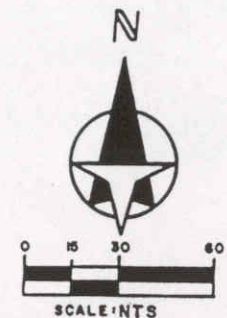

SEC. 29, T. 37 S, R. 18 E

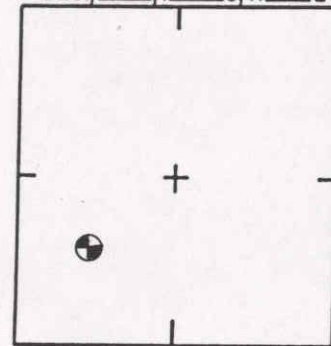

LOCATION SKETCH
N.T.S.

BM 127-C
SARCO ALUM. DISK
E. COR. OF CATCH BASIN
STAMPED 127-B
PSM 4149

HOUSE # 7740

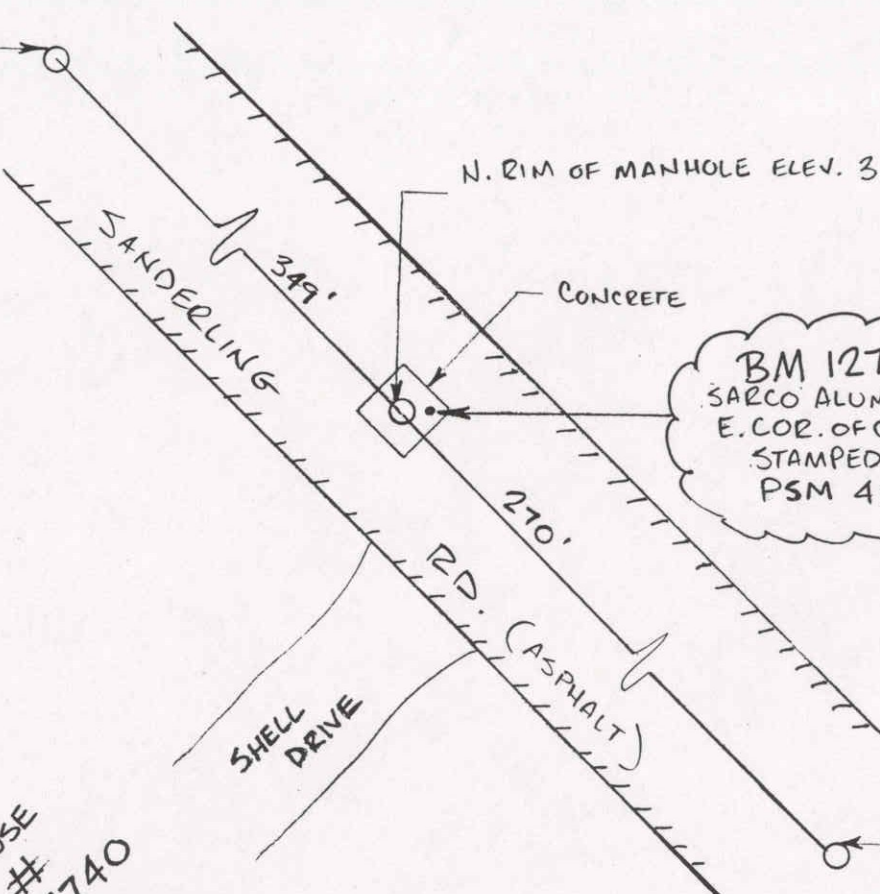

N. RIM OF MANHOLE
ELEV. 3.19'

SARASOTA COUNTY
DEVELOPMENT SERVICES
SURVEY-MAPPING

WGS 84	LAT. N. 27°14'15.7"
	LONG. W. 82°31'39.3"
FL.W. 83	N. 1055937 ±
	E. 484736 ±

DATE	TYPE	FB. PG.	BY
REVISIONS			

BENCH MARK DATA SHEET		ELEV.
DATE DRAWN: 3-12-02 BY: ND		3.06'
REF: DL FB 1 PG 42 DATE 3-11-02		NEVD 29'
ELEV. BASED ON B.M. NO. SARCO 108-D		BM. NO.
		127 C

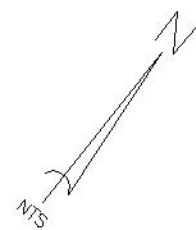
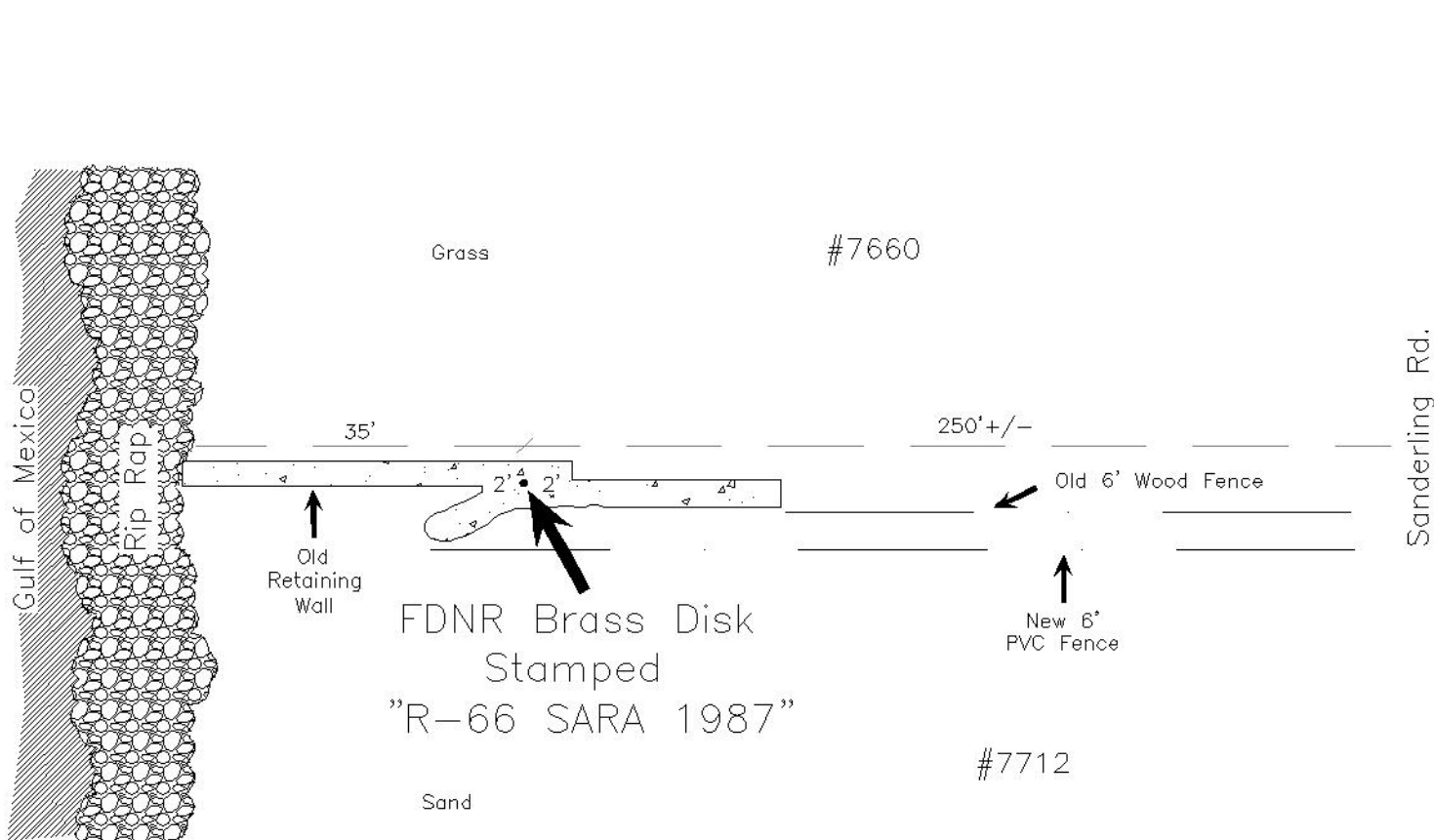

SEC., 29 , T 37 S, R 18 E

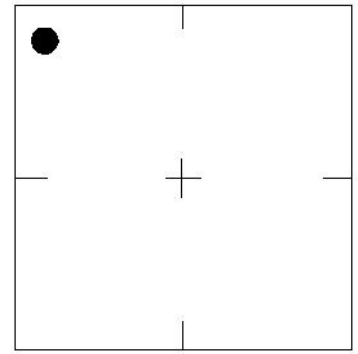

LOCATION SKETCH
N.T.S.

WGS	Lat: 27° 14' 17.0"
84	Lon: 82° 31' 44.1"
FL W.	N. 1056067'
83	E. 484307'

REVISIONS / REMARKS
SET BY: Sarasota County Survey / Mapping

SARASOTA COUNTY Geomatics Service Center SURVEY/MAPPING SECTION	
BENCH MARK DATA SHEET	ELEV. 9.84 NGVD 29' B.M. NO. 127-D
DATE DRAWN: 9/9/03 BY: ND	ELEV. BASED ON B.M. NO. 108-D
REF.: FB. DL-2 PG. 35 DATE: 6/12/06	

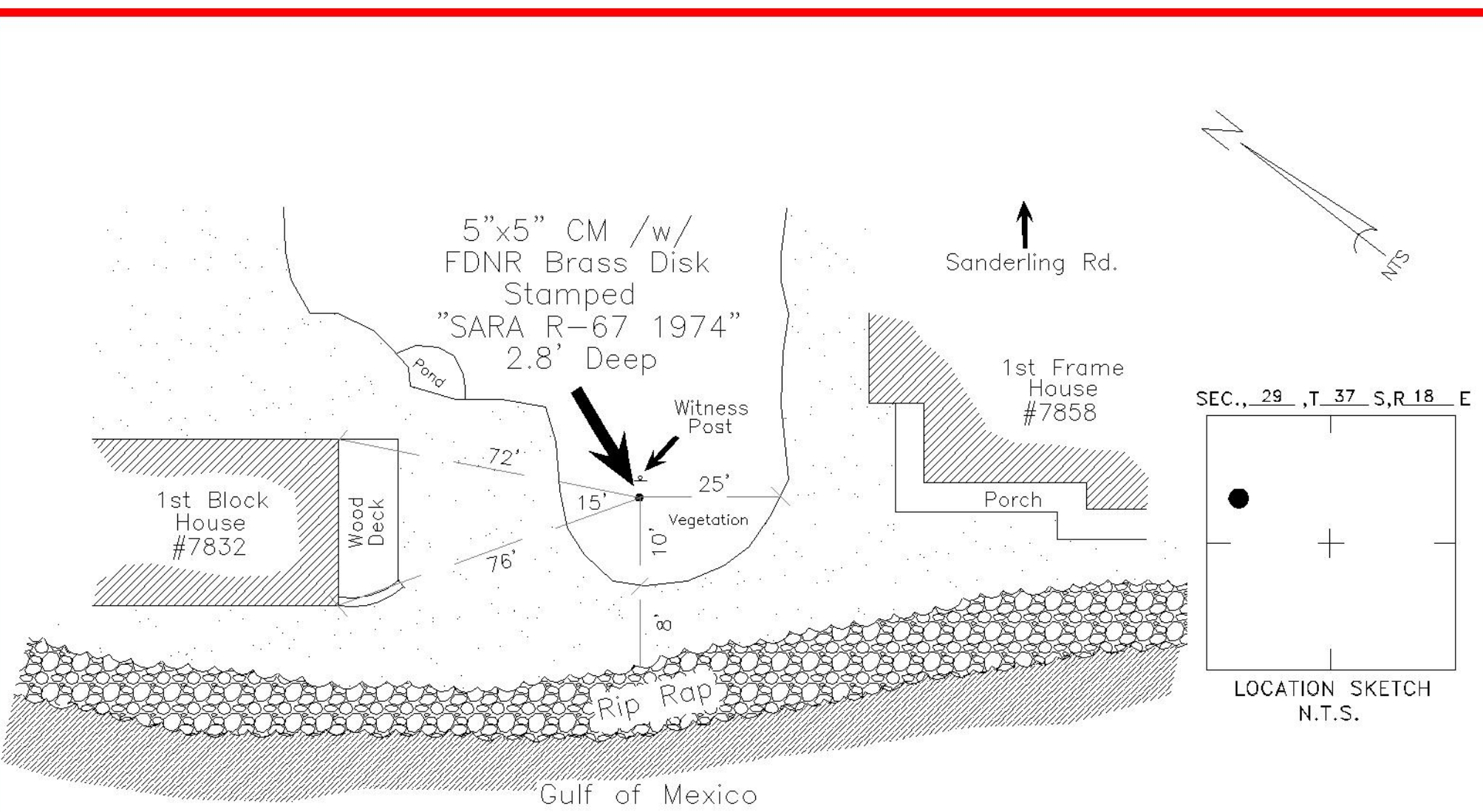

SEC., 29 , T 37 S, R 18 E

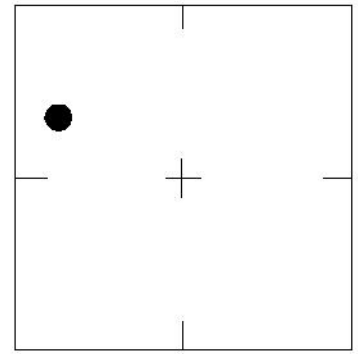

LOCATION SKETCH
N.T.S.

SARASOTA COUNTY
Geomatics Service Center
SURVEY/MAPPING SECTION

WGS 84	Lat: 27° 14' 10.0"	REVISIONS / REMARKS
	Lon: 82° 31' 35.5"	
FL W. 83	N. 1055361'	SET BY: Sarasota County Survey / Mapping
	E. 485081'	

BENCH MARK DATA SHEET	ELEV.
	8.02
DATE DRAWN: 9/9/03 BY: ND	NGVD 29'
REF.: FB. DL-2 PG. 35 DATE: 6/12/06	B.M. NO.
ELEV. BASED ON B.M. NO. 108-D	127-E

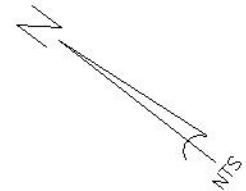
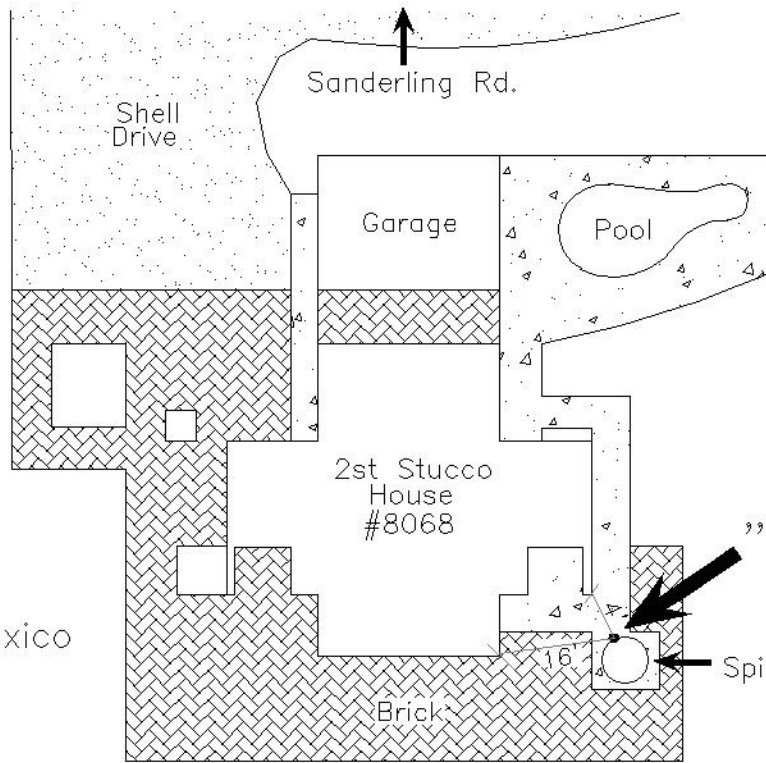

FDNR Brass Disk
Stamped
"SARA R-68 1974"

SEC., 29 , T 37 S, R 18 E

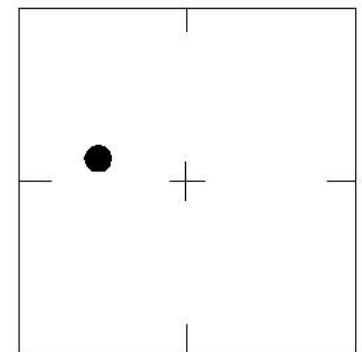

LOCATION SKETCH
N.T.S.

Gulf of Mexico
80'
↓

WGS 84	Lat: 27° 14' 01.8"
	Lon: 82° 31' 28.6"
FL W. 83	N. 1054529'
	E. 485696'

REVISIONS / REMARKS

SET BY: Sarasota County Survey / Mapping

SARASOTA COUNTY

Geomatics Service Center
SURVEY/MAPPING SECTION

**BENCH MARK
DATA SHEET**

DATE DRAWN: 9/9/03 BY: ND

REF.: FB. DL-2 PG. 35 DATE: 6/12/06

ELEV. BASED ON B.M. NO. 108-D

ELEV.

8.41

NGVD 29'

B.M. NO.

127-F