

COUNTY "TURTLE" BEACH

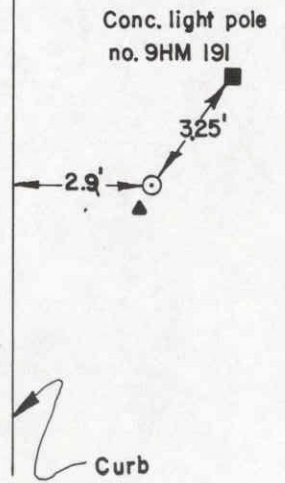
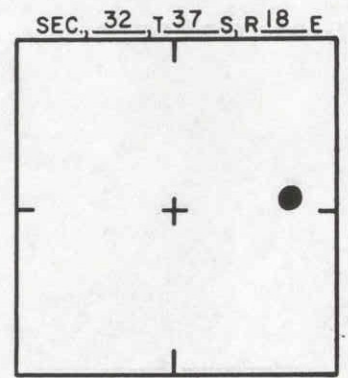
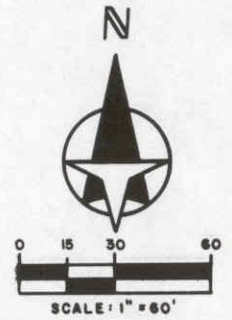
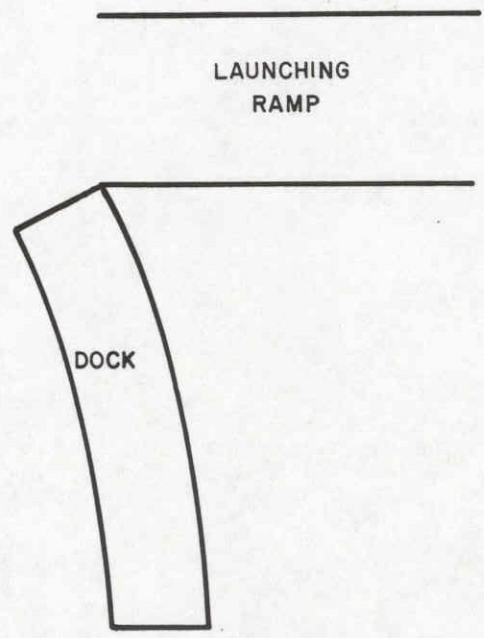

SARASOTA COUNTY
 TRANSPORTATION DEPARTMENT
 ENGINEERING DIVISION

Restamped "129" from 110 May 1983
 Adjusted Elev. from 4.75' to 4.66' Based Feb 1985
 on N.O.S. B.M.

**BENCH MARK
 DATA SHEET**

ELEV.
 4.66'
 BM. NO.

DATE DRAWN: JUNE 1983 BY: DBP

| DATE | TYPE | F.B. PG. | BY |
|-----------|------|----------|----|
| REVISIONS | | | |

REF: F.B. 235 PG. 77-80 DATE 2-4-85

129

ELEV. BASED ON N.O.S.B.M. 5985E

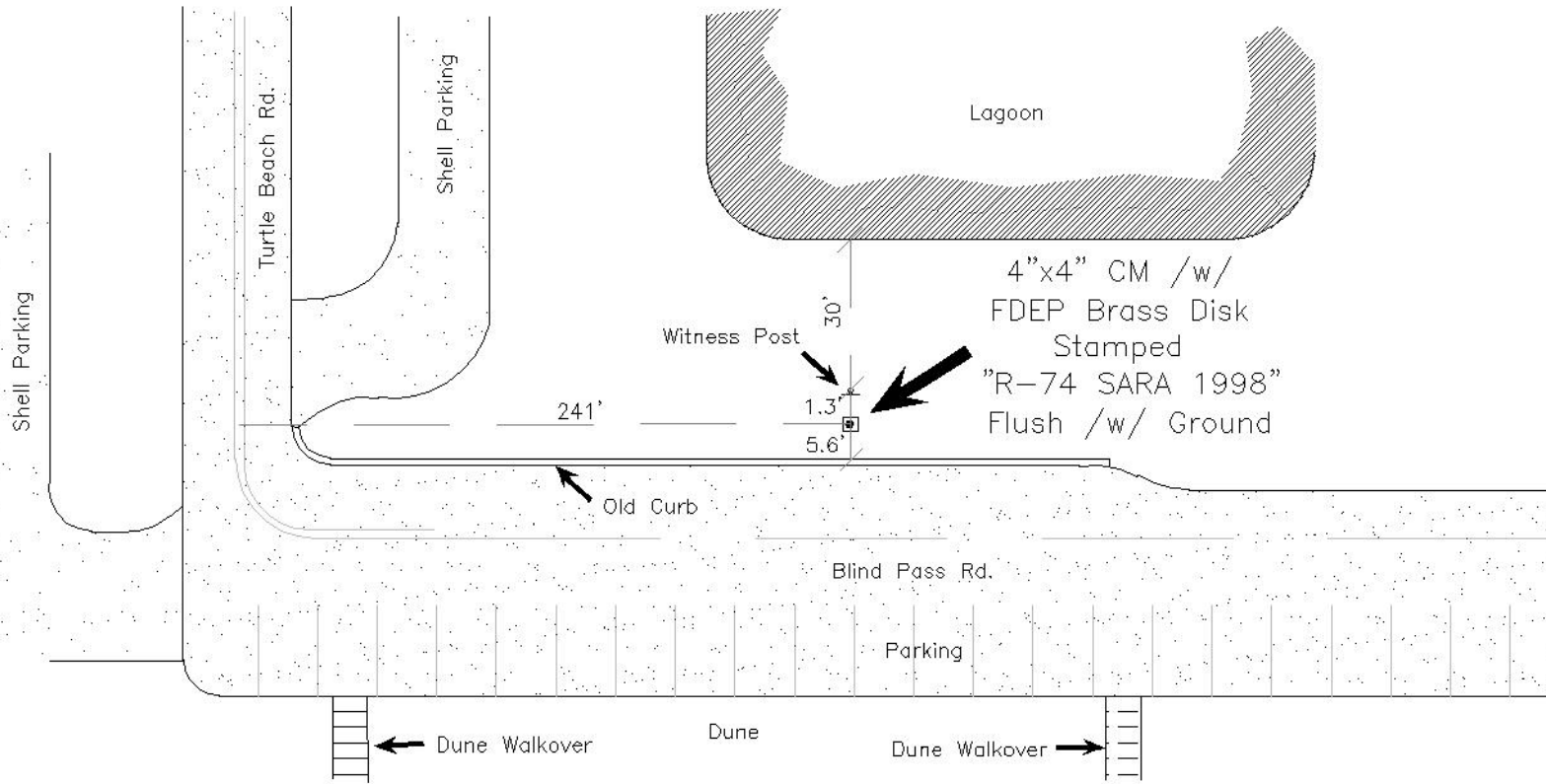
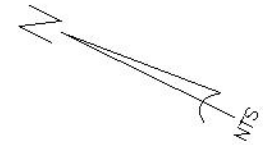

SEC., 32 ,T 37 S,R 18 E

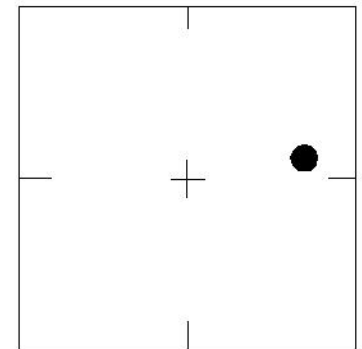

LOCATION SKETCH
N.T.S.

Geomatics Service Center
SURVEY/MAPPING SECTION

| | | | | |
|--|--------------------|---------------------|-------------------------------------|----------|
| WGS 84 | Lat: 27° 13' 07.9" | REVISIONS / REMARKS | BENCH MARK DATA SHEET | ELEV. |
| | Lon: 82° 31' 00.7" | | | 6.14 |
| FL W. 83 | N. 1049077' | | DATE DRAWN: 9/9/03 BY: ND | NGVD 29' |
| | E. 488192' | | REF.: FB. DL-2 PG. 35 DATE: 6/12/06 | B.M. NO. |
| SET BY: Sarasota County Survey / Mapping | | | ELEV. BASED ON B.M. NO. 108-D | 129-E |

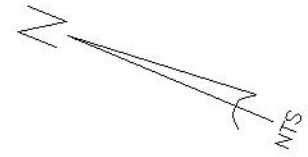
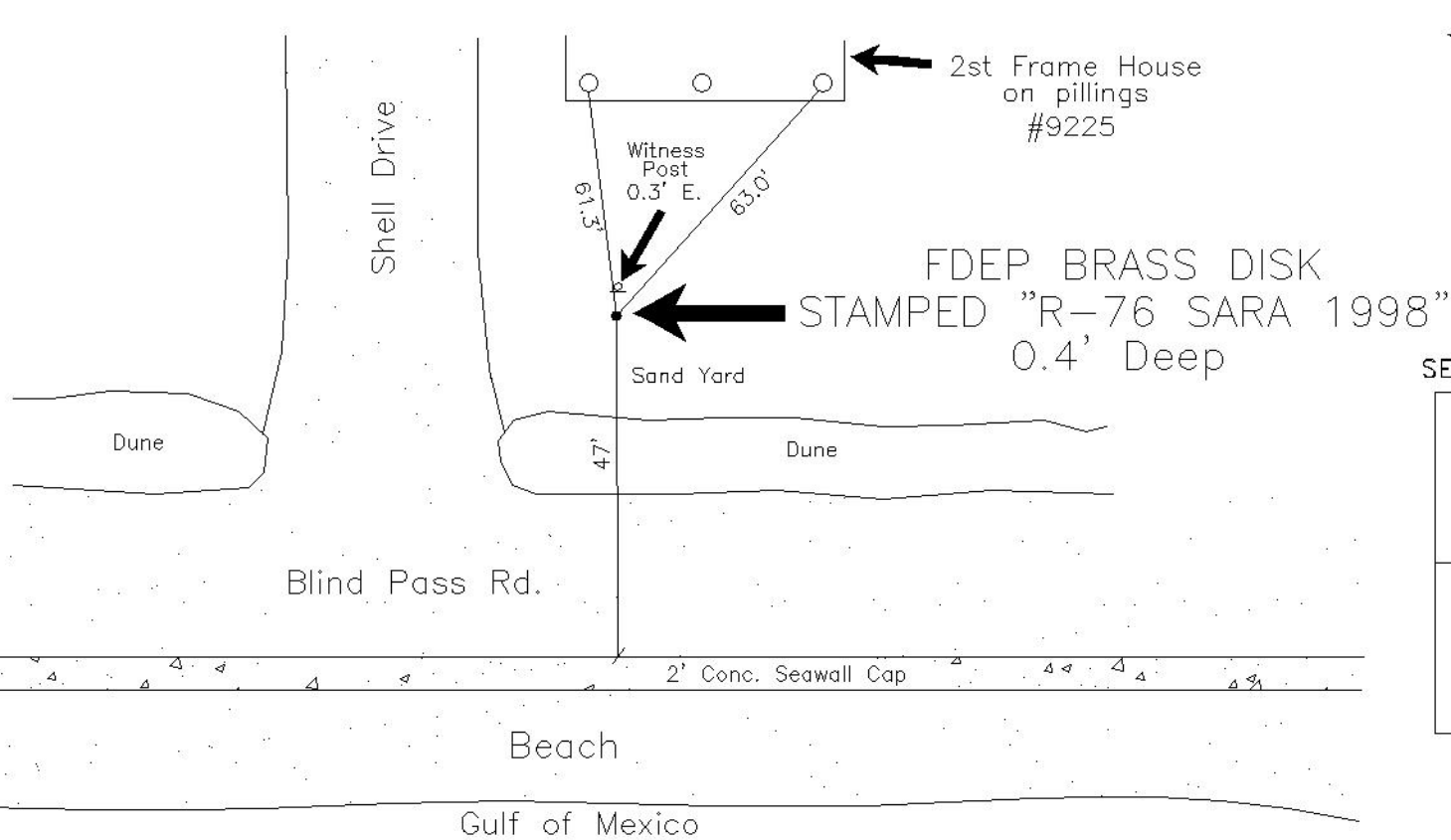

SEC., 32, T. 37 S, R. 18 E

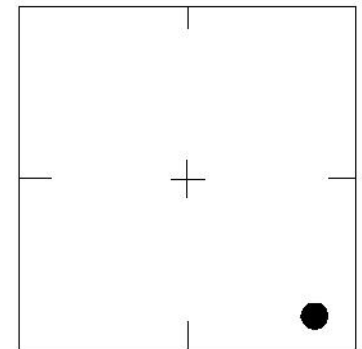

LOCATION SKETCH
N.T.S.

Geomatics Service Center
SURVEY/MAPPING SECTION

| | | | | |
|--|--------------------|---------------------|-------------------------------------|----------|
| WGS 84 | Lat: 27° 12' 49.0" | REVISIONS / REMARKS | BENCH MARK DATA SHEET | ELEV. |
| | Lon: 82° 30' 52.7" | | | 7.81 |
| FL W. 83 | N. 1047168' | | DATE DRAWN: 9/9/03 BY: ND | NGVD 29' |
| | E. 488904' | | REF.: FB. DL-2 PG. 35 DATE: 6/12/06 | B.M. NO. |
| SET BY: Sarasota County Survey / Mapping | | | ELEV. BASED ON B.M. NO. 108-D | 129-F |

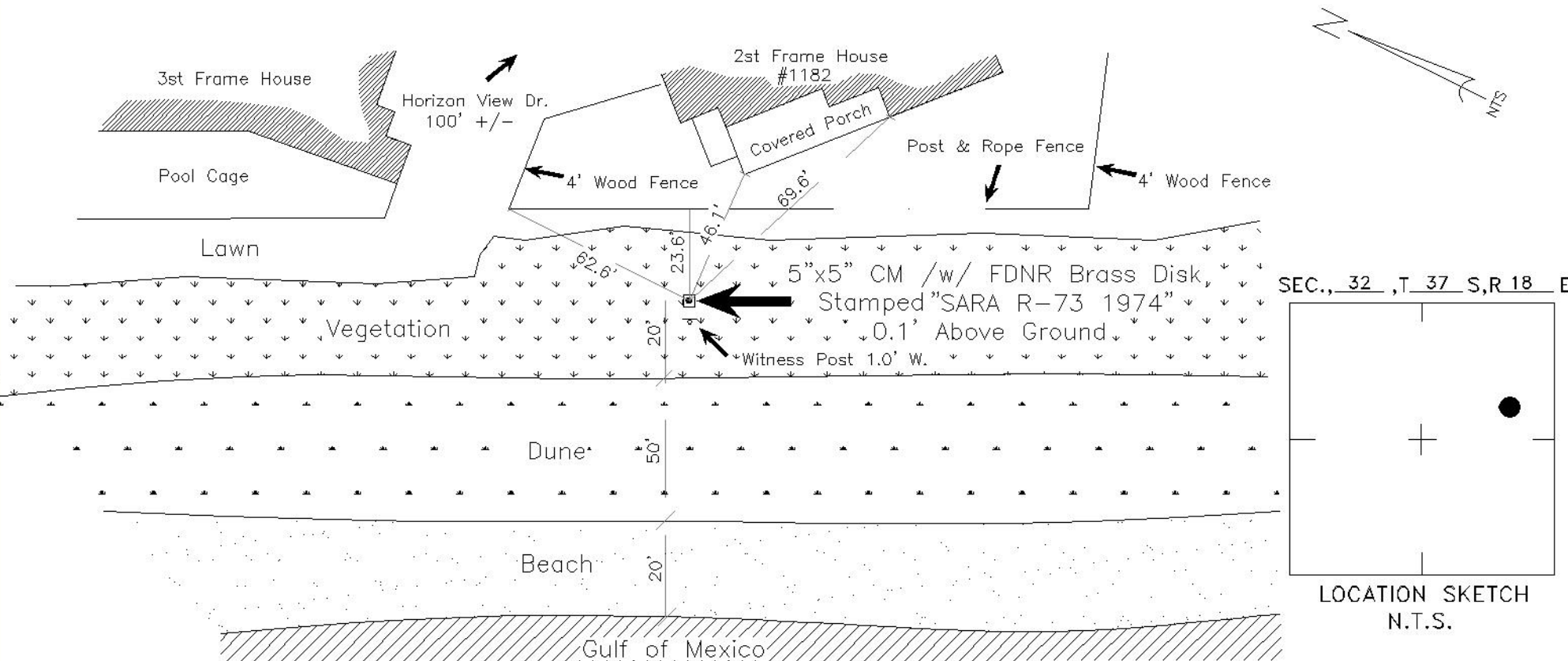

Geomatics Service Center
SURVEY/MAPPING SECTION

| | | | | |
|-------------|--------------------|--|-------------------------------------|----------|
| WGS 84 | Lat: 27° 13' 16.9" | REVISIONS / REMARKS | BENCH MARK DATA SHEET | ELEV. |
| | Lon: 82° 31' 05.5" | | | 7.46 |
| FL W. 83 | N. 1049984' | SET BY: Sarasota County Survey / Mapping | DATE DRAWN: 9/9/03 BY: ND | NGVD 29' |
| | E. 487764' | | REF.: FB, DL-2 PG. 35 DATE: 6/12/06 | B.M. NO. |
| | | | ELEV. BASED ON B.M. NO. 108-D | 129-0 |

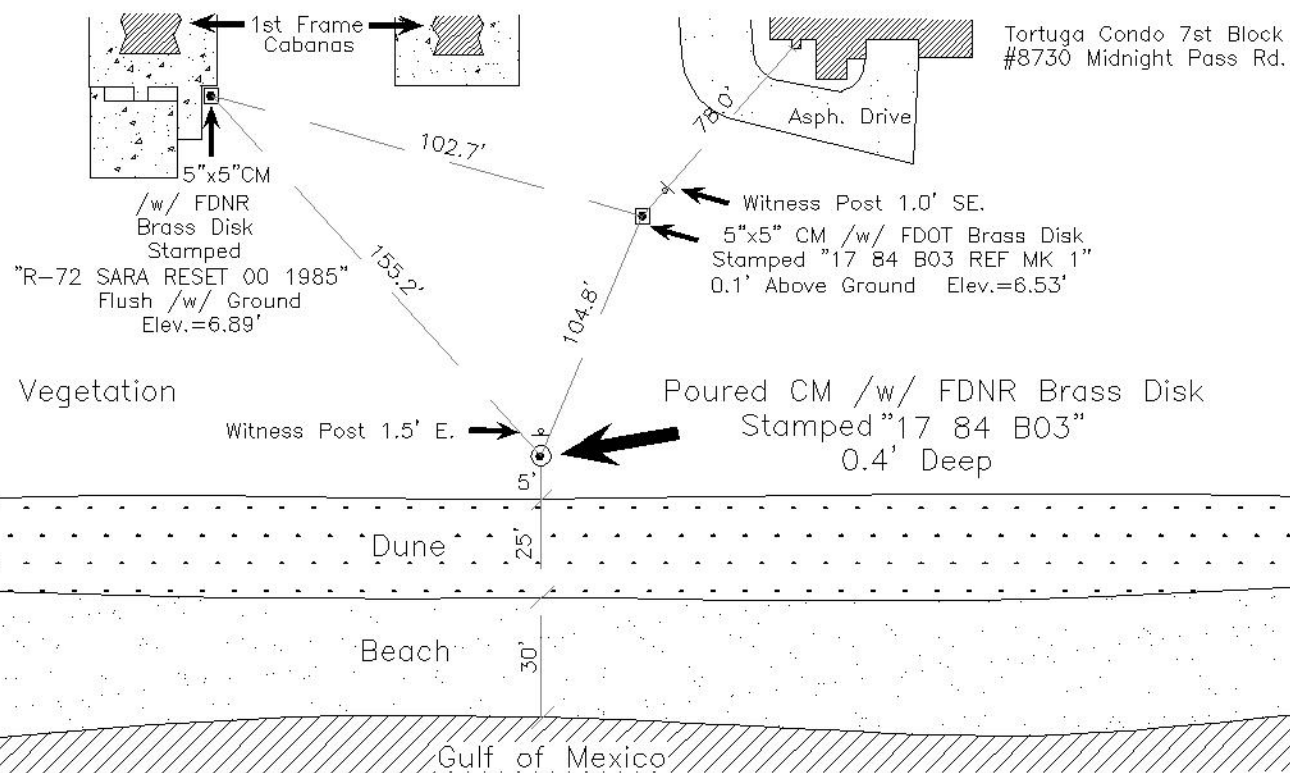

SEC., 32 ,T 37 S,R 18 E

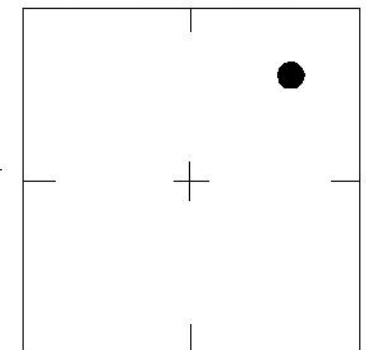

LOCATION SKETCH
N.T.S.

| | |
|-------|--------------------|
| WGS | Lat: 27° 13' 25.5" |
| 84 | Lon: 82° 31' 10.2" |
| FL W. | N. 1050858' |
| 83 | E. 487340' |

| REVISIONS / REMARKS |
|--|
| |
| SET BY: Sarasota County Survey / Mapping |

| SARASOTA COUNTY | |
|-------------------------------|---------------|
| Geomatics Service Center | |
| SURVEY/MAPPING SECTION | |
| BENCH MARK DATA SHEET | |
| DATE DRAWN: 9/9/03 | BY: ND |
| REF.: FB. DL-2 PG. 35 | DATE: 6/12/06 |
| ELEV. BASED ON B.M. NO. 108-D | |

| | |
|----------|-------|
| ELEV. | 9.06 |
| NGVD 29' | |
| B.M. NO. | 129-H |

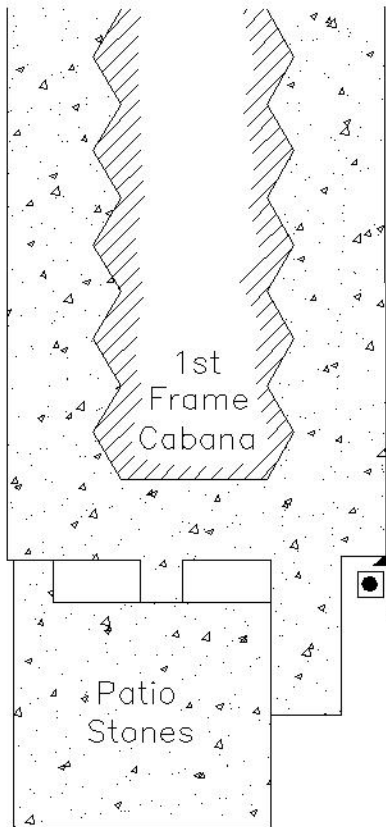
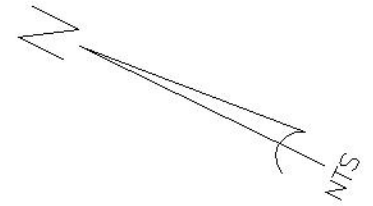

Bay Tree Club Condominium
8635 Midnight Pass Rd.

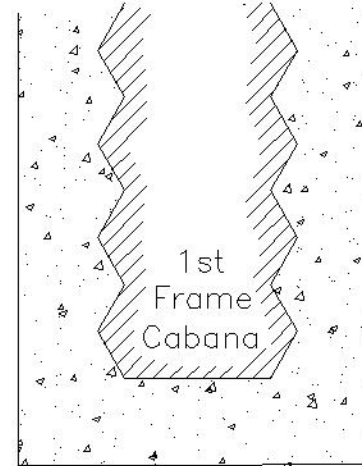

SEC., 32 , T 37 S, R 18 E

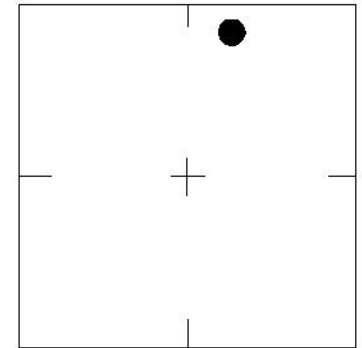

LOCATION SKETCH
N.T.S.

0.2'
5" x 5" CM / w / FDNR
Brass Disk Stamped
"R-72 SARA RESET 00 1985"
Flush / w / Ground

Beach 200' +/-



Geomatics Service Center
SURVEY/MAPPING SECTION

| | | | | |
|-------------|--------------------|--|-------------------------------------|----------|
| WGS 84 | Lat: 27° 13' 26.3" | REVISIONS / REMARKS | BENCH MARK DATA SHEET | ELEV. |
| | Lon: 82° 31' 08.7" | | | 6.89 |
| FL W. 83 | N. 1050936' | SET BY: Sarasota County Survey / Mapping | DATE DRAWN: 9/9/03 BY: ND | NGVD 29' |
| | E. 487474' | | REF.: FB. DL-2 PG. 35 DATE: 6/12/06 | B.M. NO. |
| | | | ELEV. BASED ON B.M. NO. 108-D | 129-1 |

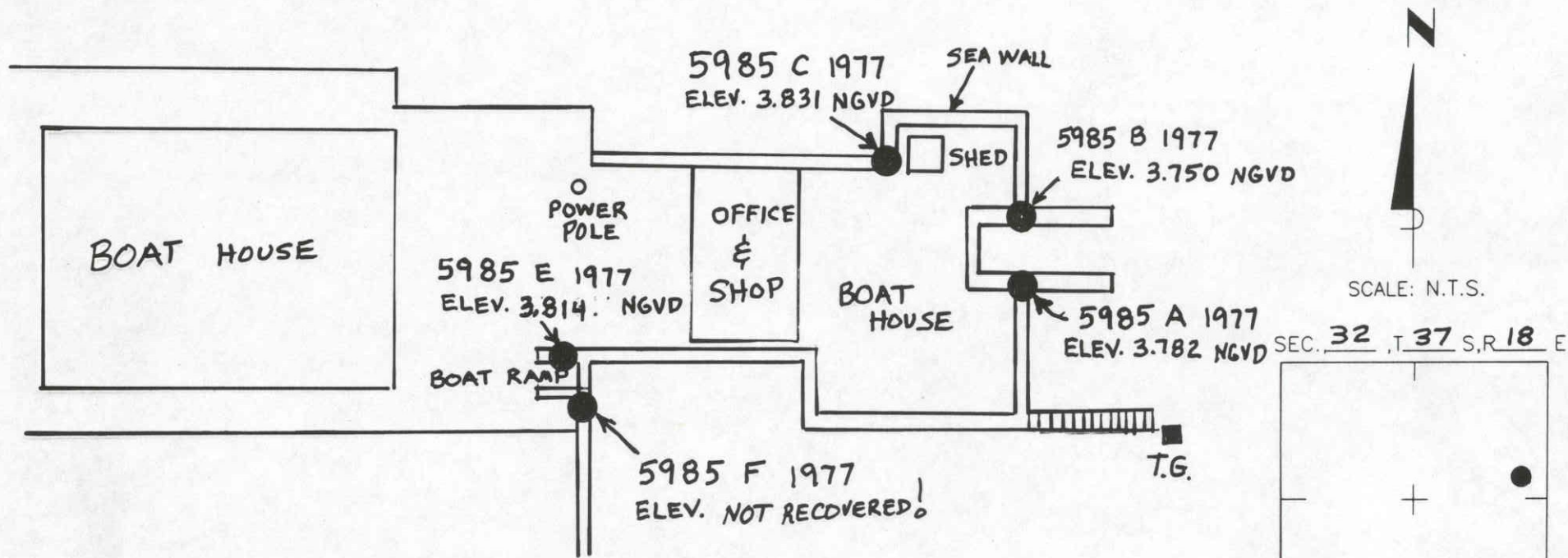

***** RECOVERY DESCRIPTION *****

BEGIN AT THE INTERSECTION OF U.S. HIGHWAY 41 AND STATE HIGHWAY 72 (STICKNEY POINT ROAD), GO 1.0 MILE WESTERLY ON STICKNEY POINT ROAD TO ITS JUNCTION WITH STATE ROAD 789 (MIDNITE PASS ROAD), GO 2.7 MILES SOUTHERLY ON MIDNITE PASS ROAD TO THE MIDNITE PASS MARINA AND THE MARK. THE MARK BEARS 14.0 FEET SOUTH OF THE CENTER OF A FORK-LIFT BOAT RAMP, 26.0 FEET NORTH OF THE SOUTH END OF THE SEAWALL, AND 55.3 FEET NORTHEAST OF THE SOUTHEAST CORNER OF A LARGE METAL BOAT HANGAR.

SARASOTA COUNTY

TRANSPORTATION DEPARTMENT
ENGINEERING DIVISION, SURVEY/MAPPING SECTION

REVISIONS / REMARKS

DATE: 21 JUL 00
SCOTT BRITT

BENCH MARK
DATA SHEET

DATE DRAWN: 5-29-03 BY: J.L.

REF.: PG. DATE:

SET BY:

ELEV. BASED ON B.M. NO.

ELEV.

B.M. NO.

129-T

LOCATION SKETCH
N.T.S.