

LOCATION SKETCH
N.T.S.

SARASOTA COUNTY
TRANSPORTATION DEPARTMENT
ENGINEERING DIVISION

**BENCH MARK
DATA SHEET**

ELEV.

16.38'

BM. NO.

157B

DATE DRAWN: 6/5/85 BY: RJJ

DATE	TYPE	F.B. PG.	BY	REF: F.B.	PG.	DATE
REVISIONS						

ELEV. BASED ON USC&GS

TO REACH THE MARK FROM ~~FROM~~ INTER. BLACKBURN PT. RD. &
ENTRANCE TO SOUTHBAY, TBM IS A CUT 50.
ON CURB OF ISLAND

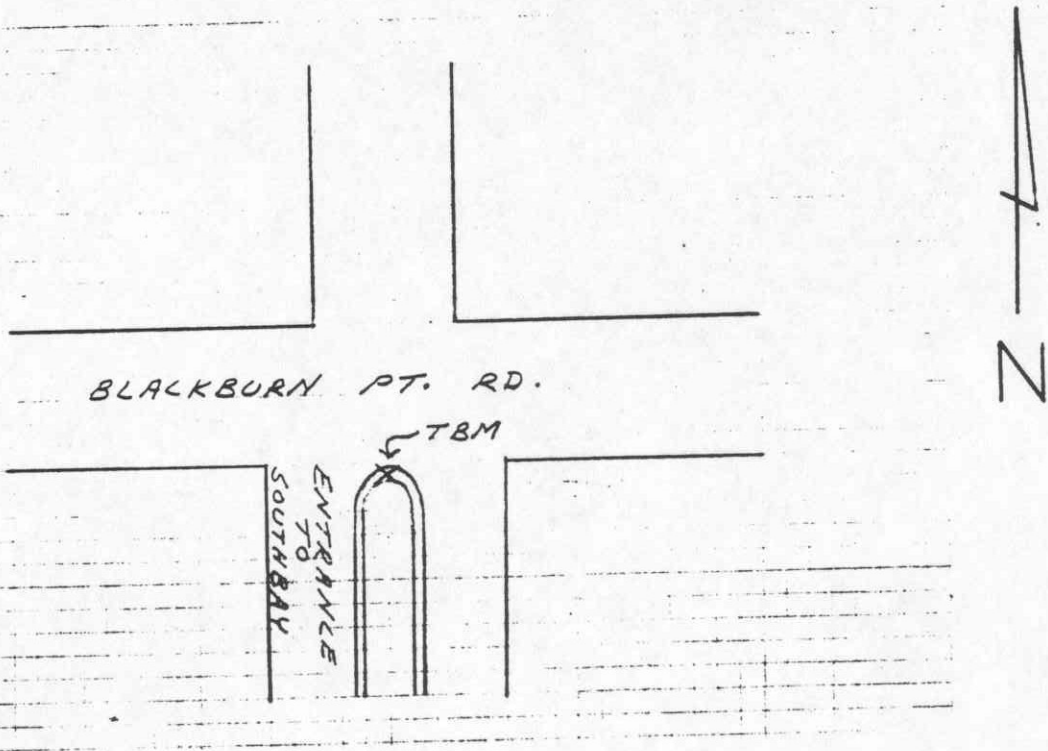
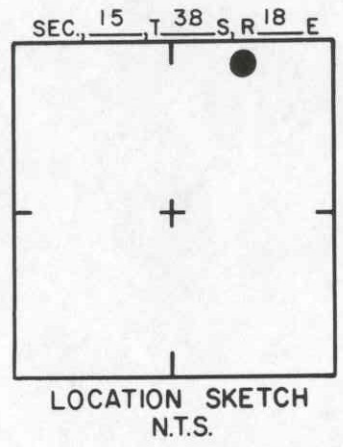
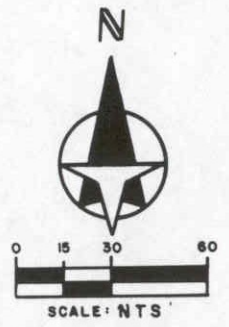

SARASOTA COUNTY
TRANSPORTATION DEPARTMENT
ENGINEERING DIVISION

**BENCH MARK
DATA SHEET**

ELEV.
14.61
BM. NO.
157C

DATE DRAWN: 2-2-87 BY: RJJ

REF: SWFWMD HFH .170 DATE 10/81

ELEV. BASED ON B.M. NO. NOS

DATE	TYPE	FB. PG.	BY
REVISIONS			

TO REACH THE MARK FROM INTER. US-41 & BLACKBURN PT. RD.
TBM IS A CUT SQ. ON N.E. END OF A
CONCRETE CULVERT PIPE

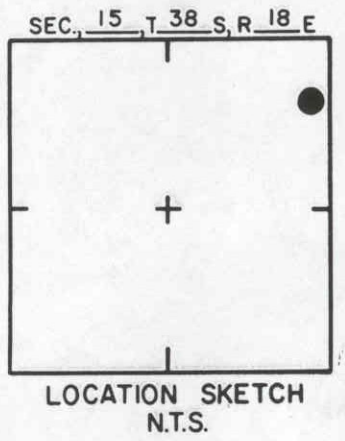
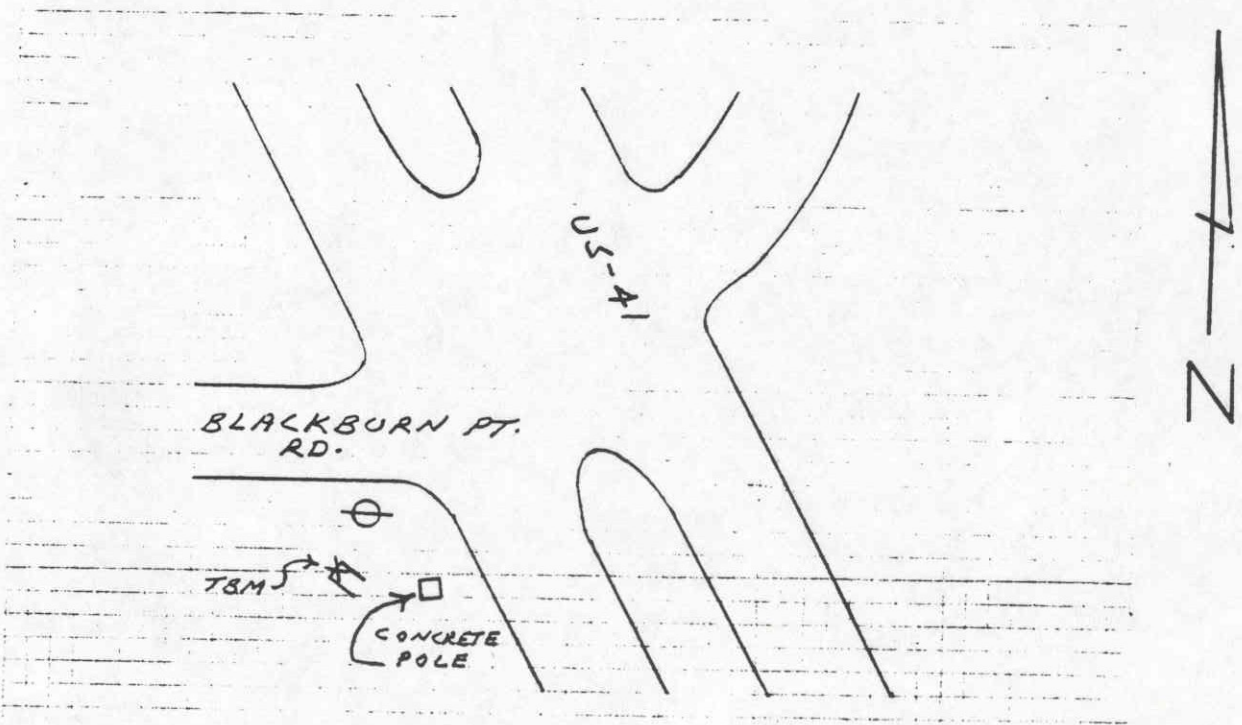
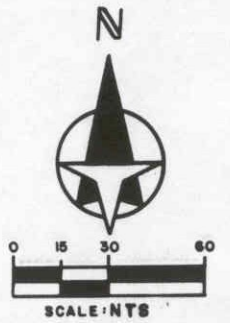

SARASOTA COUNTY TRANSPORTATION DEPARTMENT ENGINEERING DIVISION			
BENCH MARK DATA SHEET			ELEV. 15,31'
DATE DRAWN: 2-2-87		BY: RJJ	
REF: SWFWMD HFH 172		DATE IQ/81	
ELEV. BASED ON B.M. NO. NOS			BM. NO. 157E

DATE	TYPE	FB. PG.	BY
REVISIONS			

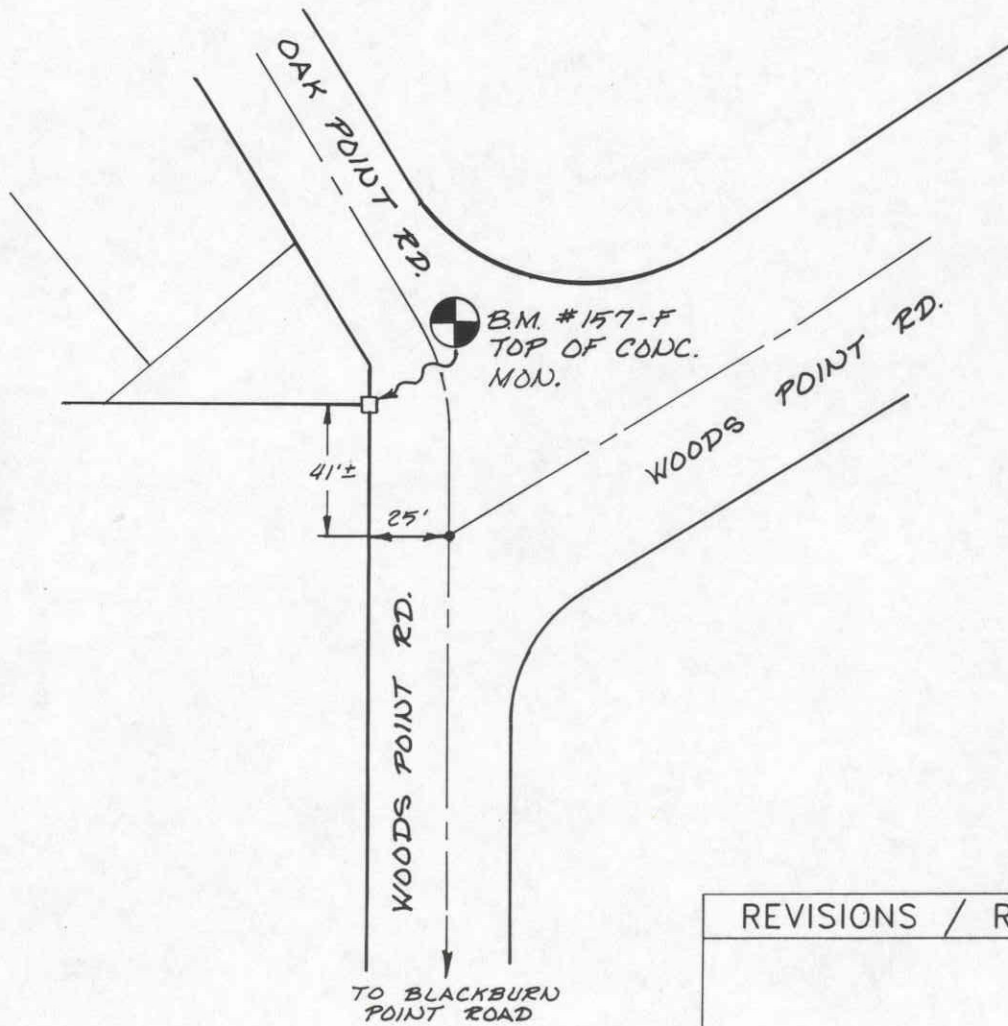

SCALE: N.T.S.

SEC. 15 , T. 38 S, R. 18 E

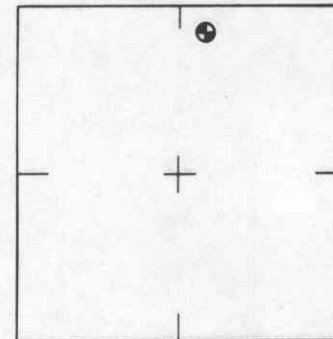

LOCATION SKETCH
N.T.S.

SARASOTA COUNTY
TRANSPORTATION DEPARTMENT
ENGINEERING DIVISION, SURVEY/MAPPING SECTION

REVISIONS / REMARKS	BENCH MARK DATA SHEET	
		ELEV.
	DATE DRAWN: 2-22-91	BY: SPOCK
	REF.: P.B. 34 PG. 46	DATE: 2-22-91
	ELEV. BASED ON B.M. NO. S.C. B.M #157	B.M. NO. 157-F
SET BY: S, W & N INC.		

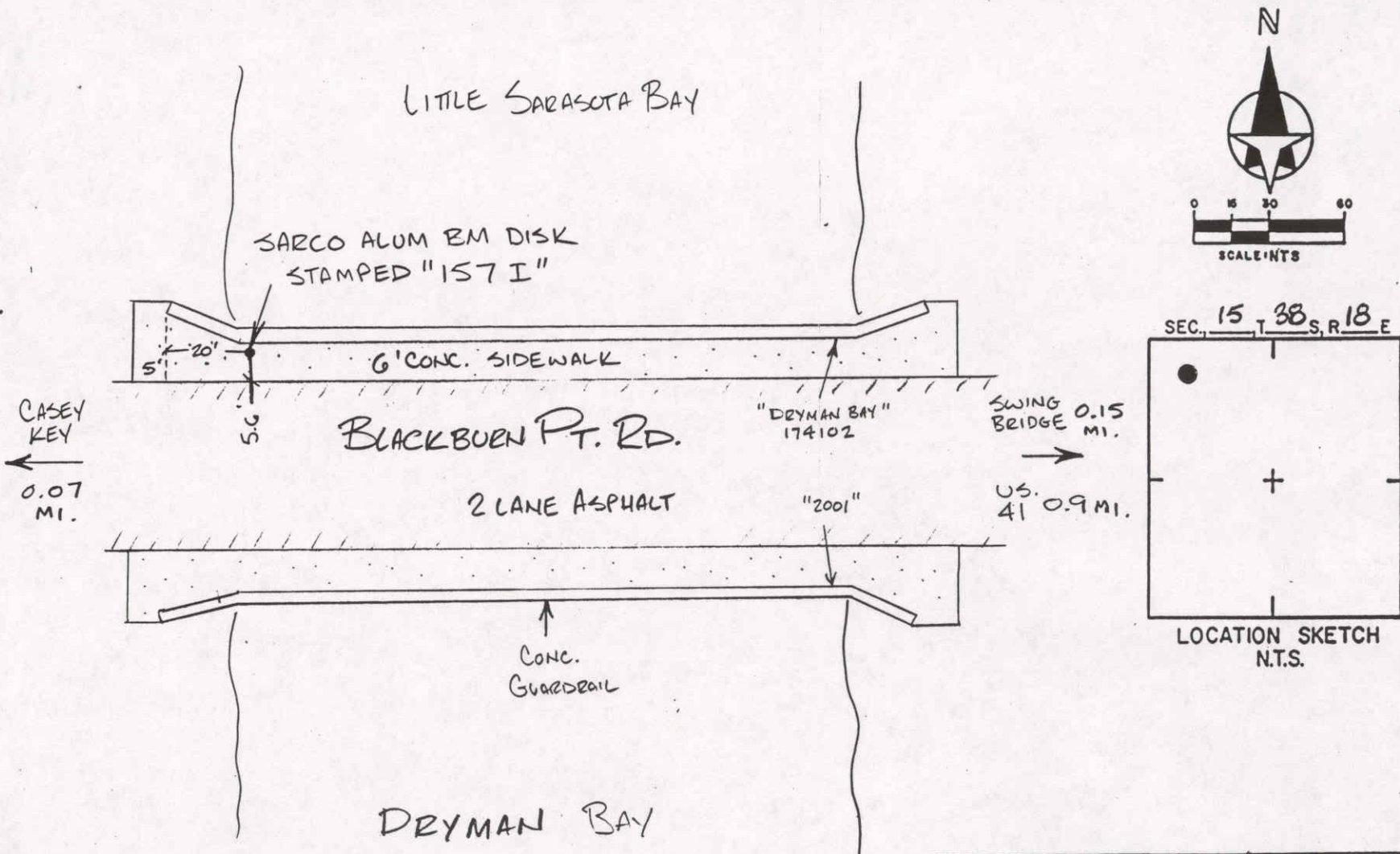

SARASOTA COUNTY
Development Services
Survey-Mapping

WGS 84	LAT. 27°10'48.1" N					BENCH MARK DATA SHEET		ELEV.
	LON. 82°29'50.5" W							6.52' NGVD 29'
FL.W. 83	N. 1034934' +/-	DATE	TYPE	FB. PG.	BY	DATE DRAWN: 9-24-02	BY: ND	BM. NO.
	E. 494474' +/-	REVISIONS				REF: FB440 PG 74	DATE 8/01	157I
ELEV. BASED ON BM. NO. 157 TIDAL								

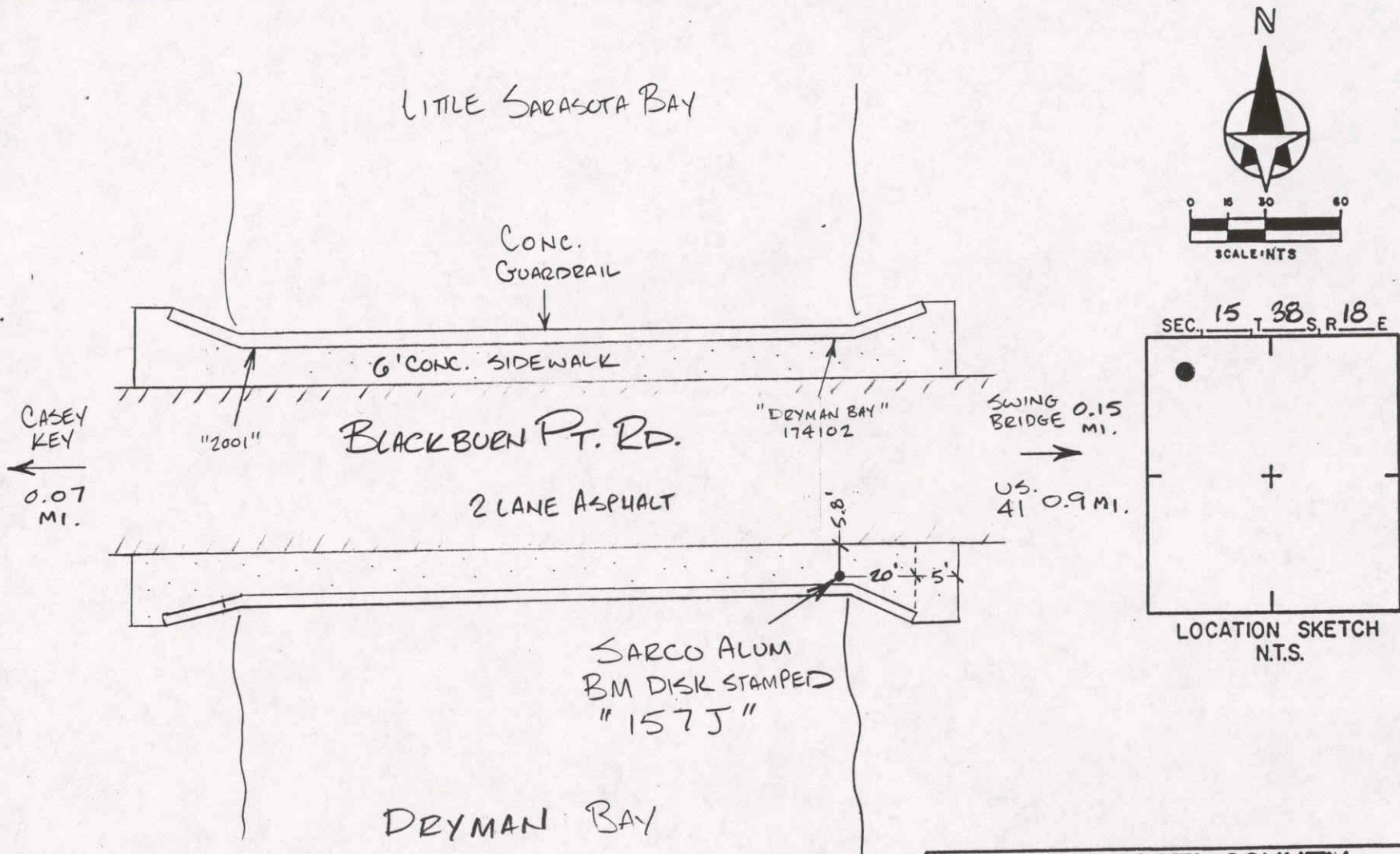

SARASOTA COUNTY Development Services Survey-Mapping	
BENCH MARK DATA SHEET	ELEV. 6.49' NGVD 29'
DATE DRAWN: 9-24-02 BY: ND	BM. NO.
REF: FB 440 PG 74 DATE 8/01	157J
ELEV. BASED ON B.M. NO. 157 TIDAL	

WGS 84	LAT. 27° 10' 47.6" N
	Lon. 82° 29' 48.9" W
FL.W. 83	N. 1034883' +/-
	E. 494618' +/-

DATE	TYPE	FB. PG.	BY
REVISIONS			

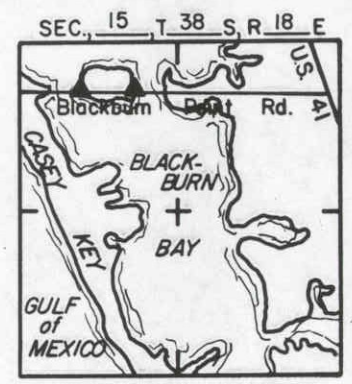
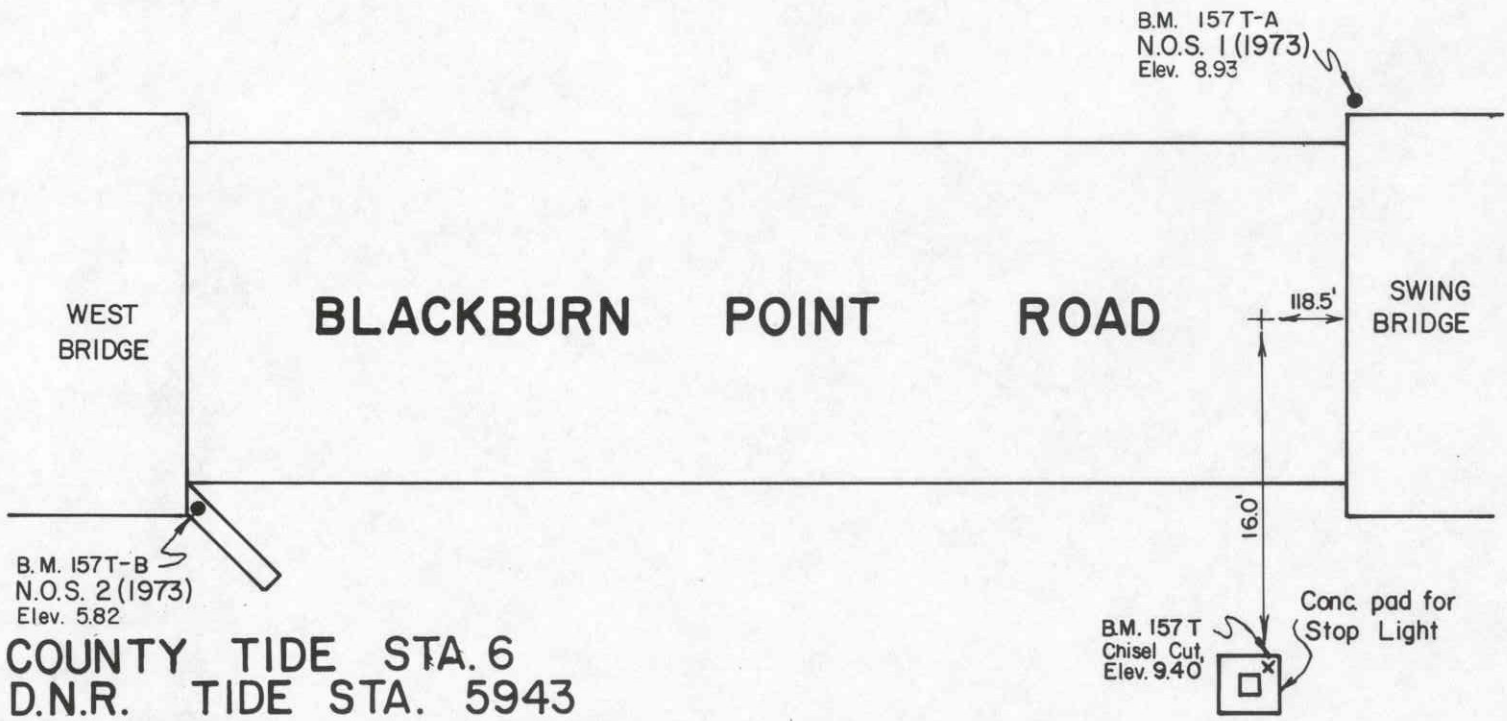

LOCATION SKETCH
N.T.S.

BLACKBURN POINT				SARASOTA COUNTY TRANSPORTATION DEPARTMENT ENGINEERING DIVISION	
FEB '91 D.N.R. STA. GES				DATE DRAWN: 4-30-86	BY: WFW
DATE	TYPE	FB. PG.	BY	REF: FB. 254 PG. 29	DATE 9/10/82
REVISIONS				ELEV. BASED ON B.M. NO. NOS 1	
				ELEV.	9.40'
				BM. NO.	157-T

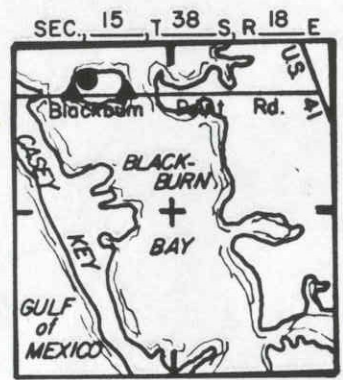
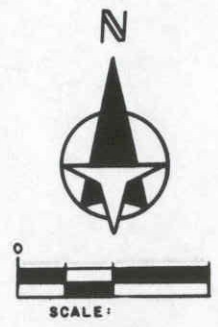
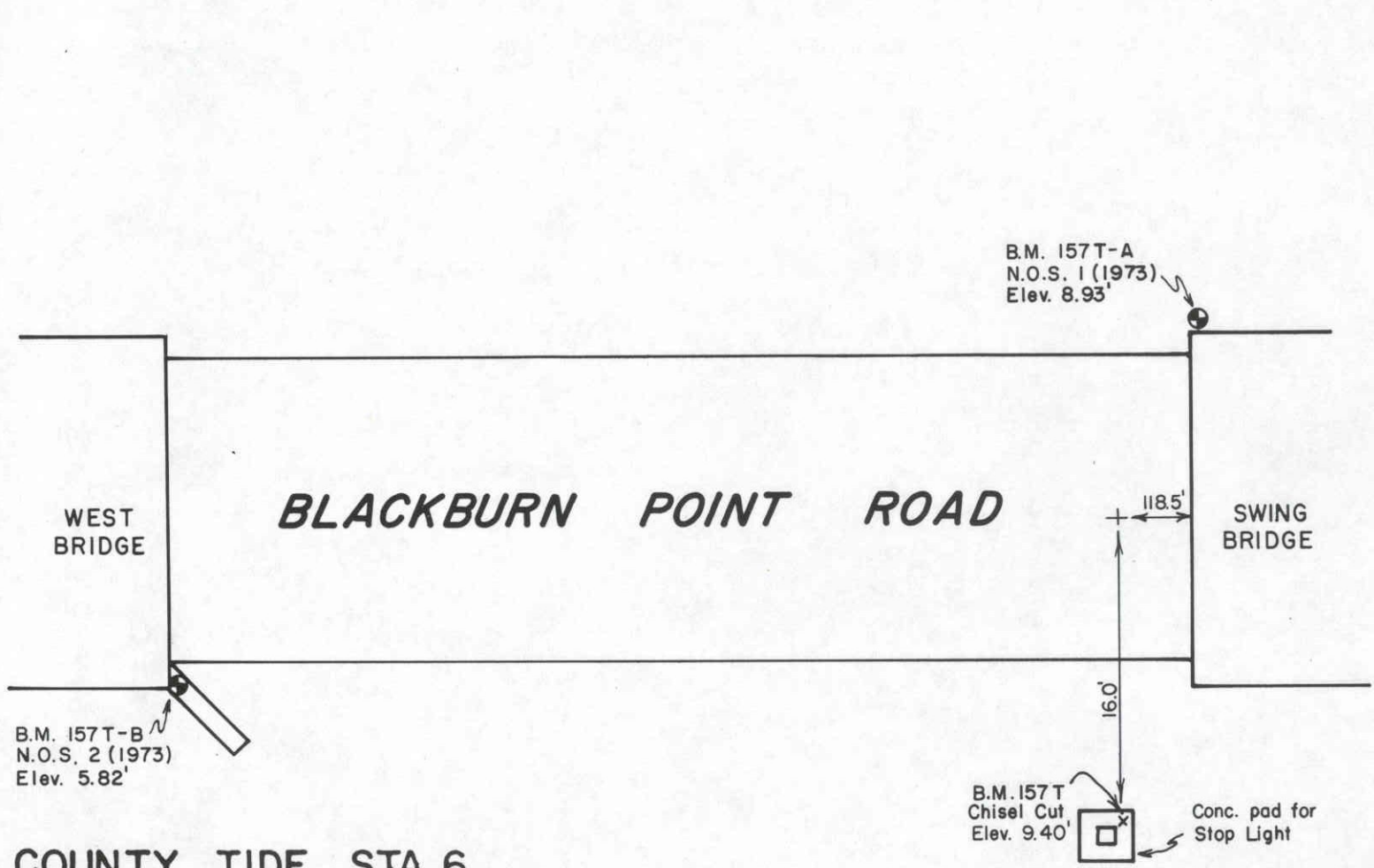

LOCATION SKETCH
N.T.S.

COUNTY TIDE STA. 6
D.N.R. TIDE STA. 5943

BLACKBURN POINT

SARASOTA COUNTY
TRANSPORTATION DEPARTMENT
ENGINEERING DIVISION

				BENCH MARK DATA SHEET		ELEV.		
						8.93'		
FEB '91 D.N.R. STA.				G E S		DATE DRAWN: 4-29-86	BY: WFW	BM. NO.
DATE	TYPE	FB. PG.	BY	REF: FB. 254	PG. 29	DATE 9/10/82		157T-A
REVISIONS				ELEV. BASED ON B.M. NO.				

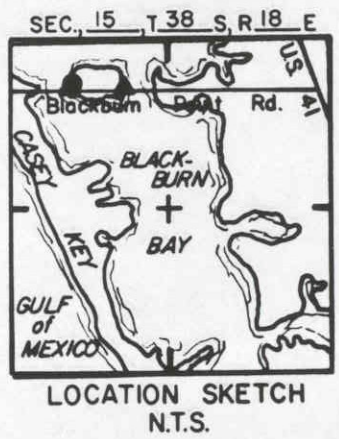
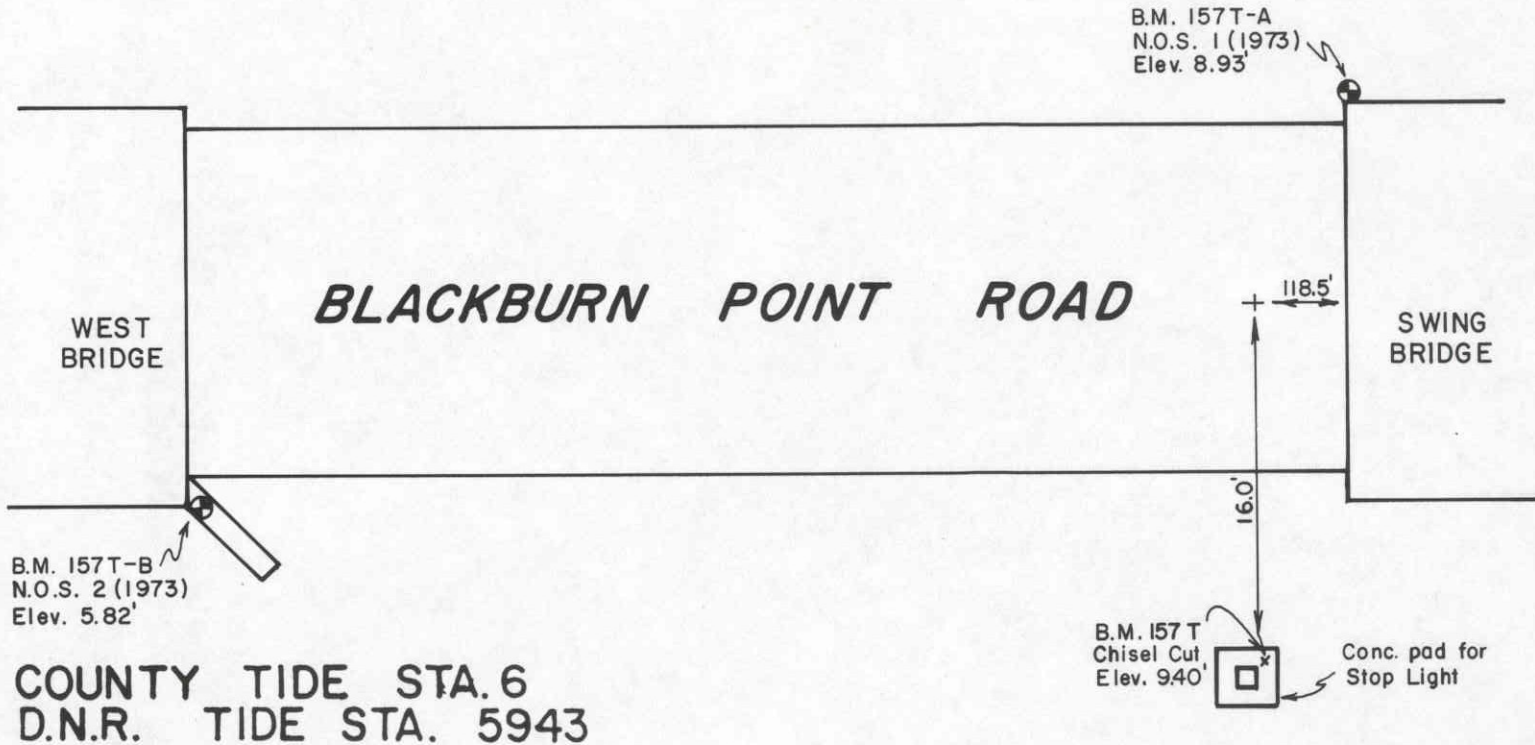

COUNTY TIDE STA. 6
D.N.R. TIDE STA. 5943

BLACKBURN POINT

SARASOTA COUNTY
TRANSPORTATION DEPARTMENT
ENGINEERING DIVISION

REVISIONS				BENCH MARK DATA SHEET		ELEV.
DATE	TYPE	F.B. PG.	BY	DATE DRAWN:	BY:	5.82'
				REF: F.B. 254 PG. 29	WFW	BM. NO.
				DATE 9/10/82		157T-B
				ELEV. BASED ON B.M. NO.		

FEB '91 D.N.R. STA. GES