

**SARASOTA COUNTY
TRANSPORTATION DEPARTMENT
ENGINEERING DIVISION**

BENCH MARK DATA SHEET		ELEV. 7.21'
		BM. NO. 158A
DATE DRAWN: 10/85		BY: PJB
REF: PB. 29	PG. 22	DATE 10/85
ELEV. BASED ON BM. NO. SARCO 156		

DATE	TYPE	F.B. PG.	BY
REVISIONS			

TO REACH THE MARK FROM INTER ISLAND WAY & SOUTH CREEK DR;
GO S. $\frac{1}{2}$ 0.10 MILES TO END OF ST. & TRM.
TRM IS CHISELED SQUARE ON S.W. COR CONC. M.H.
BASE

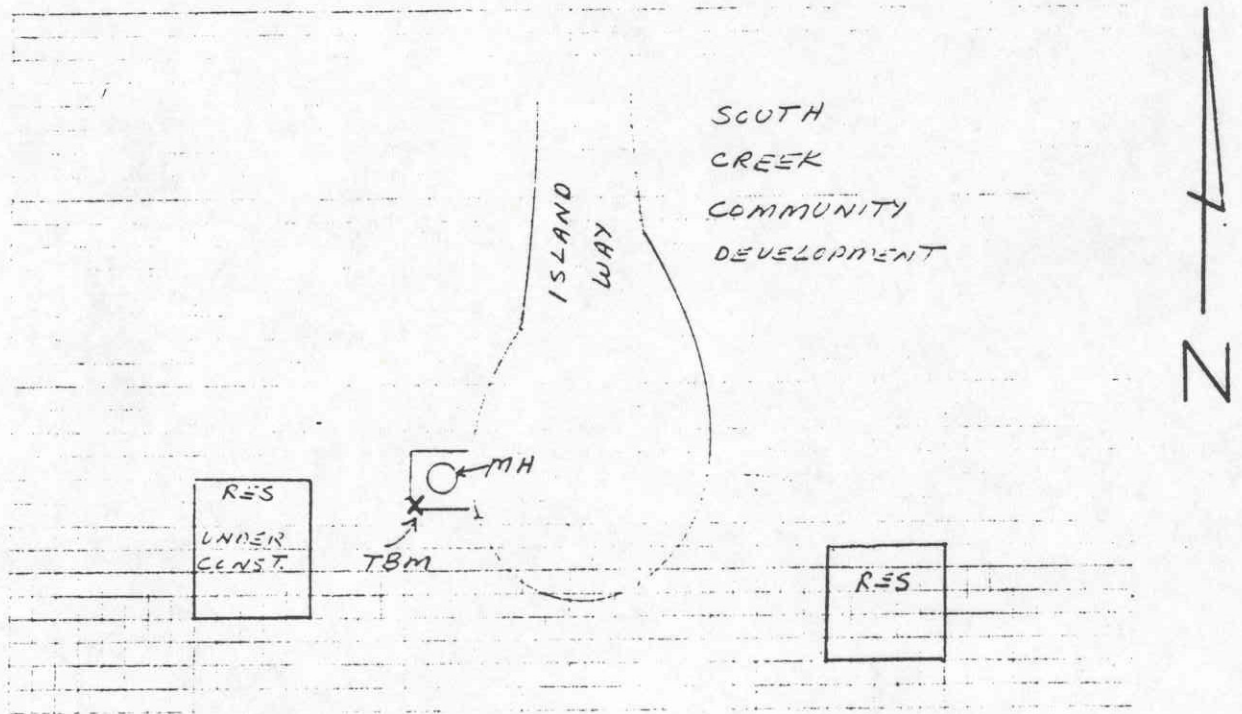
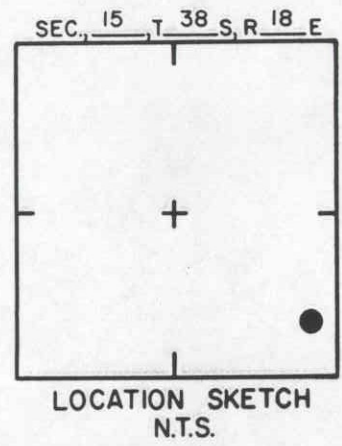

SARASOTA COUNTY TRANSPORTATION DEPARTMENT ENGINEERING DIVISION			
BENCH MARK DATA SHEET			ELEV. 4.07'
DATE DRAWN: 2-2-87		BY: RJJ	
REF: SWFWMD HFH .176 DATE 10/81			BM. NO. 158B
REVISIONS			ELEV. BASED ON B.M. NO. NOS

DATE	TYPE	FB. PG.	BY
REVISIONS			