

TO REACH THE MARK FROM AT INTER SORRENTO DR. & BAY SHORE RD.
TBM IS 60 D NAIL IN E FACE P-POLE.

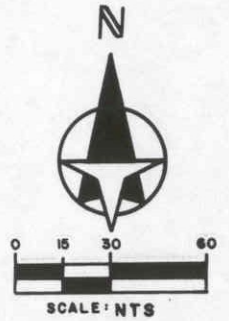

SEC. 23 T. 38 S. R. 18 E

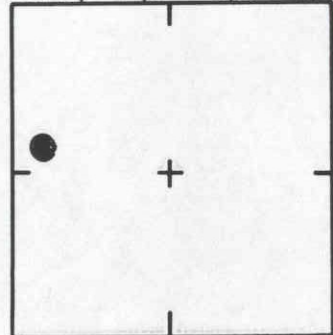

LOCATION SKETCH
N.T.S.

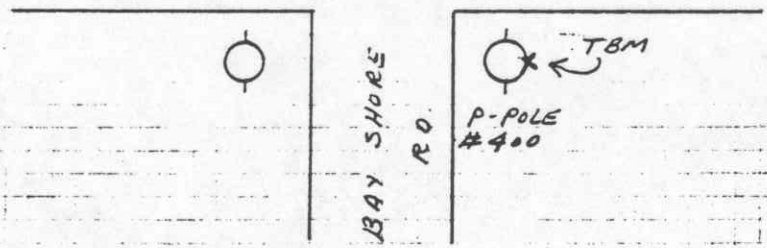
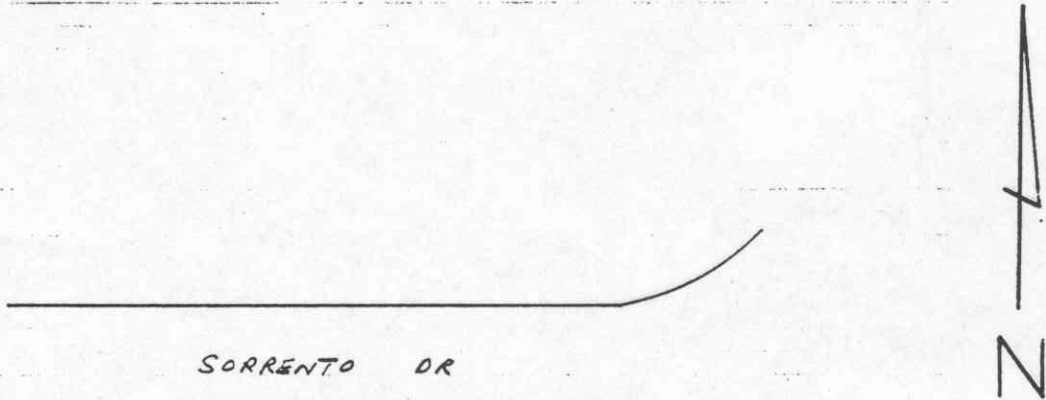

SARASOTA COUNTY
TRANSPORTATION DEPARTMENT
ENGINEERING DIVISION

**BENCH MARK
DATA SHEET**

ELEV.

12,08'

DATE DRAWN: 2-4-87 BY: RJJ

BM. NO.

DATE TYPE FB. PG. BY REF: SWFWMD HFH.192 DATE 10/81

160

REVISIONS

ELEV. BASED ON B.M. NO. NOS

T. SNIDER
K. GINDERSBERGER

7-2-92

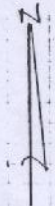
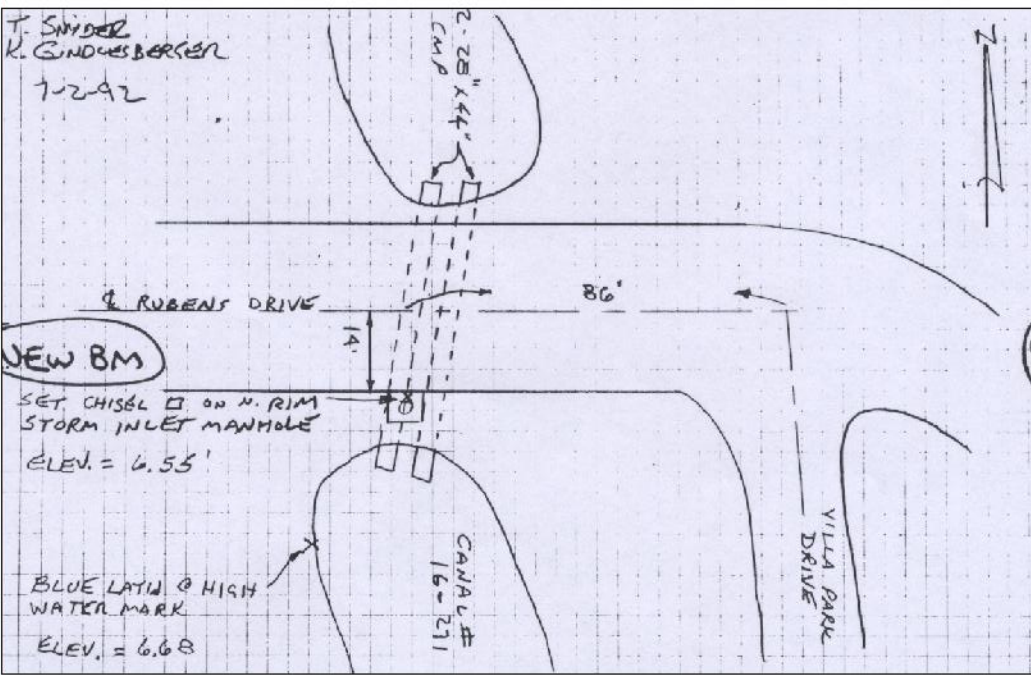

SCALE: N.T.S.

SEC., 23, T. 38 S., R. 18 E

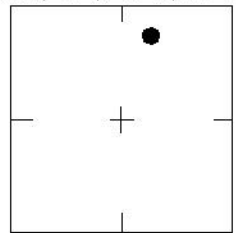

LOCATION SKETCH
N.T.S.

NEW BM

SET CHISEL □ ON N. RIM
STORM INLET MANHOLE
ELEV. = 6.55'

BLUE LATIN @ HIGH
WATER MARK
ELEV. = 6.68

CANAL #
16-211

VILLA PARK
DRIVE

WGS 84	Lat: °	REVISIONS / REMARKS
	Lon: °	
FL W. 83	N.	SET BY:
	E.	

SARASOTA COUNTY Geomatics Service Center SURVEY/MAPPING SECTION	
BENCH MARK DATA SHEET	
DATE DRAWN: 10-28-04	BY: JRM
REF.: BASED ON CONSULTANTS FIELD NOTES DATE: 7-2-92	
ELEV. BASED ON B.M. NO. 156	ELEV. 6.55 NGVD 29' B.M. NO. 160-A