

DESCRIPTION OF BENCH MARK

Designation H 253  
 Nearest town Venice  
 Distance and direction from nearest town 3.7 miles north  
 Character of mark A C&GS Bench Mark Disk  
 Established by C&GS

State Florida  
 County Sarasota

County Sarasota  
 Chief of party R. Cerrish  
 Levelling date 1/66  
 Stamping H 253 1965 EL 13,258

Detailed description  
 3.7 miles north along the Seaboard Air Line Railroad from the station at Venice, about 1.1 mile north of the crossing of Laurel Road, about 0.1 mile north of milepost 899, in section 24, R 18 E, T 38 S, 27.5 feet west of the west rail of the main track, 51 feet south of the fourth pole north of the milepost, 2.5 feet north of a metal witness post, about 11 feet below the level of the track and is a disk welded on top of a 3 1/4-inch by 4-foot long iron pipe projecting 0.5 foot.

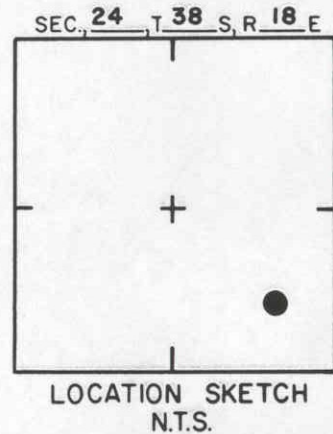
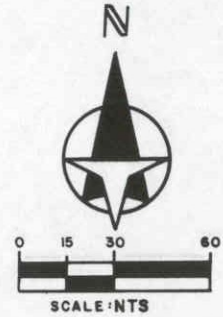
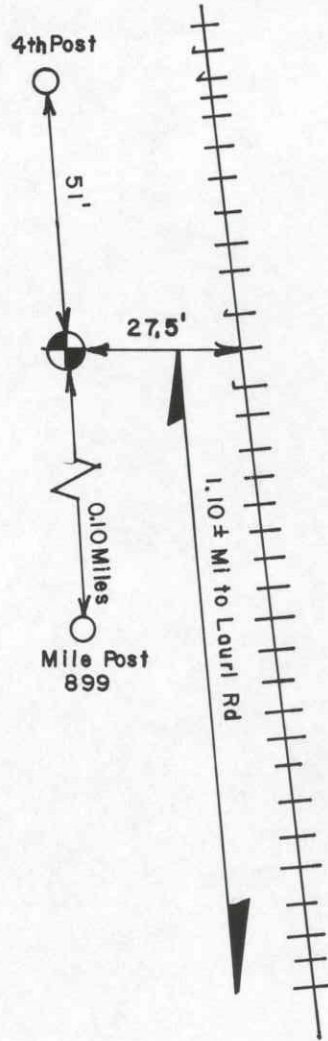

<b>SARASOTA COUNTY</b> TRANSPORTATION DEPARTMENT ENGINEERING DIVISION					
<b>BENCH MARK DATA SHEET</b>					ELEV. 13,258
DATE DRAWN: 3-11-87			BY: RJJ		BM. NO. 163A
DATE	TYPE	FB. PG.	BY	REF: NOS H253	DATE 1/66
REVISIONS					ELEV. BASED ON B.M. NO.

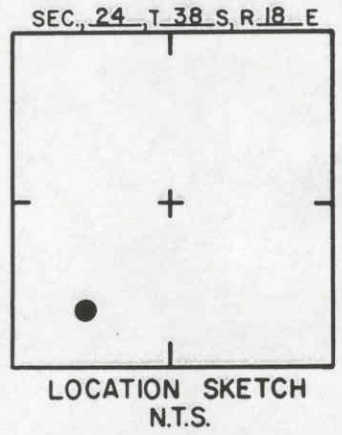
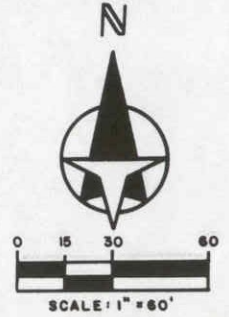
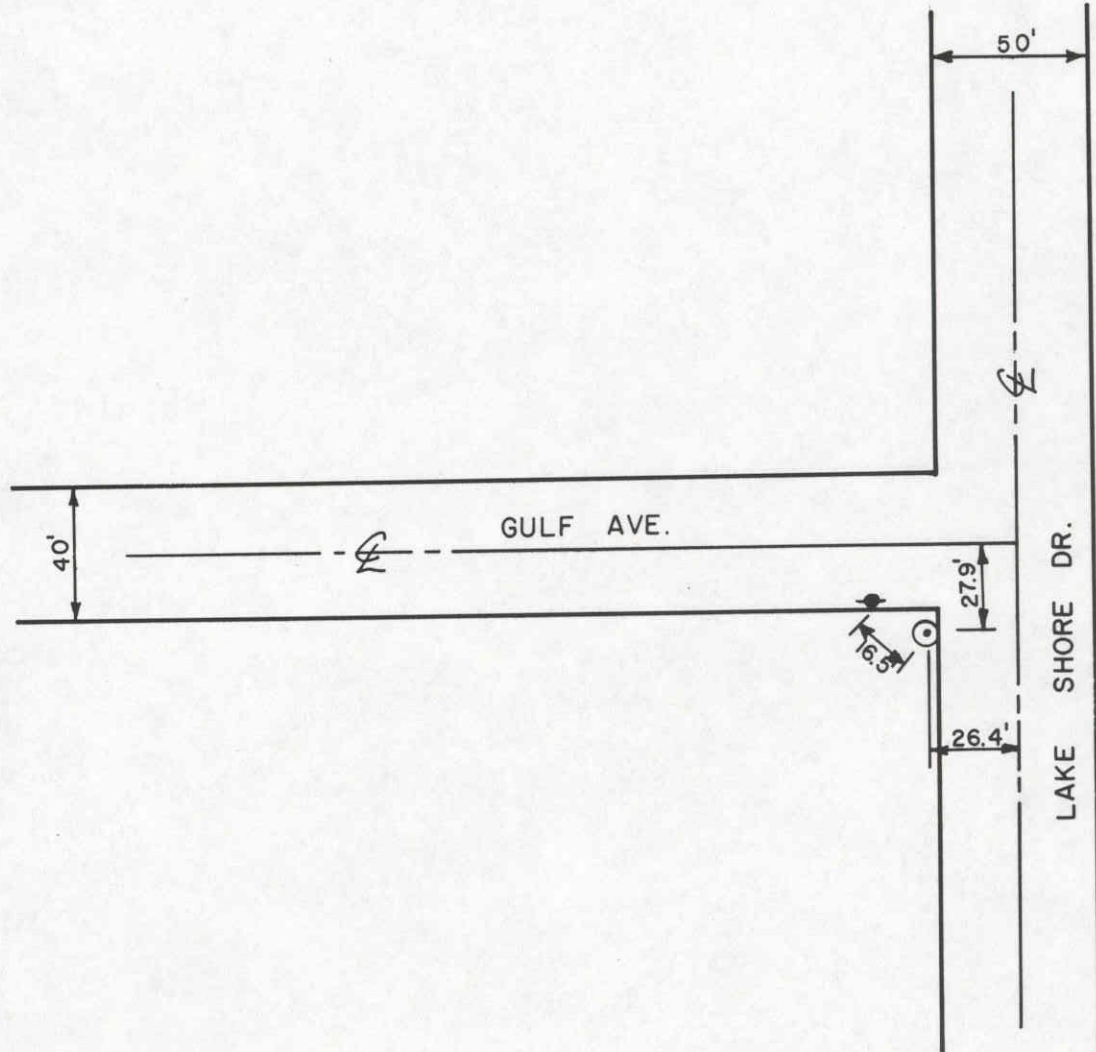

**SARASOTA COUNTY**  
 TRANSPORTATION DEPARTMENT  
 ENGINEERING DIVISION

<b>BENCH MARK DATA SHEET</b>	ELEV.
	12.41'
DATE DRAWN: 9-12-84 BY: SRB	BM. NO.

DATE	TYPE	FB. PG.	BY	REF: FB. 254 PG. 58 DATE 8-16-84	R-163
<b>REVISIONS</b>				ELEV. BASED ON B.M. NO. 161	