

THE ORIGINAL DESCRIPTION IS OBSOLETE. A NEW DESCRIPTION FOLLOWS--

LOCATED IN THE SOUTHWEST PART OF VENICE, AT THE INTERSECTION OF FIRST STREET AND SUNSET DRIVE, 28.5 FEET SOUTH OF CENTERLINE OF FIRST STREET, 40.6 FEET SOUTH-SOUTHWEST OF AN 8-INCH PINE TREE, 46 FEET WEST OF CENTERLINE OF SUNSET DRIVE, 143 FEET NORTH OF PROPERTY LINE HEDGE OF AUSTRALIAN PINES, AND 329 FEET EAST OF BLUFF AT EDGE OF GULF.

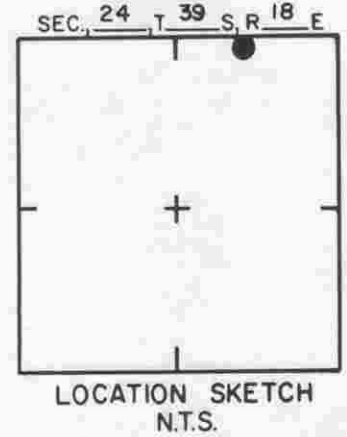
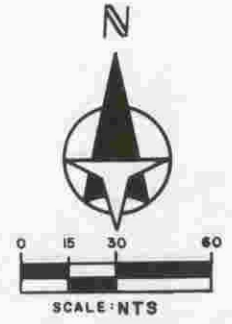
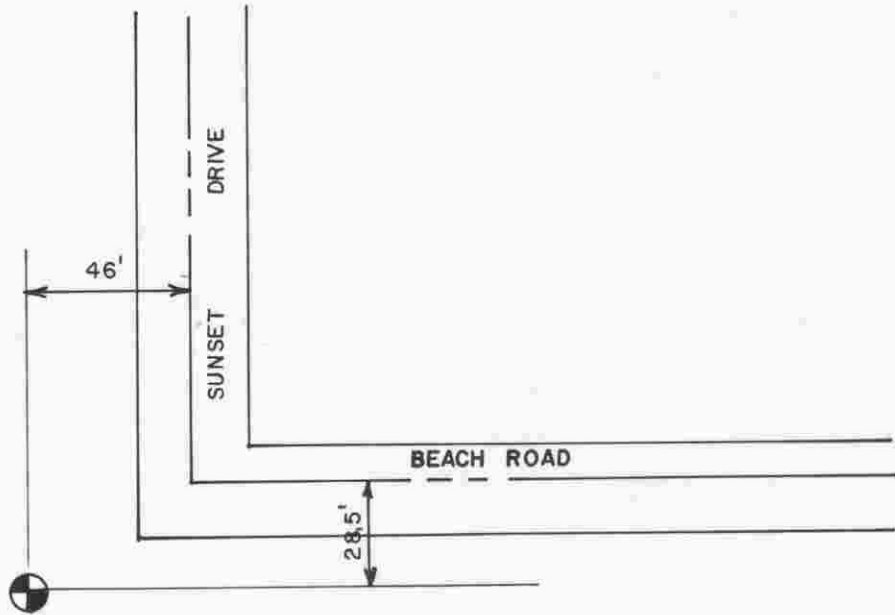

**SARASOTA COUNTY**  
 TRANSPORTATION DEPARTMENT  
 ENGINEERING DIVISION

**BENCH MARK  
 DATA SHEET**

ELEV.

11.9'

BM. NO.

178 C

DATE DRAWN: MAY 1987

BY: RJJ

REF: NOS V100 PLUS 00 USE DATE 7/80

DATE	TYPE	FB. PG.	BY
REVISIONS			

ELEV. BASED ON B.M. NO.

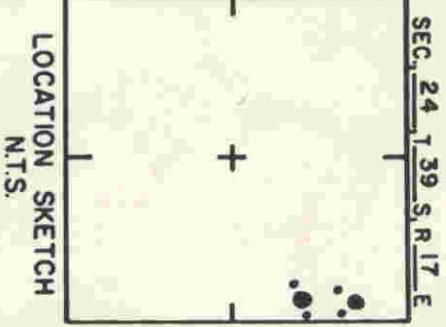
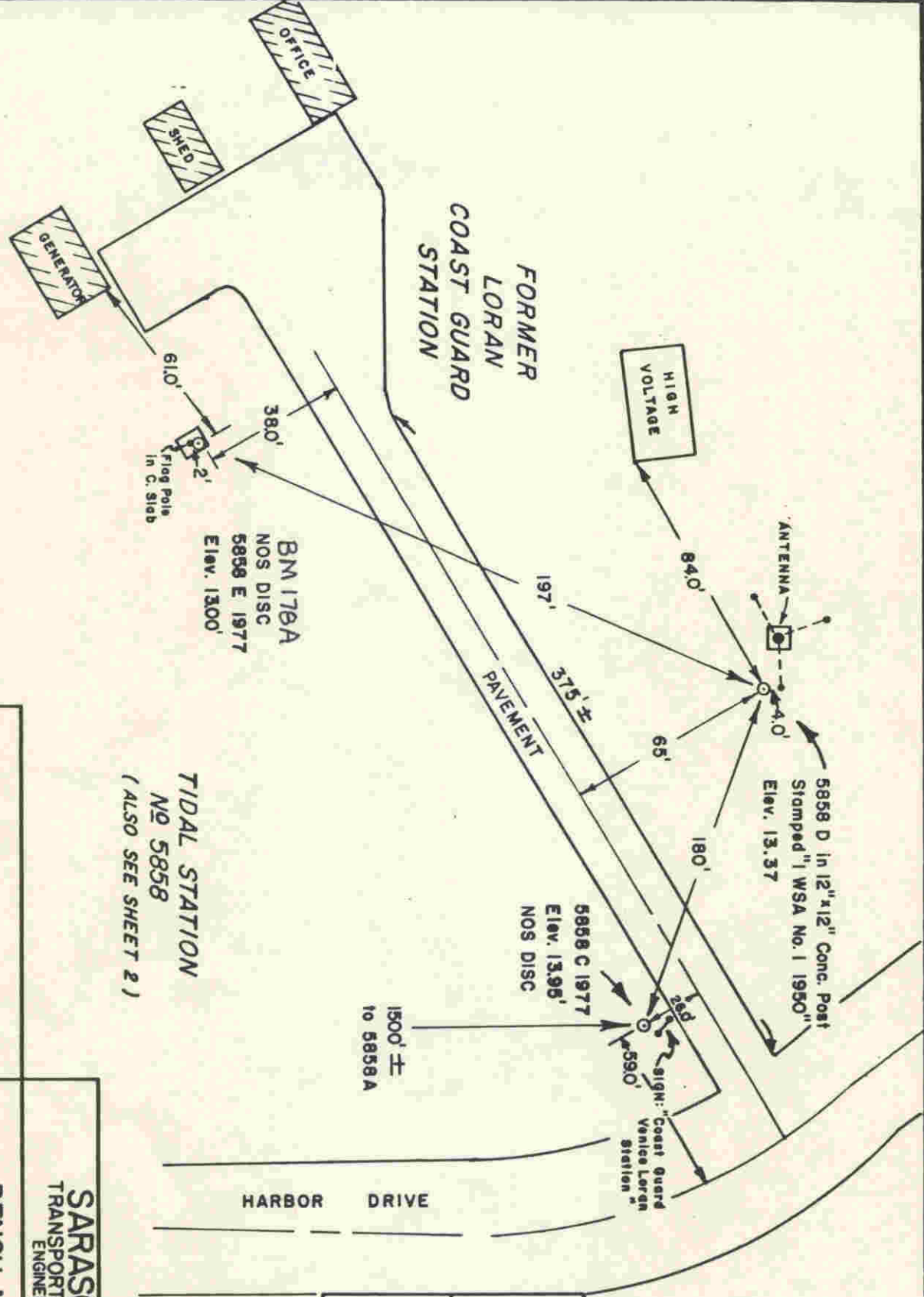

SHEET 1 of 2

SARASOTA COUNTY  
TRANSPORTATION DEPARTMENT  
ENGINEERING DIVISION

BENCH MARK  
DATA SHEET

DATE	TYPE	FB. PG.	BY	DATE DRAWN: 8/1/83	BY: DBP	ELEV.
				REF: FB. 244	PG. 25-65	13.00'
				DATE 9/79		BM. NO.
				ELEV. BASED ON BM. NO. C.G.S. Y-118		176A

REVISIONS

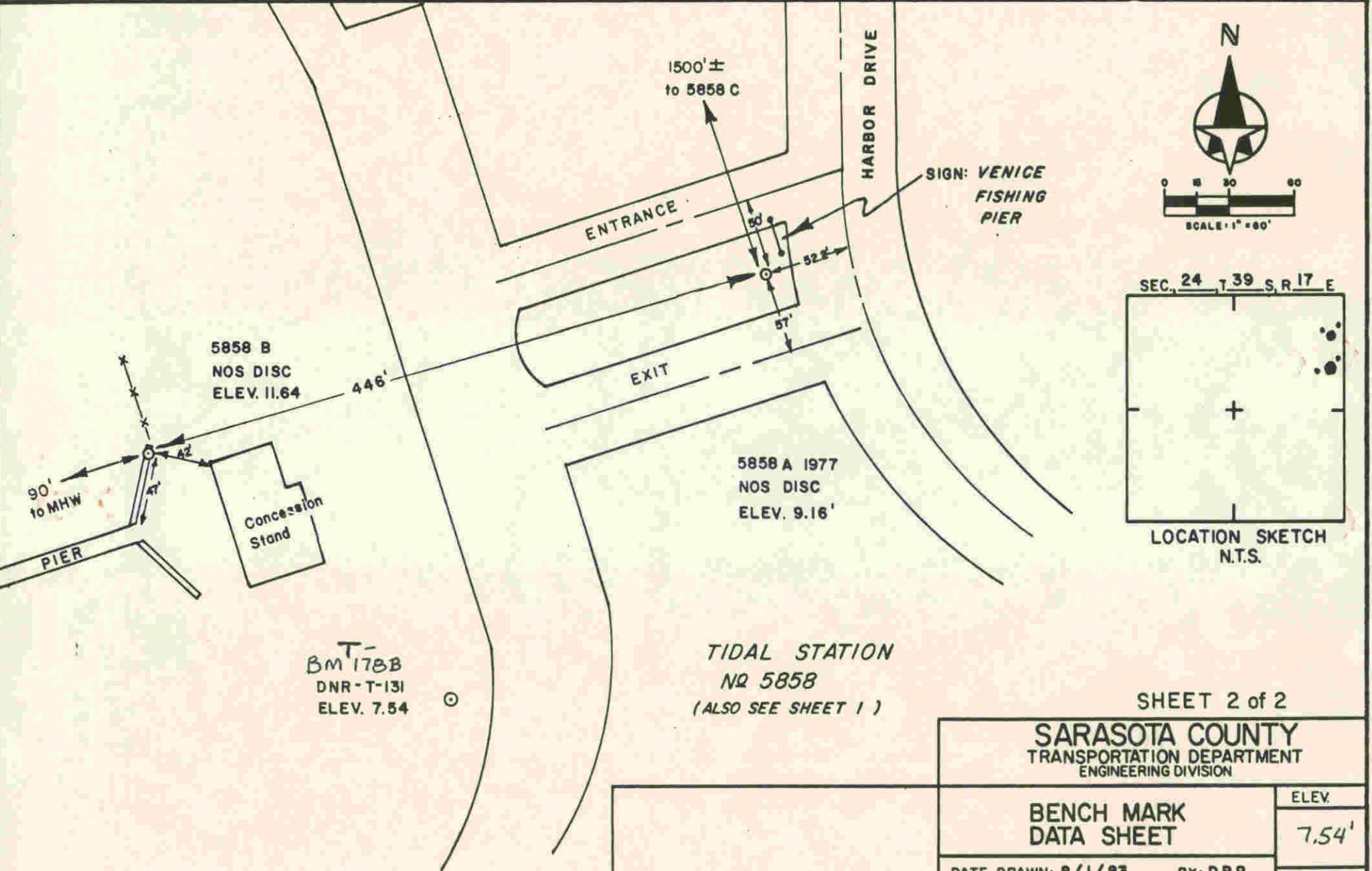

SEC. 24 T. 39 S. R. 17 E

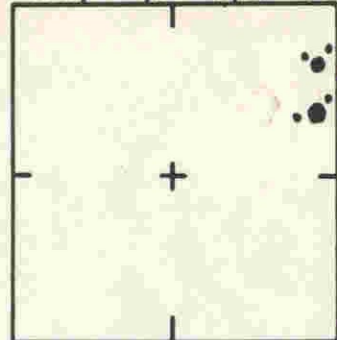

LOCATION SKETCH  
N.T.S.

TIDAL STATION  
NR 5858  
(ALSO SEE SHEET 1)

SHEET 2 of 2

SARASOTA COUNTY  
TRANSPORTATION DEPARTMENT  
ENGINEERING DIVISION

BENCH MARK  
DATA SHEET

ELEV.  
7.54'

DATE DRAWN: 8/1/83 BY: DBP

BM. NO.

DATE	TYPE	F.B. PG.	BY
REF: F.B. 244	PG. 25-65	DATE 9/79	

T-1788

REVISIONS

ELEV. BASED ON B.M. NO. CGS. Y-118