

SARASOTA COUNTY  
 TRANSPORTATION DEPARTMENT  
 ENGINEERING DIVISION

BENCH MARK  
 DATA SHEET

ELEV.  
 36.33'  
 34.58'  
 BM. NO.  
 219-C  
 219B

DATE DRAWN: 10/85 BY: PJB  
 REF: PB. 29 PG. 45 DATE 10/85

ELEV. BASED ON BM. NO. S. F-93

REVISIONS			
DATE	TYPE	FB. PG.	BY

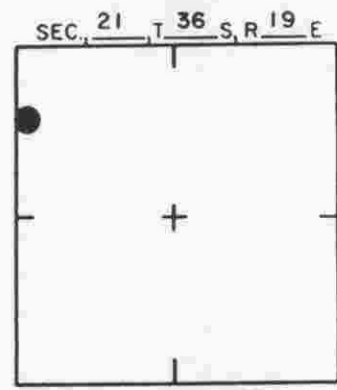
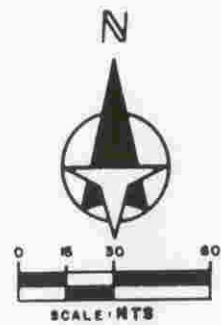
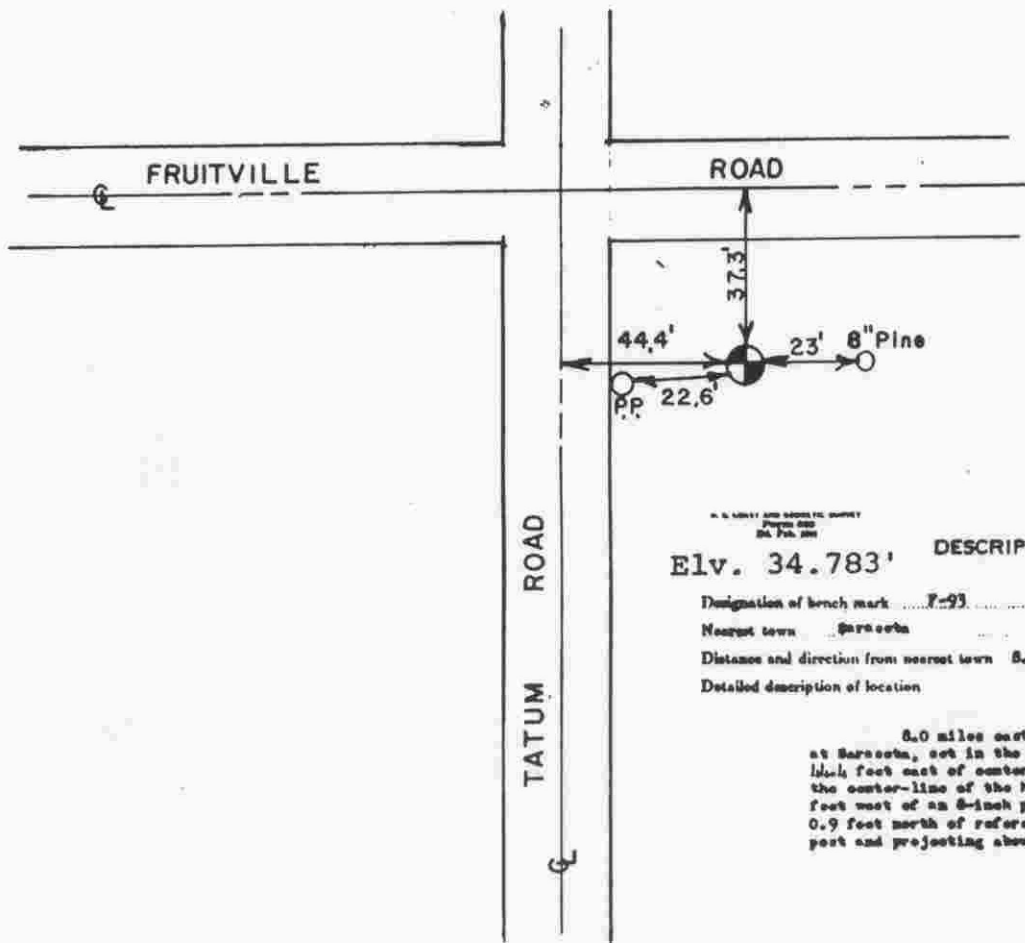

LOCATION SKETCH  
N.T.S.

U. S. GOVERNMENT PRINTING OFFICE  
1964 O 348 200

**DESCRIPTION OF BENCH MARK**

Elev. 34.783'

Designation of bench mark F-93 State Florida County Sarasota  
 Nearest town Sarasota County Sarasota  
 Distance and direction from nearest town 8.0 miles east of, along State Highway No. 18.  
 Detailed description of location Stamped "F 93 1942"

8.0 miles east along State Highway No. 18 from the Post Office at Sarasota, set in the southeast quarter of the public road crossing, 14.4 feet east of center-line of the road leading south, 37.3 feet south of the center-line of the highway, 22.6 feet east of the power-line pole, 23 feet west of an 8-inch pine tree with a triangular blaze on the north side, 0.9 feet north of reference post. Bench mark disk set in top of a concrete post and projecting about 0.2 feet above the ground.

**SARASOTA COUNTY  
TRANSPORTATION DEPARTMENT  
ENGINEERING DIVISION**

				<b>BENCH MARK DATA SHEET</b>		ELEV.
						34,783
				DATE DRAWN: 3-25-87	BY: RJJ	BM. NO.
DATE	TYPE	FB. PG.	BY	REF: NOS F93	DATE: 1/66	2190
<b>REVISIONS</b>				ELEV. BASED ON BM. NO.		