

TO REACH THE MARK FROM INTER VIC EDWARDS RD & SR - 780
GO ± 0.35 MI. E., TBM IS A SRD CAP
S.E. CORNER OF BRIDGE

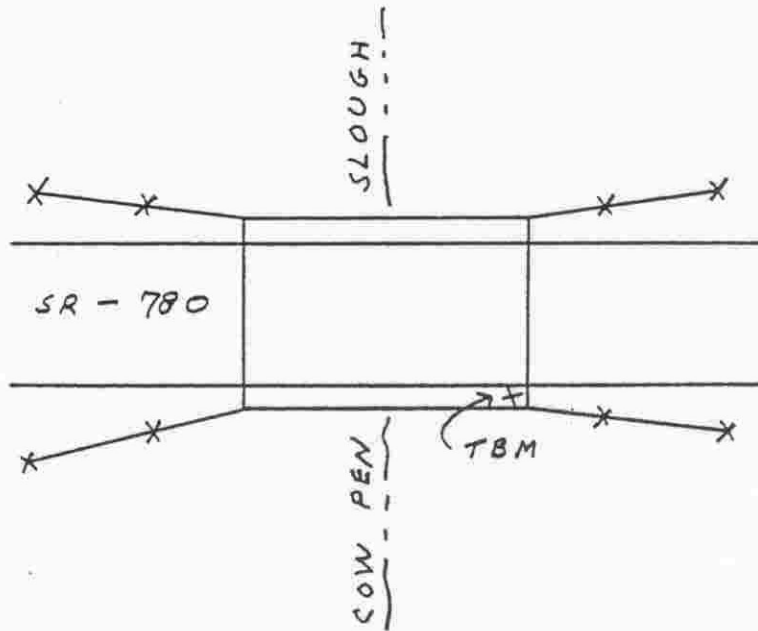

				SARASOTA COUNTY TRANSPORTATION DEPARTMENT ENGINEERING DIVISION			
				BENCH MARK DATA SHEET		ELEV. 44,76'	
DATE		TYPE	FB. PG.	BY	DATE DRAWN: 3-3-87	BY: RJJ	BM. NO. 225A
REVISIONS				REF: SWFWMD GWL 165		DATE 12/80	ELEV. BASED ON B.M. NO. NOS

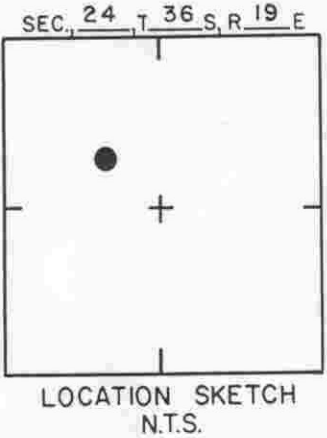
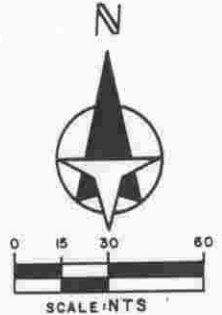
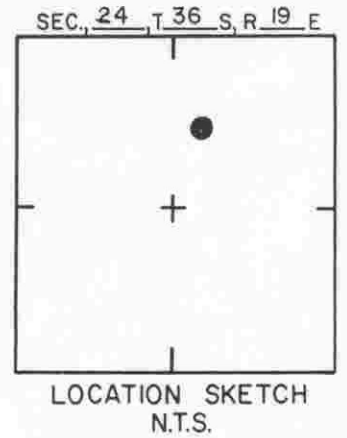
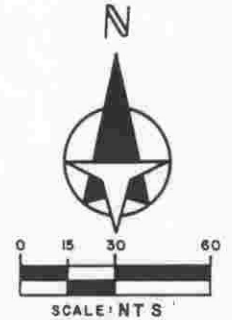
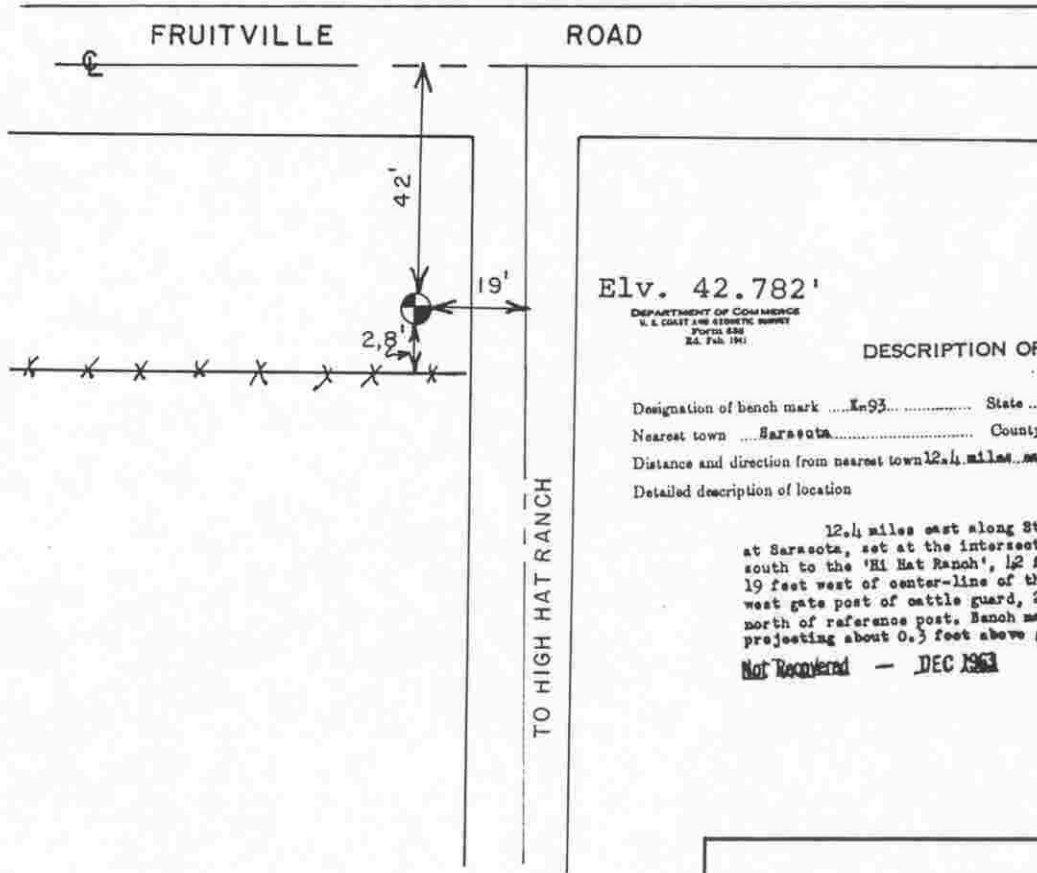

Elev. 42.782'

DEPARTMENT OF COMMERCE
U. S. COAST AND GEODETIC SURVEY
Form 536
24 Feb. 1941

DESCRIPTION OF BENCH MARK

Designation of bench mark In 93 State Florida County Sarasota
 Nearest town Sarasota County Sarasota
 Distance and direction from nearest town 12.4 miles east of along State Highway No. 18
 Detailed description of location Stamped "I 93 1942"

12.4 miles east along State Highway No. 18 from the Post Office at Sarasota, set at the intersection of the highway and a side road leading south to the 'Hi Hat Ranch', 12 feet south of center-line of the highway, 19 feet west of center-line of the side road, 6.3 feet southwest of the west gate post of cattle guard, 2.8 feet northwest of the fence, 1 foot north of reference post. Bench mark disk set in top of concrete post and projecting about 0.3 feet above ground.

~~Not Recovered~~ - DEC 1963

SARASOTA COUNTY
TRANSPORTATION DEPARTMENT
ENGINEERING DIVISION

				BENCH MARK DATA SHEET		ELEV.
						42,782'
				DATE DRAWN: 3-24-87	BY: RJJ	BM. NO.
DATE	TYPE	F.B. PG.	BY	REF: NOS K-93	DATE 1942	225B
REVISIONS				ELEV. BASED ON B.M. NO.		

TO REACH THE MARK FROM INTER. VIC EDWARDS RD. E
SR-780 GO ± 0.50 MI. E., TBM IS A R.R.
SPIKE W. SIDE OF P-POLE, S. SIDE OF ROAD

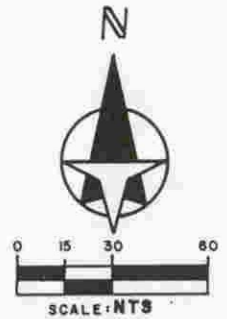

SEC. 24 T. 36 S. R. 19 E

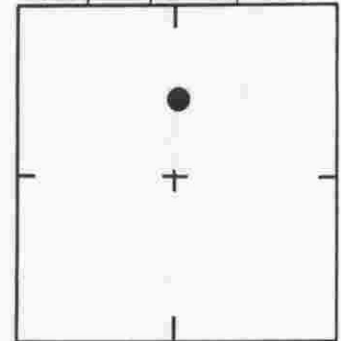

LOCATION SKETCH
N.T.S.

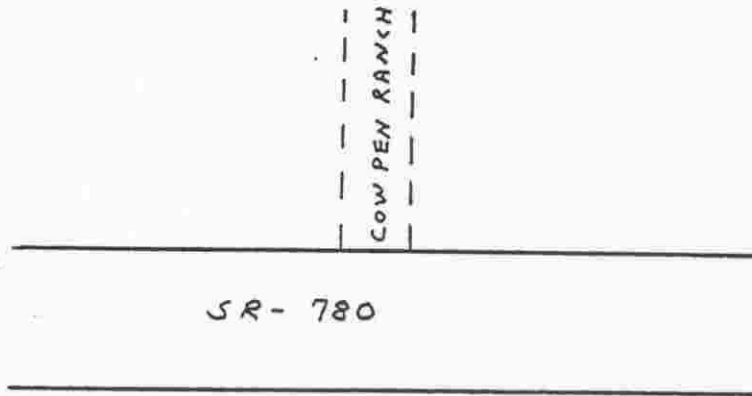

TBM

SARASOTA COUNTY TRANSPORTATION DEPARTMENT ENGINEERING DIVISION			
BENCH MARK DATA SHEET			ELEV. 36.31'
DATE DRAWN: 3-3-87		BY: RJJ	
REF: SWFWMD GWL 164			DATE
ELEV. BASED ON B.M. NO. NOS			225C

DATE	TYPE	FB. PG.	BY
REVISIONS			

STATION IS 9.85 MILES E ALONG STATE HIGHWAY 18 FROM THE ATLANTIC COAST LINE RAILROAD STATION IN SARASOTA, 0.4 MILE W OF HIGHWAY BRIDGE 30, AND 0.65 MILE E OF U.S.C. AND G.S. TRIANGULATION STATION GOODRICH 1934. IT IS 16 FEET S OF THE CENTER LINE OF THE HIGHWAY, 9 FEET S OF THE EDGE OF THE HIGHWAY, AND 27-1/2 FEET N OF A FENCE LINE. IT IS STAMPED F 11 1944 AND IS ABOUT 4 INCHES BELOW THE SURFACE OF THE GROUND.

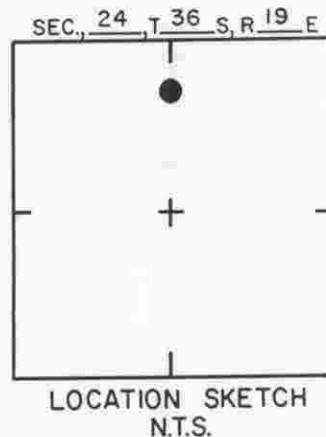
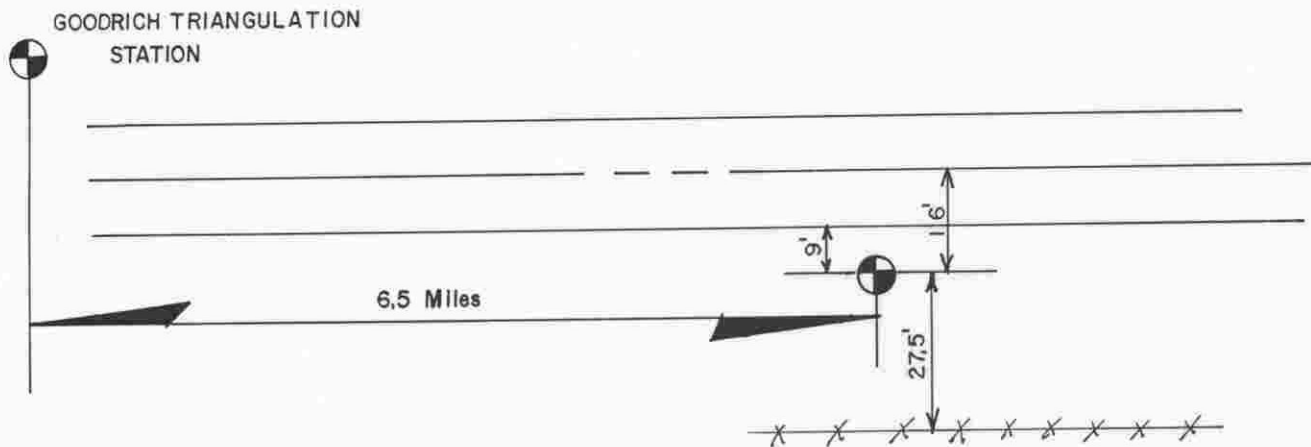
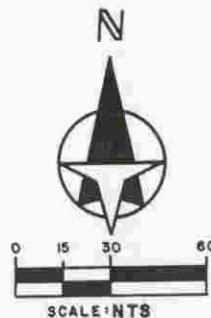

SARASOTA COUNTY
 TRANSPORTATION DEPARTMENT
 ENGINEERING DIVISION

**BENCH MARK
 DATA SHEET**

ELEV.

39.4'

BM. NO.

2250

DATE DRAWN: MAY 1987 BY: RJJ

REF: NOS F11 DATE 7/80

ELEV. BASED ON BM. NO.

DATE	TYPE	FB. PG.	BY
REVISIONS			