

TO REACH THE MARK FROM NE COR SEC 1;  
 GO WEST ± 0.25 MILES TO TBM TBM IS  
 GO D NAIL IN EAST FACE GATE POST.

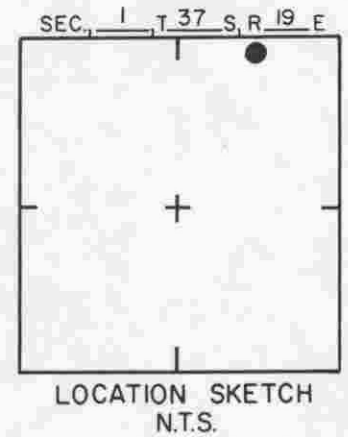
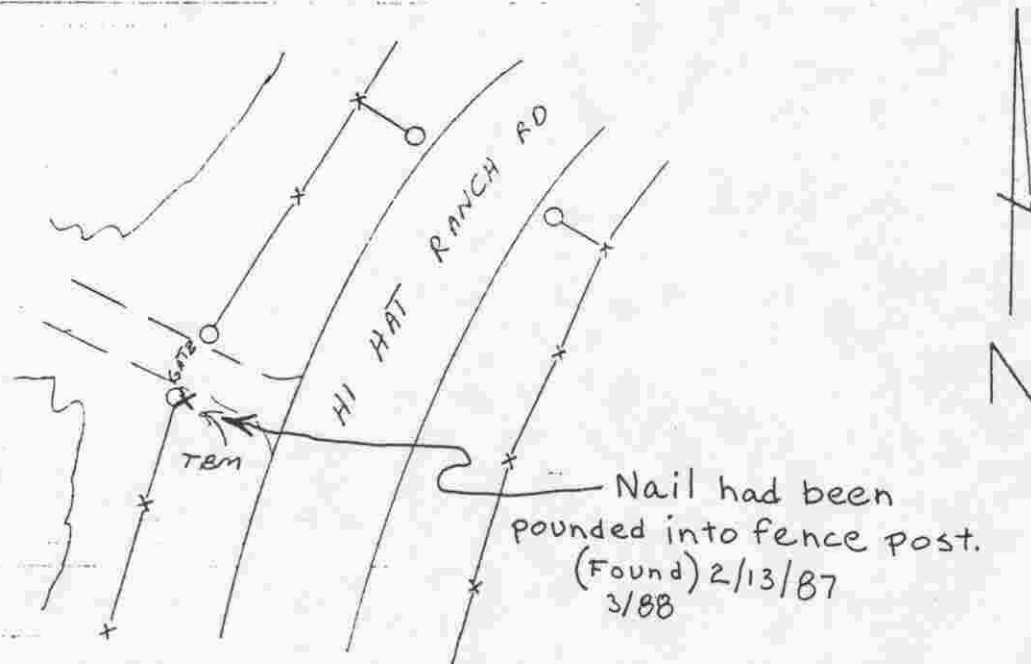
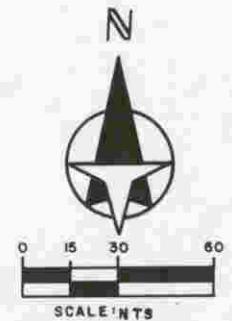

SARASOTA COUNTY TRANSPORTATION DEPARTMENT ENGINEERING DIVISION			
BENCH MARK DATA SHEET			ELEV. 38,856'
DATE DRAWN: 3-10-87		BY: RJJ	
REF: SWFWMD GWL 173 DATE 12/80			BM. NO. 251
REVISIONS			
ELEV. BASED ON B.M. NO. NOS			

4/88 Adjusted Elev. from 38.93 to 38.856 RJJ