

TO REACH THE MARK FROM THE INTERS HAWKINS RD & IBIS AVE, GO
 ± 3.20 MILES S. TO STA; ON THE RIGHT. STA. IS A RE-BAR
 SET FLUSH WITH GROUND.

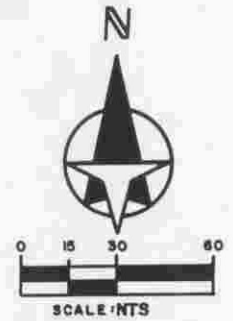

- 1 = 47.3'
- 2 = 28.1'
- 3 = 36.3'
- 4 = 148.3'

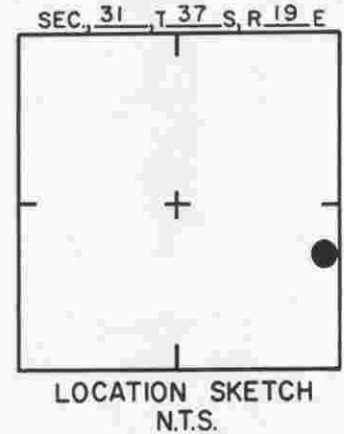
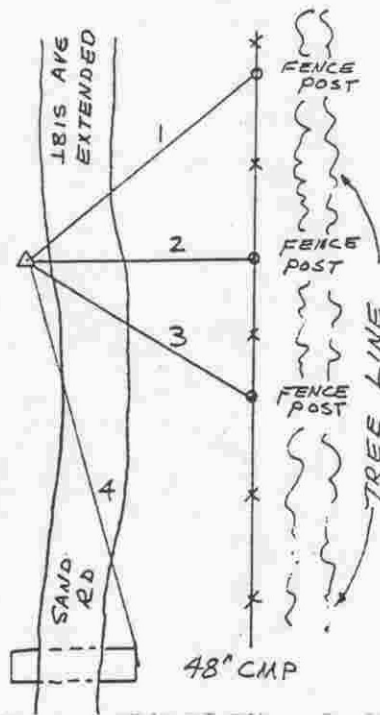

SARASOTA COUNTY TRANSPORTATION DEPARTMENT ENGINEERING DIVISION			
BENCH MARK DATA SHEET			ELEV. 18.46
DATE DRAWN: 2-6-87		BY: RJJ	
REF: SWFWMD GWL-16			DATE 10/80
ELEV. BASED ON B.M. NO. DOT			312

DATE	TYPE	FB. PG.	BY
REVISIONS			

TO REACH THE MARK FROM THE INTERS HAWKINS RD & LBIS AVE
 GO ± 3.35 MILES S. TO STA ON THE RIGHT. STA IS A
 RE-BAR SET FLUSH WITH GROUND.

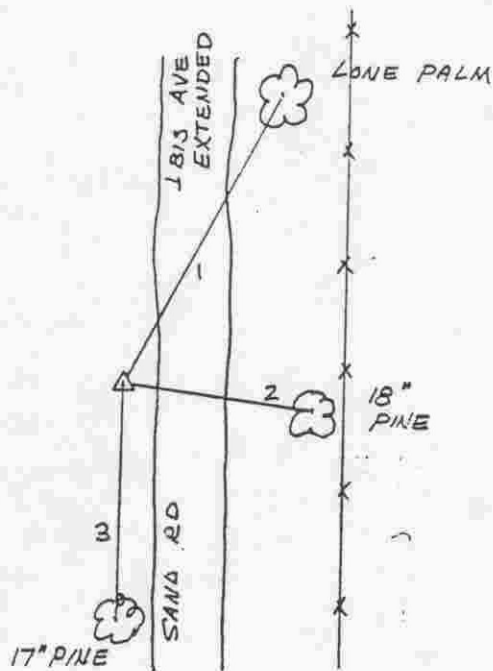
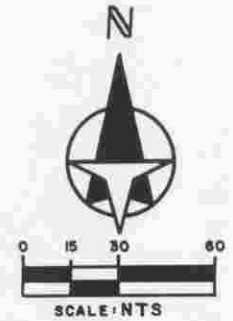

- 1 = 78.9'
- 2 = 17.6'
- 3 = 34.5'

SEC. 31 T. 37 S. R. 19 E

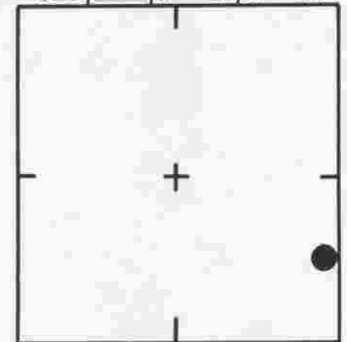

LOCATION SKETCH
N.T.S.

SARASOTA COUNTY
 TRANSPORTATION DEPARTMENT
 ENGINEERING DIVISION

**BENCH MARK
 DATA SHEET**

ELEV.

18.11'

BM. NO.

312A

DATE DRAWN: 2-6-87

BY: RJJ

REF: SWFWMD GWL-17

DATE 10/80

ELEV. BASED ON BM. NO. DOT

DATE	TYPE	FB. PG.	BY
------	------	---------	----

REVISIONS

TO REACH THE MARK FROM NEAR SOUTH 1/4 COR SEC 31;
 TBM IS 60 D NAIL IN SE FACE 15" PINE

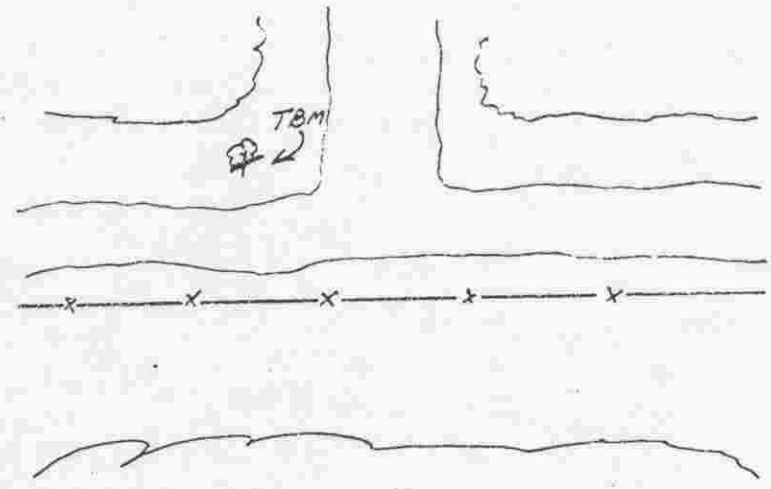
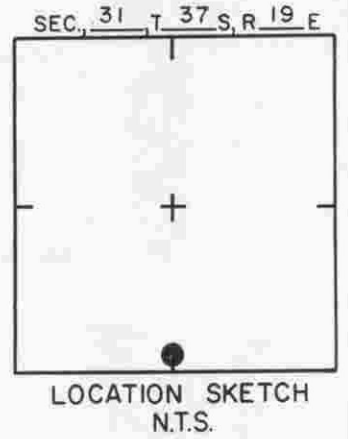
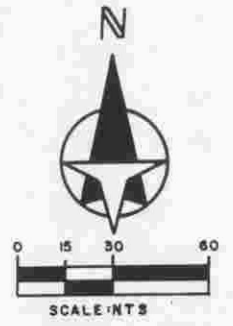

SARASOTA COUNTY TRANSPORTATION DEPARTMENT ENGINEERING DIVISION			
BENCH MARK DATA SHEET			ELEV. 19.69
DATE DRAWN: 3-10-87		BY: RJJ	
REF: SWFWMD GWL 181			DATE 12/80
ELEV. BASED ON B.M. NO. NOS			BM. NO. 312 B

DATE	TYPE	FB. PG.	BY
REVISIONS			