

**SARASOTA COUNTY**  
 TRANSPORTATION DEPARTMENT  
 ENGINEERING DIVISION

4/88 ELEV. ADJUSTED FROM 26,55' TO 26,514' RJJ FB 265 PG 57				<b>BENCH MARK                  DATA SHEET</b>		ELEV.
						26,514'
				DATE DRAWN: 9/85	BY: PJB	BM. NO.
				REF: FB. 259	PG. 35	DATE 8-22-85
<b>REVISIONS</b>				ELEV. BASED ON B.M. <del>408</del> 408 B		408

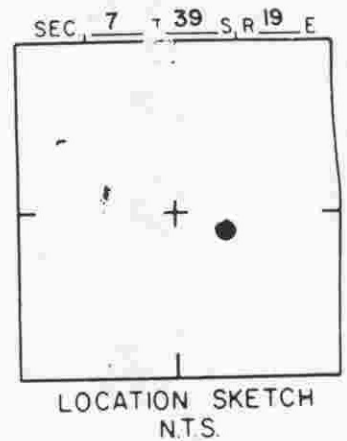
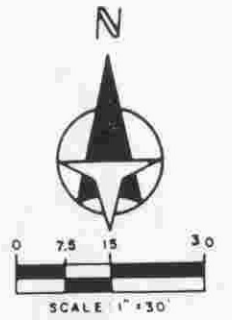
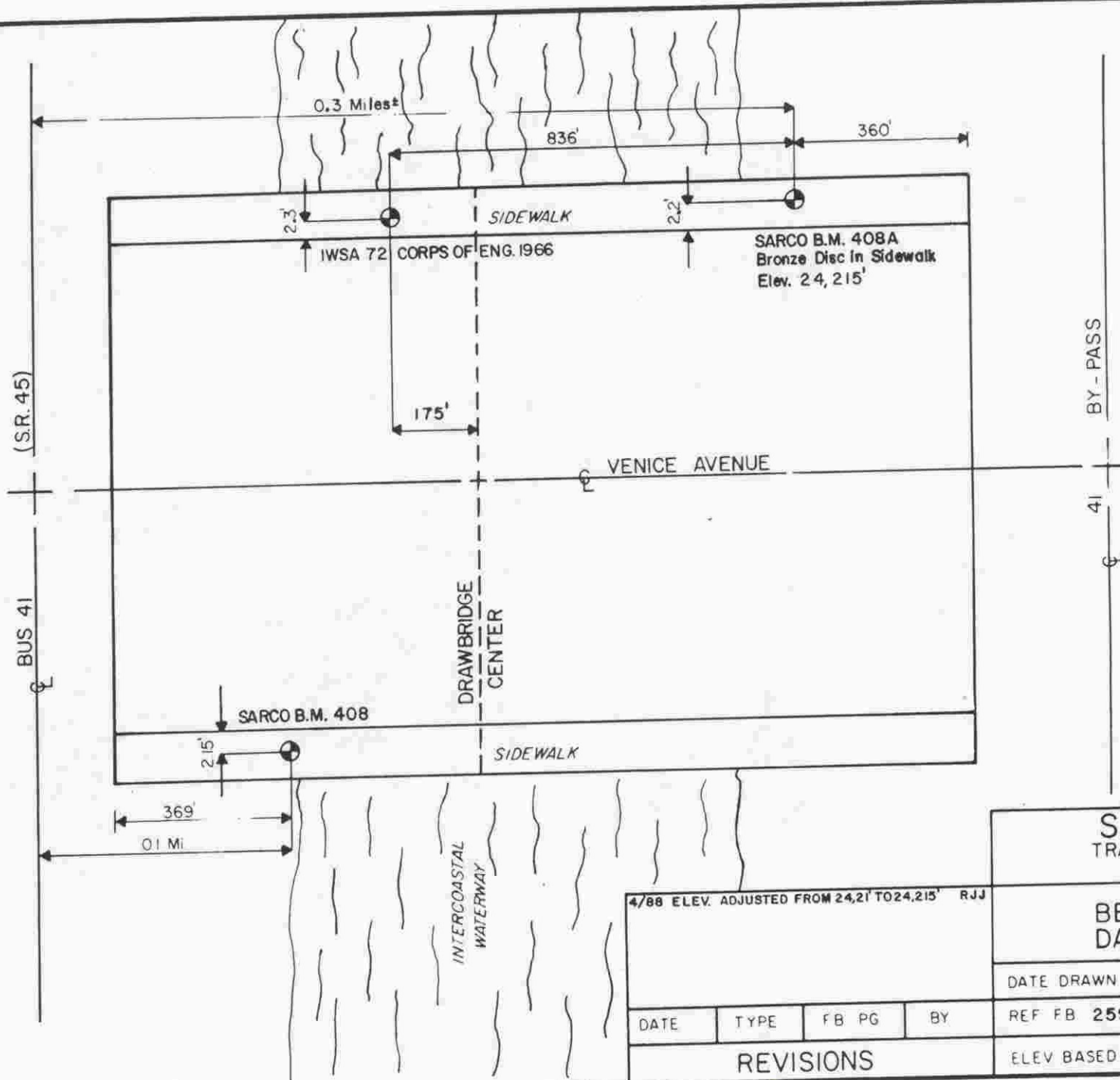

**SARASOTA COUNTY**  
TRANSPORTATION DEPARTMENT  
ENGINEERING DIVISION

4/88 ELEV. ADJUSTED FROM 24,21' TO 24,215' RJJ

**BENCH MARK  
DATA SHEET**

ELEV  
24,215'  
BM NO  
408A

DATE DRAWN 9/85 BY PJB

REF FB 259 PG 35 DATE 8-22-85

ELEV BASED ON BM D.O.T.

DATE	TYPE	FB	PG	BY

**REVISIONS**

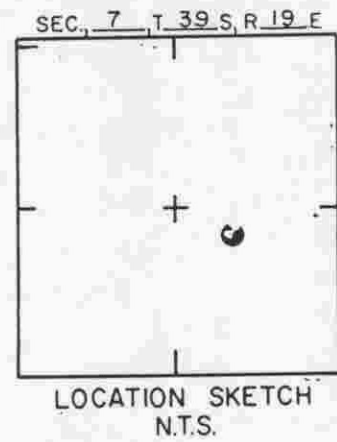
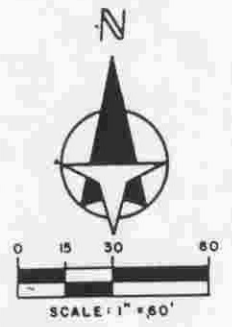
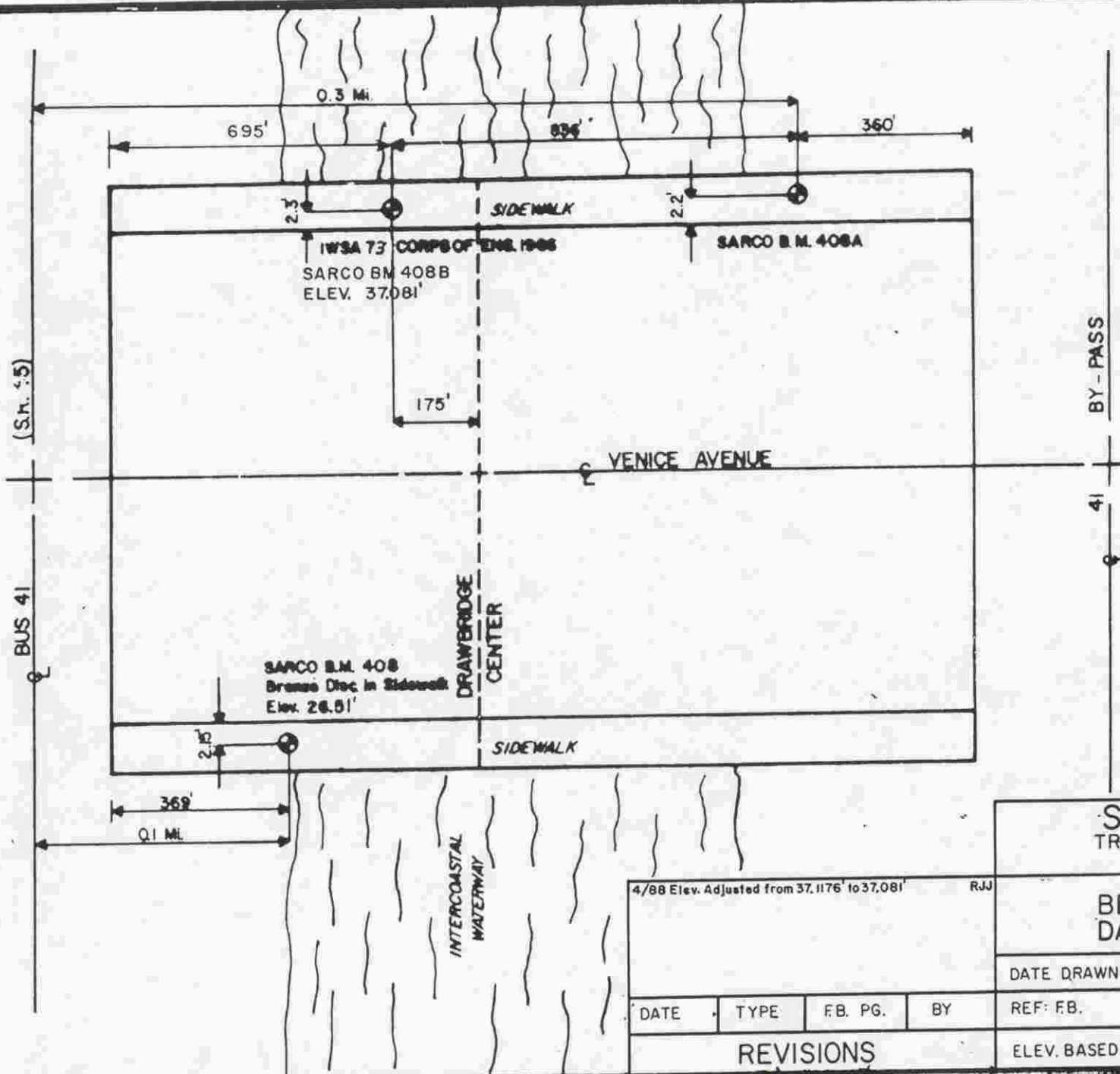

**SARASOTA COUNTY**  
 TRANSPORTATION DEPARTMENT  
 ENGINEERING DIVISION

**BENCH MARK  
 DATA SHEET**

4/88 Elev. Adjusted from 37.1176' to 37.081'				RJJ	ELEV.
					37.081'
DATE DRAWN: 3-3-87				BY: RJJ	BM. NO.
DATE	TYPE	FB. PG.	BY	REF: FB.	PG. DATE
REVISIONS					408B
ELEV. BASED ON B.M. NO. <del>DOT</del>					

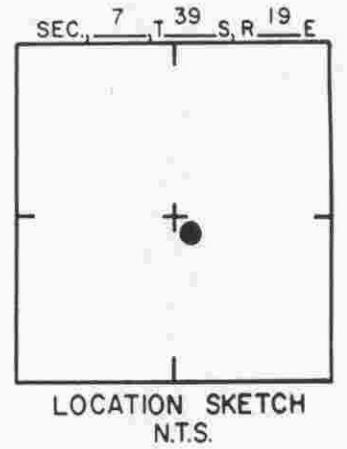
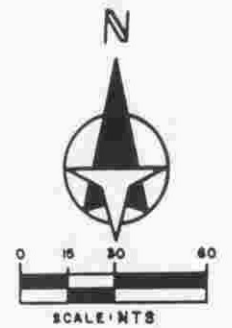
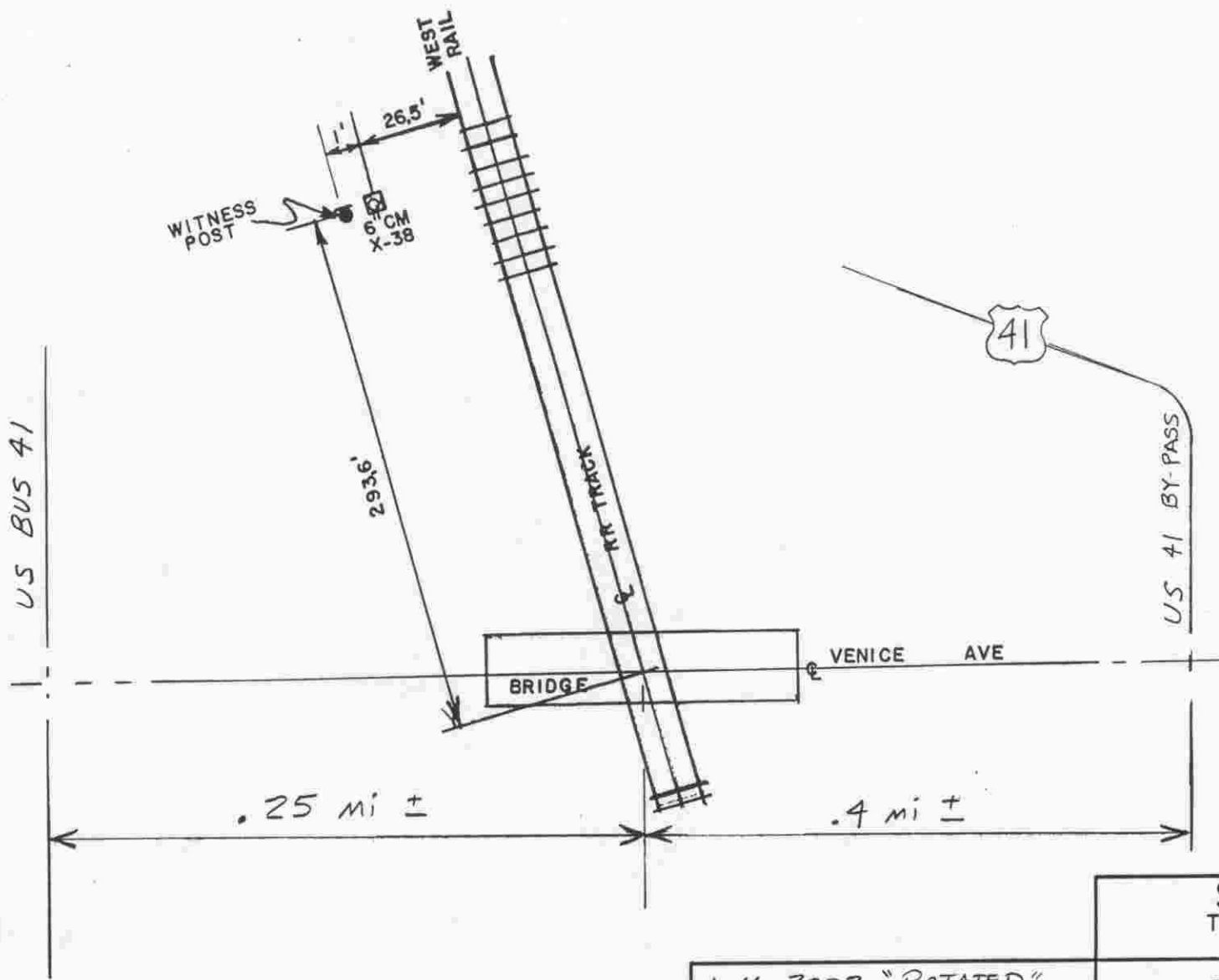

<b>SARASOTA COUNTY</b> TRANSPORTATION DEPARTMENT ENGINEERING DIVISION			
<b>BENCH MARK DATA SHEET</b>			ELEV. 7,756'
DATE DRAWN: 2-5-87		BY: RJJ	BM. NO.
REF: FB, 259	PG 42	DATE 2-5-87	408C
ELEV. BASED ON BM. NO. NOS			

1-16-2003 "ROTATED"  
BY: J. LAWHORN

DATE	TYPE	FB. PG.	BY
<b>REVISIONS</b>			