

Elev. 16.348'

DESCRIPTION OF BENCH MARK F.B. 259/19

Designation D 252 State Florida County Sarasota  
 Nearest town Venice County Sarasota Chief of party R. Gerrish  
 Distance and direction from nearest town 2.3 miles southeast Leveling date 1/66  
 Character of mark A C&GS Bench Mark Disk Stamping D 252 1965  
 Established by C&GS

Detailed description 2.3 miles southeast along U. S. Highway 41 from the intersection of Venice Avenue at Venice, about 0.35 mile southeast of the southeast end of large concrete bridge presently under construction for the Venice by-pass, near the junction of Butler Road leading southwest, 250 feet southwest of the center line of the highway, 31.5 feet northwest of the center line of the road, 26.3 feet south of the south corner of the Palmer Animal Clinic, 3 1/2 feet northeast of a power pole, 1.5 feet southeast of a metal witness post, about level with Butler Road and set in the top of a concrete post projecting 0.3 foot.

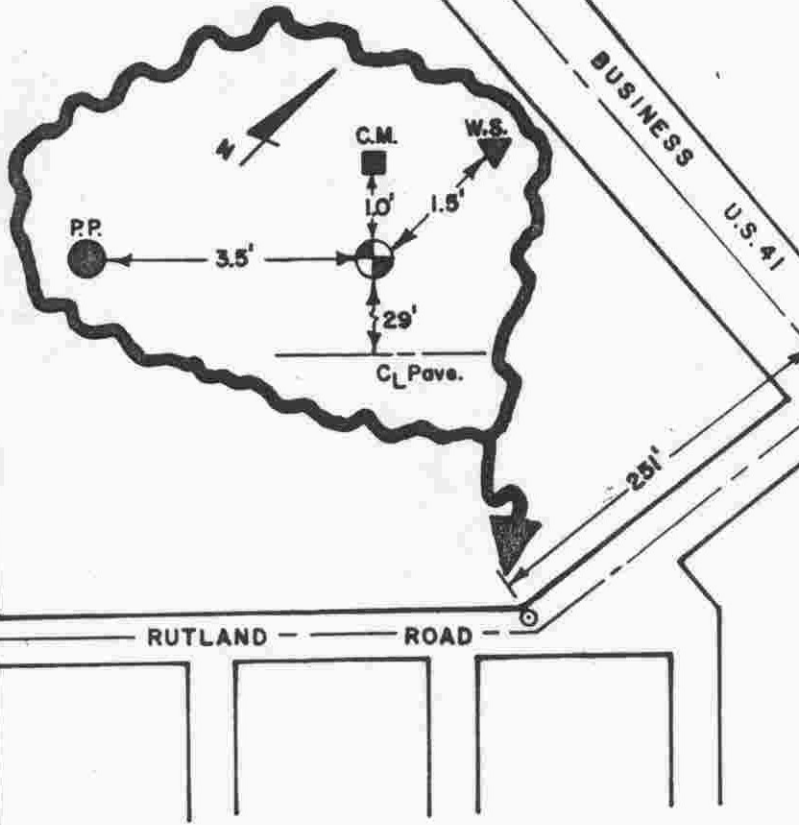

SEC. 20, T. 39 S, R. 19 E

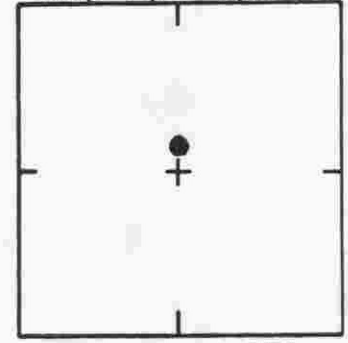

LOCATION SKETCH N.T.S.

SARASOTA COUNTY  
 TRANSPORTATION DEPARTMENT  
 ENGINEERING DIVISION

BENCH MARK  
 DATA SHEET

ELEV.

16.348

BM. NO.

433

DATE DRAWN: 8-22-83 BY: DBP

REF: F.B. 259 PG. 19 DATE: 6-22-83

ELEV. EST. BY U.S.C. & G.S. - 1965

DATE	TYPE	F.B. PG.	BY
REVISIONS			



6  
DRIVE  
0'

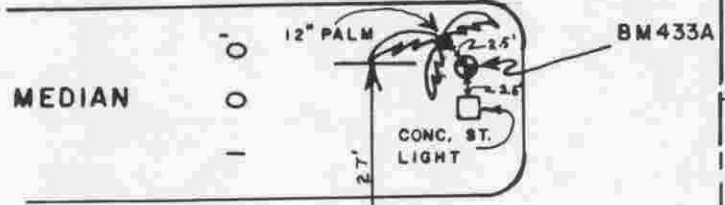

SHAMROCK BLVD. 0' 8

6  
BANYAN  
0'

SEC. 20 T. 39 S. R. 19 E

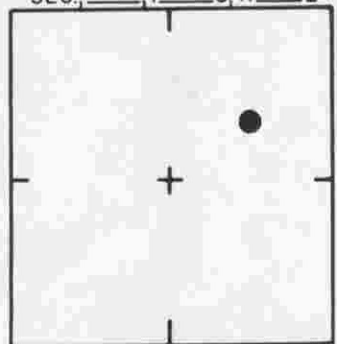

NOTE: BM IS S.A.R.C.O. BRASS DISC ON CONC. MONUMENT.

**SARASOTA COUNTY**  
TRANSPORTATION DEPARTMENT  
ENGINEERING DIVISION

**BENCH MARK  
DATA SHEET**

ELEV.

17.49

BM. NO.

433 A

5-15-98 E/O MLS

DATE DRAWN: 2-21-90 BY: RJJ

DATE	TYPE	FB. PG.	BY

REF: FB. 318 PG. 6-8 DATE 2-14-90

REVISIONS

ELEV. BASED ON B.M. NO. 434