

NOTES: D.O.T. Sec.No. 17050-3107, B.M. 12  
See R.P.B. 1 / 83A, 83G

**SARASOTA COUNTY**  
TRANSPORTATION DEPARTMENT  
ENGINEERING DIVISION

**BENCH MARK  
DATA SHEET**

				DATE DRAWN: 8-16-83		BY: DBP		ELEV.
				REF: FB. 274		PG. 8		11.78
				DATE: 8-12-83				BM. NO.
				ELEV. EST. BY D.O.T.				477A
<b>REVISIONS</b>								
DATE	TYPE	FB. PG.	BY					

↑ Shane Rd. 300' +/-

Fire Hydrant

Conc. P.P. #27N14

SARCO alum. BM disk Stamped "477-E"

Witness Sign

Alum. Light Pole

SCALE: N.T.S.

SEC., 10 ,T 40 S,R 19 E

LOCATION SKETCH N.T.S.

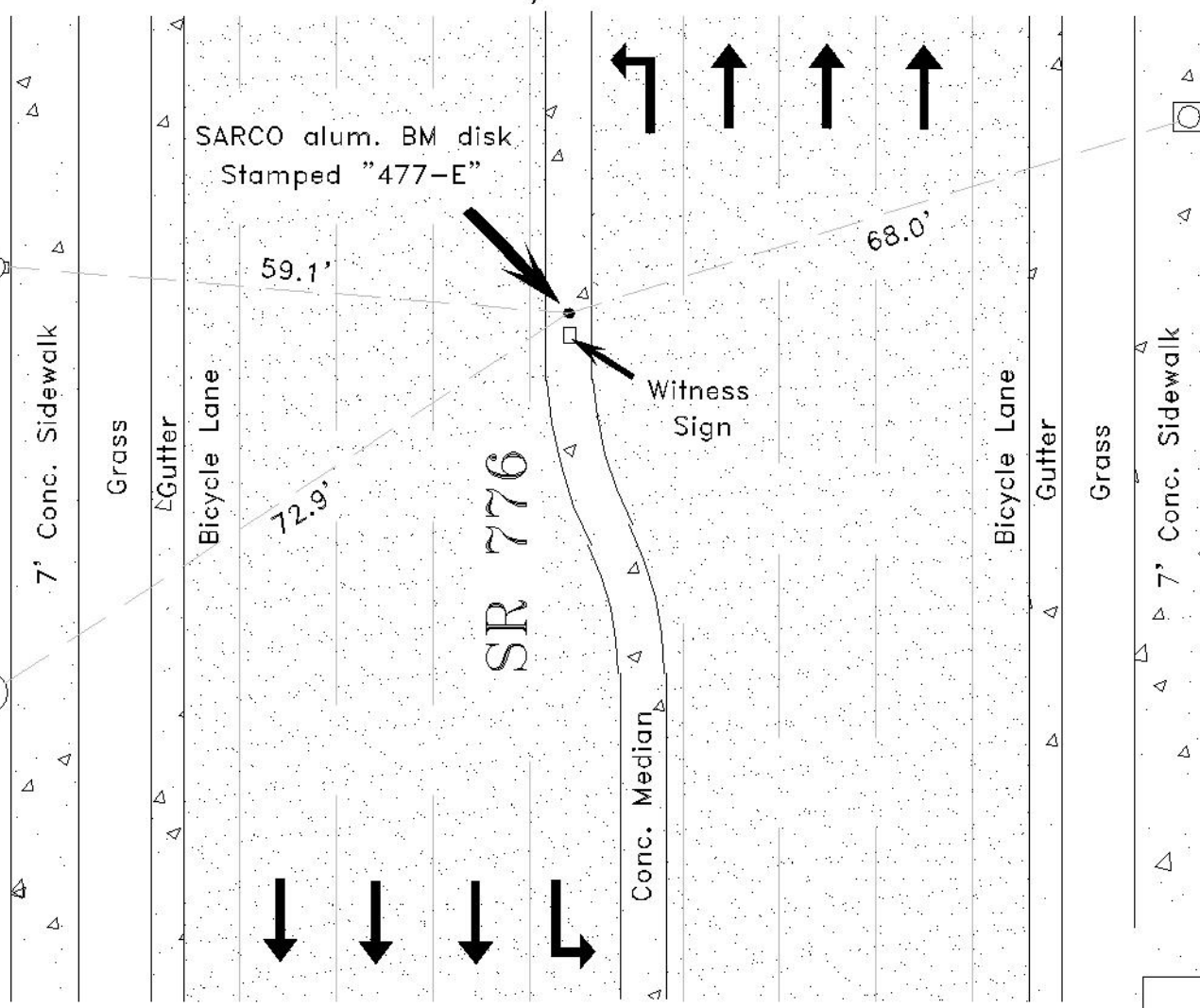

Donovan Rd. 250' +/-



**SARASOTA COUNTY**

Geomatics Service Center  
SURVEY/MAPPING SECTION

REVISIONS / REMARKS	
SET BY:	SARCO 561

BENCH MARK DATA SHEET		ELEV.
DATE DRAWN: 8/18/03 BY: ND		14.046'
REF.: DL-1 PG. 69 DATE: 8/18/03		NGVD 29'
ELEV. BASED ON B.M. NO. SARCO 485-B		B.M. NO.
		477-E