

DATE: 1/24/85
 CONDITION: C.M. with Brass Disk stamped
 BM-6 .3 below natural ground.

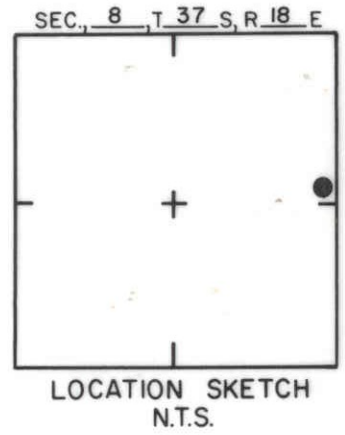
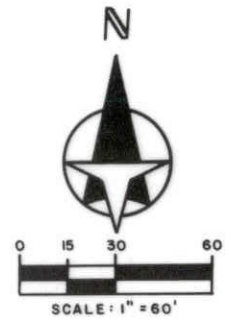

SARASOTA COUNTY
 TRANSPORTATION DEPARTMENT
 ENGINEERING DIVISION

				BENCH MARK DATA SHEET			ELEV.
							22.18'
				DATE DRAWN: 12-18-84		BY: R J	BM. NO.
DATE	TYPE	F.B. PG.	BY	REF: F.B.	PG.	DATE	85 A
REVISIONS				ELEV. BASED ON B.M. NO. D.O.T.			

PROCTOR ROAD

GRASS

SIDEWALK

NORTH WING

GRASS

SIDEWALK

RIVER VIEW
HIGH SCHOOL
MAIN OFFICE

COVERED WALKWAY

LORDS AVENUE

SOUTH WING

GRASS

SIDEWALK

T.B.M. SQ CUT ON
END OF COVERED WALKWAY.
ELEV. 20.716'

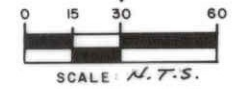

SEC. 8 T. 37 S. R. 18 E

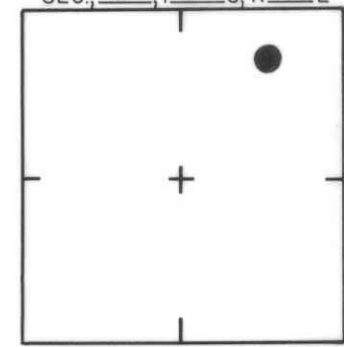

LOCATION SKETCH
N.T.S.

SARASOTA COUNTY
TRANSPORTATION DEPARTMENT
ENGINEERING DIVISION

**BENCH MARK
DATA SHEET**

ELEV.

20.716'

BM. NO.

85-B

DATE DRAWN: 8-7-90 BY: KLP

REF: F.B. 319 PG. 32 DATE 7/90

ELEV. BASED ON B.M. NO. 85-C

DATE	TYPE	F.B. PG.	BY
REVISIONS			

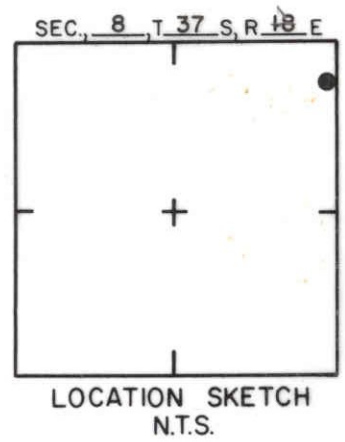
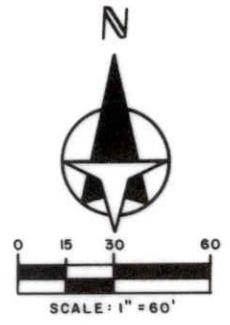
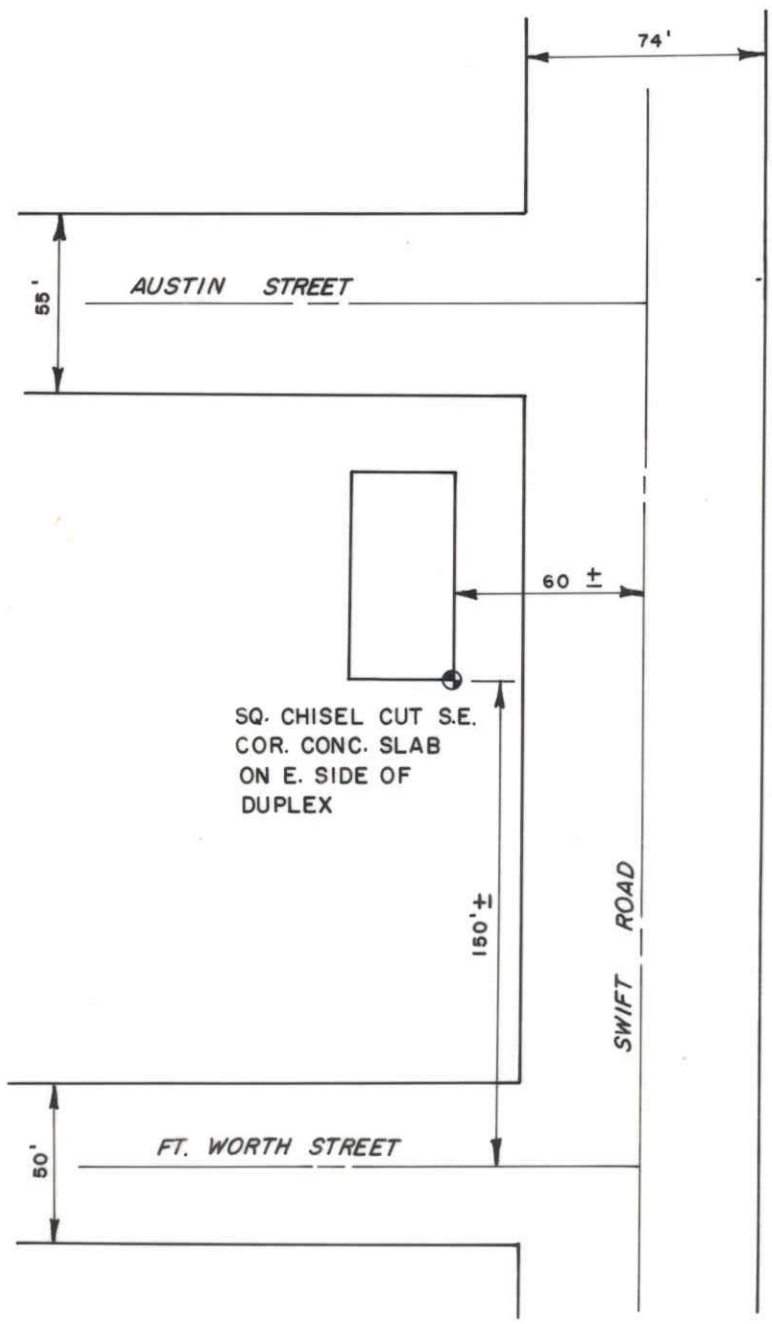

SARASOTA COUNTY
TRANSPORTATION DEPARTMENT
ENGINEERING DIVISION

DATE: 1-24-85 COND.: GOOD CHECKED 7-16-85				BENCH MARK DATA SHEET		ELEV.
						26.66'
				DATE DRAWN: 12-18-84	BY: RJ	BM. NO.
DATE	TYPE	F.B. PG.	BY	REF: F.B.	PG.	DATE
REVISIONS				ELEV. BASED ON B.M. NO.		85 C