

SARASOTA COUNTY
 TRANSPORTATION DEPARTMENT
 ENGINEERING DIVISION

| | | | | | | |
|-----------|------|----------|----|-------------------------------|-------------|------------------------------------|
| | | | | BENCH MARK DATA SHEET | | ELEV. |
| | | | | | | 29.38 |
| | | | | DATE DRAWN: JUNE 1983 BY: DBP | | BM. NO. |
| | | | | 89 | | |
| DATE | TYPE | F.B. PG. | BY | REF: F.B. 253 PG. 79 | DATE 2-1-83 | ELEV. BASED ON B.M. NO. SARCO R-71 |
| REVISIONS | | | | | | |

SAWYER ROAD

N. LINE OF SEC. 10-37-18

EAST

2684.63'

671.46'

167.50'

163.59'

EAST

331.09'

N.W. CORNER OF THE N.E. 1/4 OF SEC. 10-37-18 SARCO REF: SHT. NO. 201, D.N.R. DOC. NO. 13844

26' ADDITIONAL R/W DEDICATED BY THIS PLAT EAST 117.64'

EAST 113.43'

OFFSET P.R.M. NO. 1821

DRAINAGE ESM'T. (PRIVATE) 300'-11'-40" ENR 63.00'

RK AND DISC IN OAK TREE BASE
DRAINAGE EASEMENT (PRIVATE)
BENCH MARK TOP OF C.M. ELEV. = 33.76

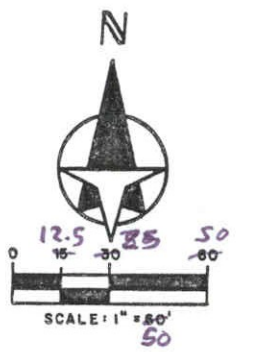

SEC. 10 T. 37 S. R. 18 E

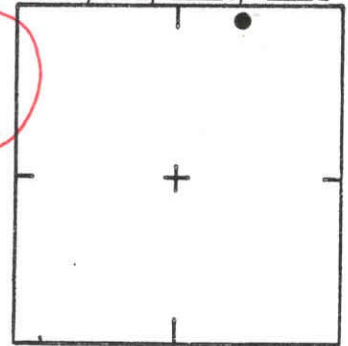

LOCATION SKETCH N.T.S.

7

169.78'

WEST

142.67'

8

10' WIDE PUBLIC DRAINAGE EASEMENT

144.86'

COURT

144.78'

501.31'

WEST

144.69'

EAST

158.30'

WEST

142.80'

SARASOTA COUNTY
TRANSPORTATION DEPARTMENT
ENGINEERING DIVISION

BENCH MARK
DATA SHEET

ELEV.

33.76

DATE DRAWN: 6-09-86 BY: PJB

BM. NO.

| | | | | | | |
|------|------|---------|----|-------------|--------|--------------|
| DATE | TYPE | FB. PG. | BY | REF: PB. 31 | PG. 11 | DATE 3-12-86 |
|------|------|---------|----|-------------|--------|--------------|

REVISIONS

ELEV. BASED ON B.M. NO. SARCO. 69

89 D

TO REACH THE MARK FROM INTER. BENEVA RD. & EGERTON CIR.
 TBM IS A CUT SQ. ON CURB OPP. P-POLE

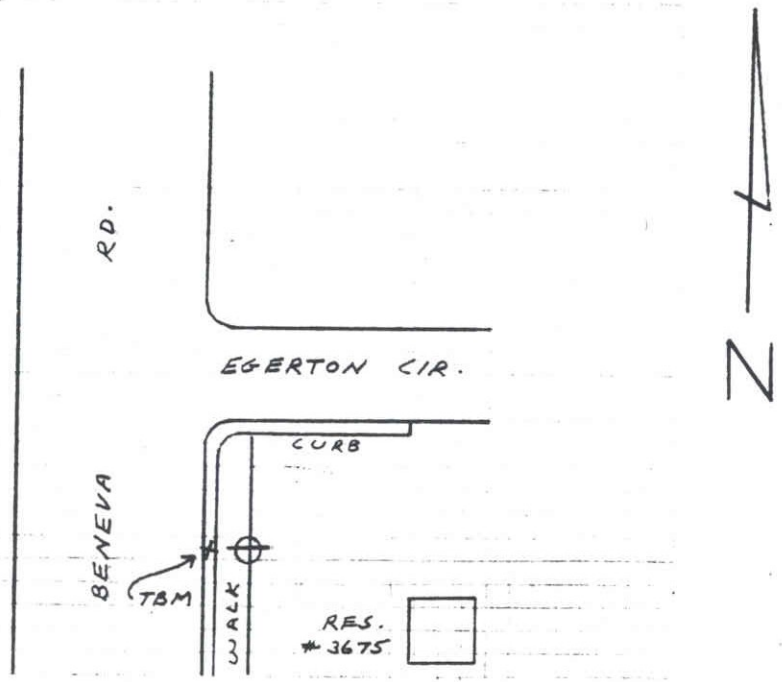
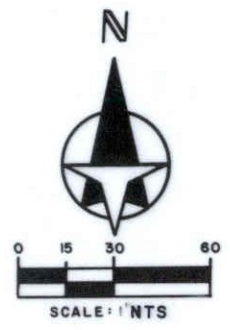

SARASOTA COUNTY
 TRANSPORTATION DEPARTMENT
 ENGINEERING DIVISION

| | | |
|--------------------------------|--|---------|
| BENCH MARK DATA SHEET | | ELEV. |
| | | 25.31' |
| DATE DRAWN: 11-22-87 BY: RJJ | | BM. NO. |
| REF: SWFWMD HFH 109 DATE 10/81 | | 89 E |
| ELEV. BASED ON B.M. NO. NOS | | |

| DATE | TYPE | FB. PG. | BY |
|-----------|------|---------|----|
| REVISIONS | | | |

TO REACH THE MARK FROM AT INTER SAWYER RD & ASHTON RD
TBM IS CHISELED CROSS ON SW COR CONC
HEADWALL

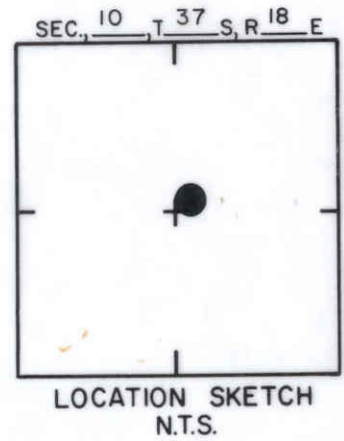
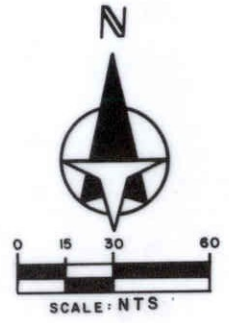
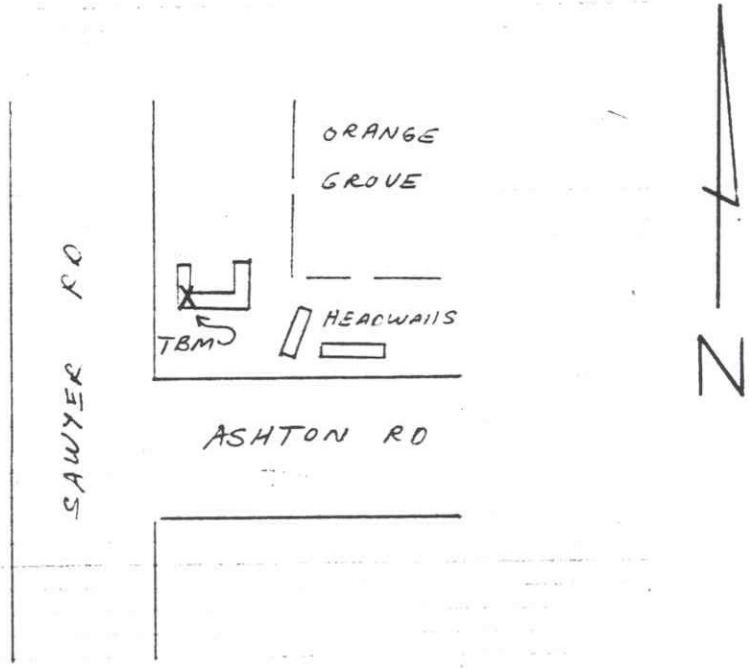

SARASOTA COUNTY
 TRANSPORTATION DEPARTMENT
 ENGINEERING DIVISION

| | | | | | | |
|------------------|--|--|--|------------------------------|-----------|---------|
| | | | | BENCH MARK DATA SHEET | | ELEV. |
| | | | | | | 33,99 |
| | | | | DATE DRAWN: 1-22-87 | BY: RJJ | BM. NO. |
| | | | | REF: SWFWMD HFH 112 | DATE 9/81 | 89F |
| REVISIONS | | | | ELEV. BASED ON B.M. NO. NOS | | |