

S 1/2 28-37-18 SHT. NO. 126

CO. SEC. COR. MON. SHT. NO. 182

N 1/2 32-37-18 SHT. NO. 129

N 1/2 33-37-18 SHT. NO. 132

S 1/2 33-37-18 SHT. NO. 131

CO. SEC. COR. MON. SHT. NO. 183

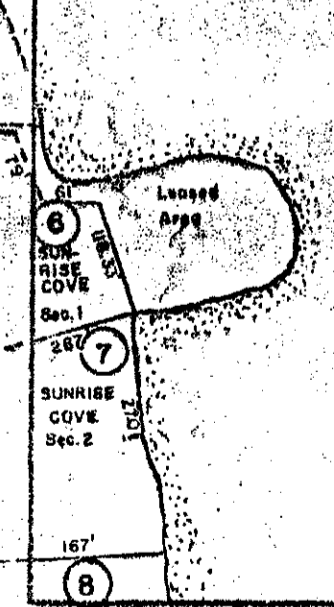
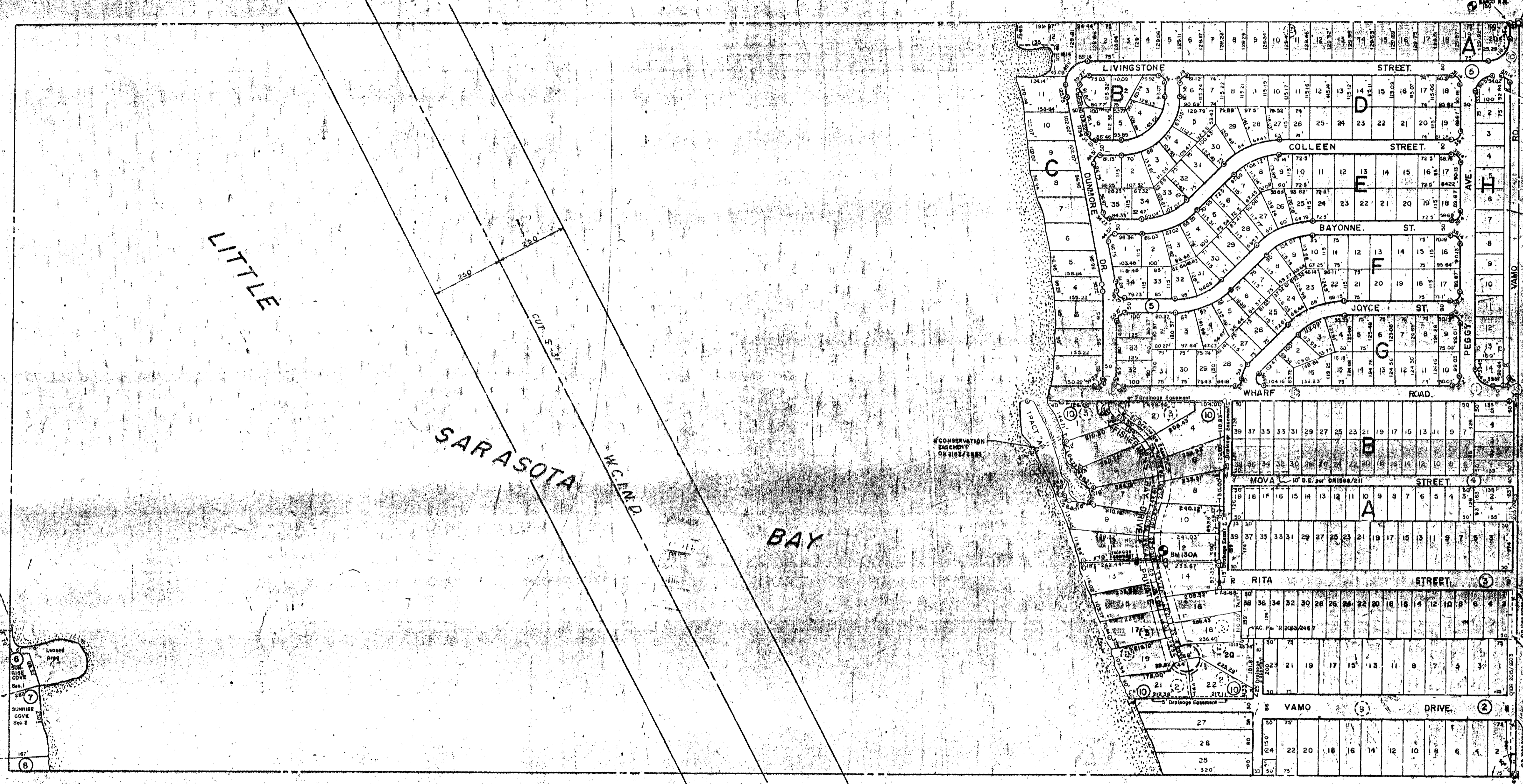

SUBDIVISION INDEX

No.	Name	Date
1.	BAYONNE PARK REVISED	5/10 (RESUB. NO. 5)
2.	AMENGED PLAT OF VAMC	1/36
3.	1st ADDITION TO VAMO	1/50
4.	2nd ADDITION TO VAMO	1/55
5.	TROPICAL SHORES	9/30 B
6.	SUNRISE COVE	SEC. 1, C.B. 6, R. 32
7.	"	" 2, C.B. 6, R. 32
8.	"	" 3, C.B. 7/35
9.	VAMO	1/32
10.	FISHERMEN'S BAY	32/25-25B

LEGEND:

- ⊙ Bench Mark (R-restored)
- ⊠ Section Corner Monument (NEW/NO. 5)
- ⊙ Permanent Reference Monument
- ⊙ Reference Point for Subdivision
- ⊙ Subdivision Index Number
- ⊕ Drainage

DATE	DESCRIPTION
FEB 1961	VACATION PER O.R. 8270/1734
MAR 1959	ADDED CONSERVATION EASEMENTS ON 3182/2883
MAY 1962	MEDIAN
MAY 1962	W.C. J. N.D. ADDED
MAY 1962	CORRECTED
MAR 1972	SUNRISE COVE
MAY 1962	CONSERVATION EASEMENT ON
MAY 1962	ON 1884/1071, 1884/1074, 1884/1077
MAR 1960	BY O.C. 10/11/1957
MAY 1962	ADDED BENCH MARK ON
MAY 1962	ADDED BENCH MARK ON
MAY 1962	ADDED BENCH MARK ON

SARASOTA COUNTY FLORIDA
SCALE: 1" = 200'
JULY 1964

N 1/2 SECTION 33
TWP 37 S. RNG 18 E

SHT. NO.
130

