

N 1/2 10-38-18 SHT. NO. 147

SEC. COR. 245

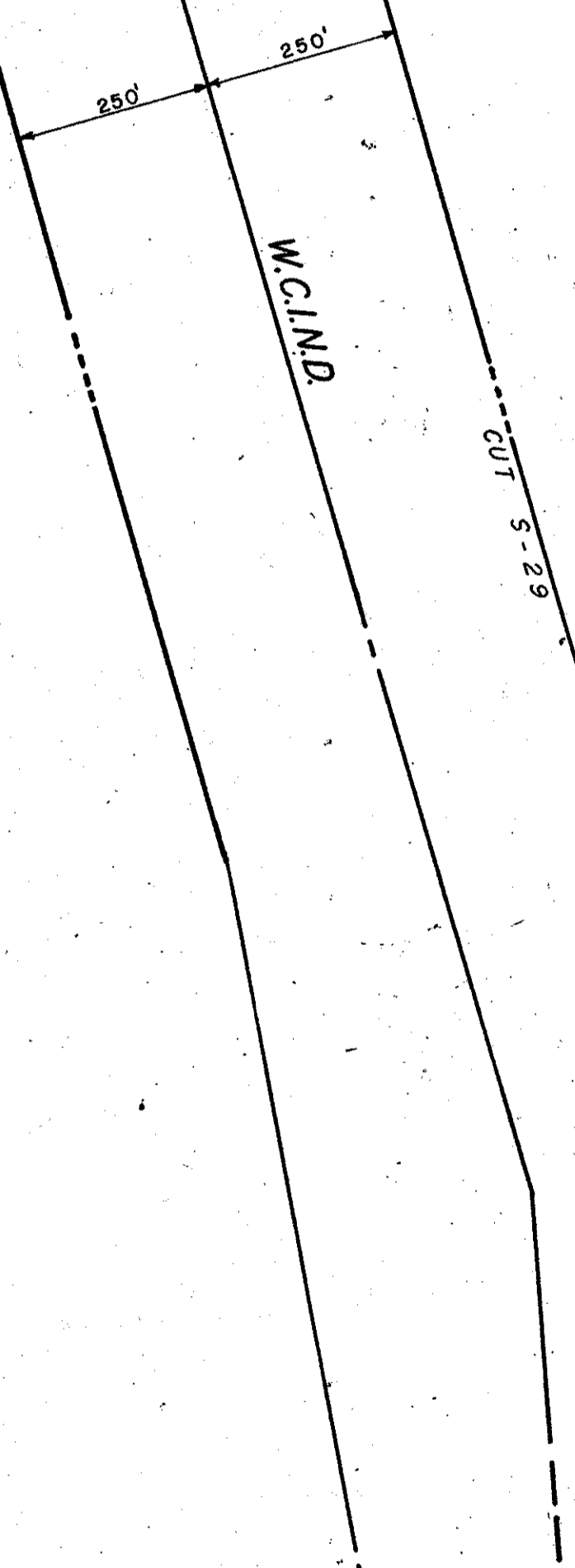
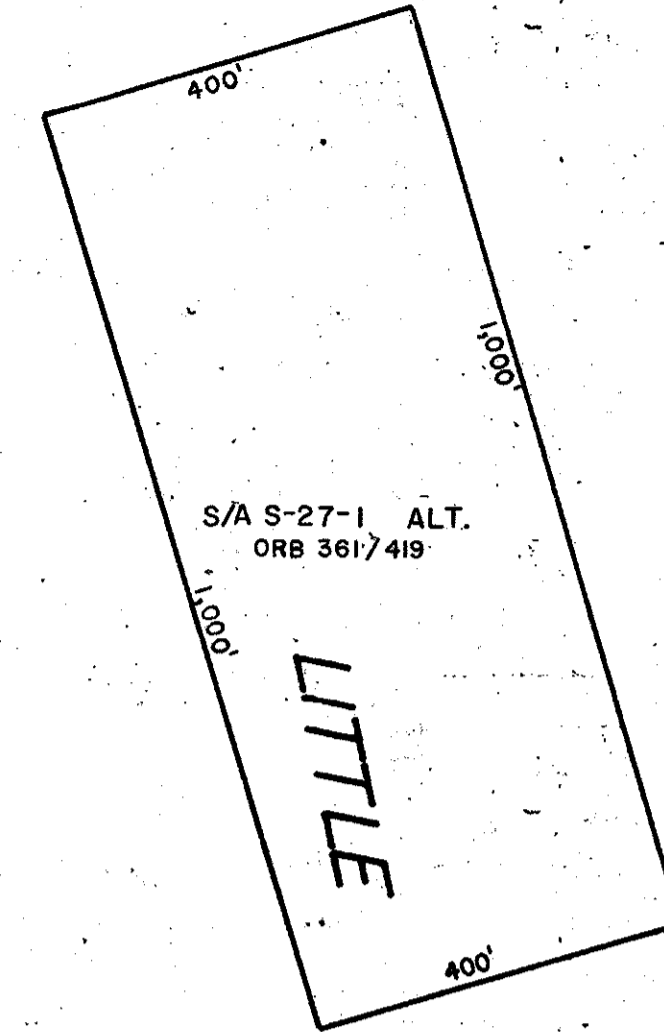

N 1/2 15-38-18 SHT. NO. 157

**SUBDIVISION INDEX**

| No. | Name                            |
|-----|---------------------------------|
| 1   | SARABAY ACRES 4/62              |
| 2   | BAY ACRES SUB. 5/99 (REPLATED)  |
| 3   | BAY ACRES RE-SUB. 7/16 & 16A.   |
| 4   | HARMS SUBDIVISION 25/40,40A     |
|     | HERON BAY CLUB CONDO, C.B.16/27 |

- LEGEND**
- PERM. REF MON (for Subs)
  - CONC. MON
  - IRON PIPE
  - CO. SEC. COR. MON. (NEW NUMBERS)

| DATE     | DESCRIPTION                          | BY  |
|----------|--------------------------------------|-----|
| OCT 1992 | CORRECTED M/W Per 333-330            | KJM |
| MAY 1990 | ADDED SPILL AREA PER 252-1316        | KJM |
| MAY 1988 | ADDED SPILL AREA PER 252-1316        | KJM |
| MAR 1988 | ADDED SPILL AREA PER 252-1316        | KJM |
| OCT 1987 | ADDED BENCH MARKS 148A, 148B         | KJM |
| AUG 1983 | R/W TO STATE, OR 278/32 & OR 280/352 | JNY |
|          |                                      | BAR |

SARASOTA COUNTY FLORIDA.  
SCALE 1" = 200' JULY 1964

S 1/2 SECTION 10  
TWP. 38 S. RNG. 18 E.

SHT. NO.  
148

