

N. 1/2 10-39-20, Sht. No. 739

S. 1/2 9-39-20, Sht. No. 738

S. 1/2 11-39-20, Sht. No. 742

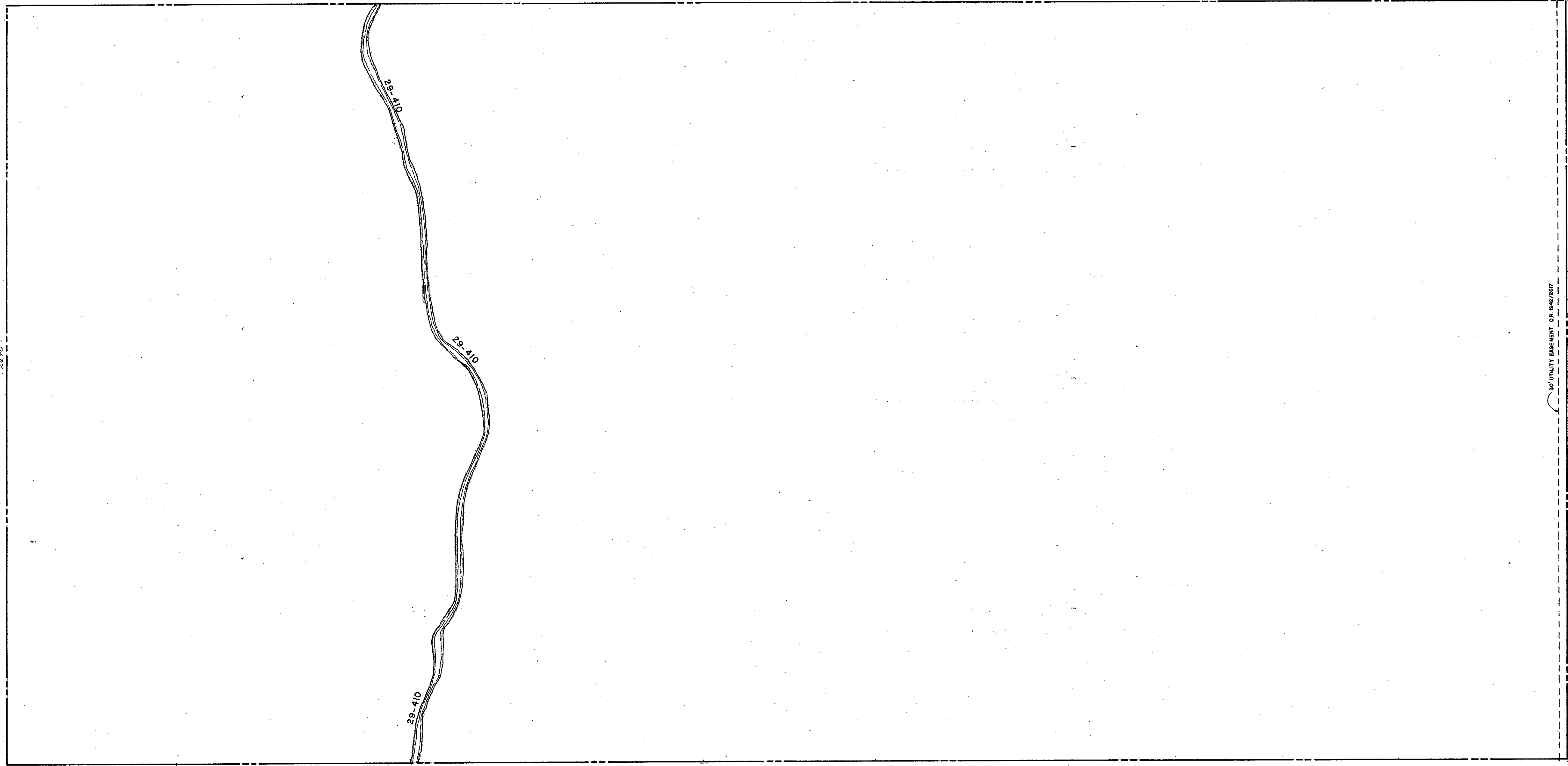

N. 1/2 15-39-20, Sht. No. 749

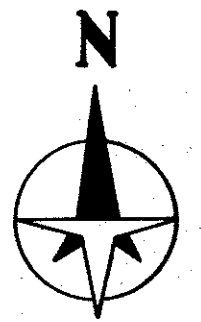

LEGEND:

- ▣ County Section Corner Monument
- ⊕ County Bench Mark
- Permanent Ref. Mon. for Subs.
- ① Subdivision Index Number

REVISIONS	
DATE	DESCRIPTION
JUNE 1987	ADDED 30' UTILITY EASEMENT PER OR 1942/2617
JAN 1988	ADDED DRAINAGE DITCH & NUMBERS

SARASOTA COUNTY, FLORIDA

Scale: 1" = 200' Date: May 1972

Drawn By:

S. 1/2 Section 10
Twp. 39 S. - Rge. 20 E.

Sheet No.

740