

2001 MAR 12 11:51 AM
KAREN E. RUSHING
CLERK OF CIRCUIT COURT
SARASOTA COUNTY, FLORIDA
HARMSTRONG Receipt#022925

✓ Please record and return to Karen Grasset
Growth Management Business Center
1660 Ringling Boulevard, 5th Floor
Sarasota, FL 34236

NOTICE OF STIPULATIONS
AND LIMITATIONS ENCUMBERING
REAL PROPERTY PURSUANT TO
THE SARASOTA COUNTY ZONING CODE

The following property located in Sarasota County, Florida, owned by Donald C. Andrews & S. Alicia Andrews, and described in Resolution No. 2001-018 attached hereto, to allow a House of Worship with a Child Care Center in the OUE-1 (Open Use, Estate, 1 unit/5 acres) zone district, pursuant to Special Exception Petition No 1518 filed by Robert Medred, Agent, and granted by Sarasota County on January 24, 2001, is subject to the following stipulations and limitations, violations of which shall constitute a violation of the Sarasota County Zoning Code:

(Stipulations and limitations are those described in Section B of Resolution No 2001-018, attached hereto)

Executive Director
Growth Management Business Center

STATE OF FLORIDA
COUNTY OF SARASOTA

Before me, the undersigned Notary Public, personally appeared Jerry Gray, Executive Director of the Growth Management Business Center, to me known to be the individual who executed the foregoing Notice of Stipulations and Limitations Encumbering Real Property pursuant to the Sarasota County Zoning Code, and he acknowledged before me that he executed the same.

Witness my hand and official seal at Sarasota County, Florida, this 8th day of March, A.D. 2001.

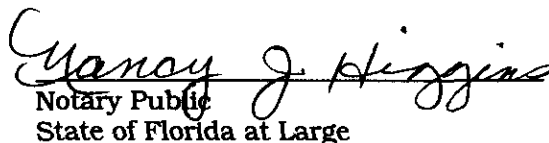
Notary Public
State of Florida at Large

This instrument prepared by:
Nancy Higgins



Nancy J. Higgins
Commission # CC 936530
Expires May 15, 2004
Bonded Through
Atlantic Bonding Co., Inc.



2001031860

RESOLUTION NO. 2001-018
 OF THE BOARD OF COUNTY COMMISSIONERS
 OF SARASOTA COUNTY, FLORIDA
 SPECIAL EXCEPTION NO 1518

WHEREAS, Robert Medred, agent for the owner of the hereinafter described real property has filed Special Exception Petition No 1518 requesting that a special exception be granted to allow the property, located 1,320 feet North of Fruitville Road and 2,558 feet ± East of Sarasota Center Boulevard, Sarasota County, Florida, to be used for a House of Worship with a Child Care Center in the OUE-1 (Open Use, Estate, 1 unit/5 acres) zone district; and

WHEREAS, the Planning Commission of Sarasota County, after due public notice, did hold a public hearing on the 14th day of December, 2000 to consider said Special Exception Petition No 1518, and

WHEREAS, the said Planning Commission did submit and report its findings and recommendations to this Board that said Special Exception Petition No 1518 be granted, and

WHEREAS, this Board, after due public notice, did on the 24th day of January, 2001 hold a public hearing to consider said special exception petition, the recommendation of the Planning Commission and all matters relevant to said petition

NOW, THEREFORE, BE IT RESOLVED by the Board of County Commissioners of Sarasota County, Florida, in public meeting assembled.

A This Board, after having considered the report of the Planning Commission, the testimony of the applicant, evidence entered into the record, public comment on the petition and all things brought to its attention with regard to said Special Exception Petition No 1518 does make the following findings:

(1) The granting of the Special Exception will promote the public health, safety, morals, order, comfort, convenience, appearance, prosperity, or general welfare,

(2) All the requirements of the Sarasota County Zoning Regulations and the Comprehensive Plan for Sarasota County, Florida, have been met and satisfied,

(3) That the requirements of the District Regulations governing this Special Exception have been met; and

(4) The following standards have or have not been met as indicated.

a The proposed use is consistent with the intent, goals, objectives, policies and programs of the Sarasota County comprehensive plan for the area in which the property is located;

b The intensity of the proposed use is consistent with the intended future use of the area in which the property is located, in accordance with the programs of the "Future Land Use Plan",

c The proposed use singularly or in combination with other special exceptions does not change the character of the general vicinity, as shown on the locator map

d The intensity of the proposed use is harmonious with the character of other uses in the general vicinity, as shown on the locator map,

e The height and orientation of the proposed structure(s) or use is compatible with the existing neighboring structures and uses,

f The subject parcel is sufficient and adequate in shape and size to accommodate the proposed use, and would provide for the appropriate separation between neighboring uses,

g The proposed use is adequately screened and buffered to effectively separate traffic, light and noise from the existing or intended abutting uses,

h The loading and refuse areas would not impose negative visual, odor, or noise impacts on abutting uses and thoroughfares,

i The size and location of the proposed sign(s) would conform to the character of existing neighboring uses,

j The exterior lighting would be harmonious with the existing character of existing neighboring uses, in terms of glare,

k The ingress and egress to the subject parcel and the structures involved, if any, would not adversely affect traffic flow, safety and control,

l The access and internal circulation is adequate in case of fire or emergency,

m The proposed use would not cause excessive traffic impacts on the surrounding roadway system,

n The location, type and availability of potable water for the proposed use is compatible with neighboring uses,

o The location, type and availability of the proposed wastewater system is compatible with neighboring uses, and

p The proposed use would not cause or intensify flooding of neighboring uses

B Special Exception Petition No. 1518 is hereby granted for the following described property, said property being in Sarasota County, Florida, to-wit

1,320 feet North of Fruitville Road and 2,558 feet ± East of Sarasota Center Boulevard, more particularly described as follows

Commence at the southwest corner of Section 15, Township 36 South, Range 19 East, thence North 0°03'40" East, 2,699 52 feet to the West ¼ corner of said Section 15, thence North 89°50'52" East along the quarter section line, 484 62 feet, thence South 0°03'40" West, 2,693 82 feet to the South line of said Section 15, thence South 89°10'30" West, 484 62 feet to the Point of Beginning Being and lying in Section 15, Township 36 South, Range 19 East, and containing 30 acres, more or less

and the same is hereby approved for a House of Worship with Child Care Center, subject to the stipulations as set forth below. As used in the stipulations hereinafter set forth, the term "Owner" shall refer to the owner or owners of the property described in Section B and their successors and assigns. Upon recording in the public records of Sarasota County, these stipulations shall be covenants running with the land

- 1 The Owner shall be required to maintain the appearance and function of any private drainage facilities to be constructed on the site, including retention ponds and drainage ditches, at its own expense in accordance with applicable federal, state or local regulations. At the time of recording a plat or prior to final construction approval, the Owner shall be required to record in the public records a Notice to Purchaser, approved by Sarasota County, putting purchasers on notice that the maintenance of drainage facilities is a private responsibility
- 2 Development shall occur in substantial accordance with the Development Concept Plan date-stamped September 1, 2000, attached hereto as Exhibit "A" This does not imply or confer any variances from applicable zoning or land development regulations
3. The wetlands and associated upland vegetative buffers shall be maintained as a preserve and labeled a preserve on all plans All activities involving filling, excavating, removing of vegetation (including trimming of both trees and understory) and storing of materials shall be prohibited within preservation areas, unless written approval is first obtained from Resource Protection Services
- 4 Exterior lighting on the site shall be directed only toward the subject site and away from adjacent properties and streets.
- 5 Refuse areas shall be setback at least 50 feet from the east property line and visually screened in accordance with Section 11.6 of the Sarasota County Zoning Ordinance
- 6 The Applicant shall be required to maintain the elevation of the ingress/egress access to the subject parcel above the 100-year floodplain elevations

C This Resolution shall take effect immediately upon its adoption

PASSED AND DULY ADOPTED this 24th day of January, A D, 2001

BOARD OF COUNTY COMMISSIONERS OF
SARASOTA COUNTY, FLORIDA

By

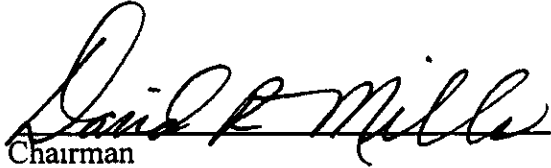
Chairman

ATTEST

KAREN E. RUSHING, Clerk
of Circuit Court and ex officio
Clerk of the Board of County
Commissioners of Sarasota
County, Florida.

By



Deputy Clerk

Exhibit A

OFFICIAL RECORDS INSTRUMENT # 2001031860 6 PGS

OFFICIAL RECORDS INSTRUMENT # 2001031860 6 PGS

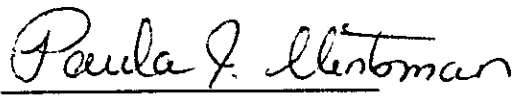
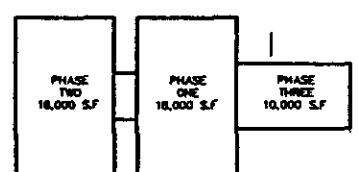
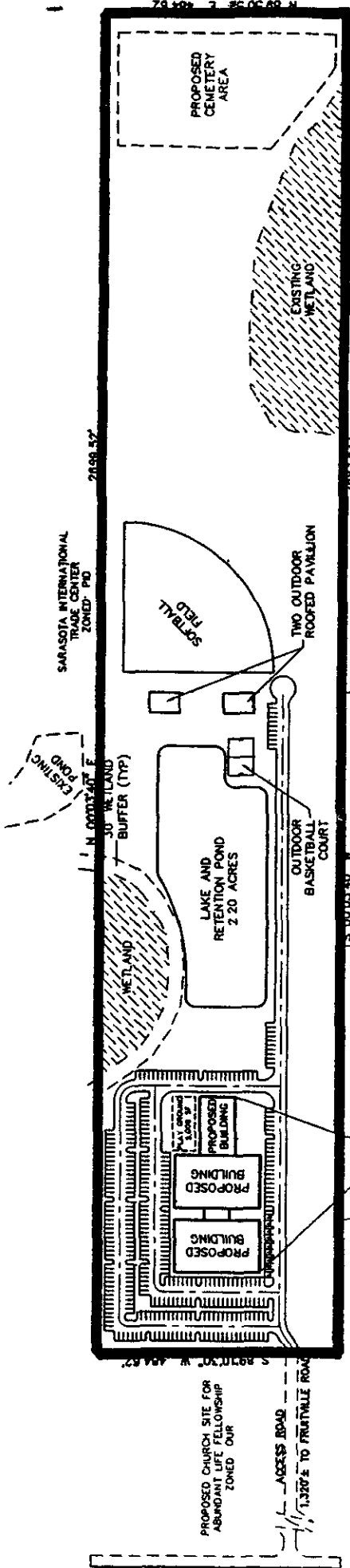
NORTH →



PHASE ONE: TEMPORARY AUDITORIUM (SANCTUARY - 750 SEATS)
 FELLOWSHIP HALL
 SUNDAY SCHOOL CLASSROOM
 CHURCH OFFICES

PHASE TWO: AUDITORIUM (SANCTUARY - 750 SEATS)
 SUNDAY SCHOOL CLASSROOM
 CHILD CARE FACILITY

PHASE THREE: FAMILY LIFE CENTER / GYMNASIUM

BUILDING DETAIL

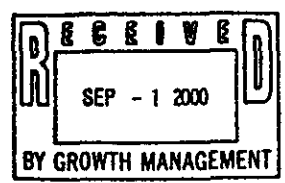

FRUITVILLE ROAD

K2001-018