

REV	DATE	BY	DESCRIPTION

DESIGNED RD	
DRAWN RD	
CHECKED RD	
DATE JANUARY 2025	

PRINTED COPIES OF THIS DOCUMENT ARE NOT CONSIDERED SIGNED AND SEALED AND THE SIGNATURE MUST BE VERIFIED ON ANY ELECTRONIC COPIES.

**carollo**  
 401 NORTH CATTLEMEN ROAD, SUITE 306  
 SARASOTA, FL. 34232  
 PHONE: (941) 371-9832 FAX: (941) 371-9873  
 CA 00008571

**Sarasota County**  
 scgov.net | 941.861.5000

SARASOTA COUNTY  
 SCADA STANDARDS  
 INSTRUMENTATION  
 TRIPLEX ELECTRICAL BLDG.  
 CONTROL SCHEMATIC 1

VERIFY SCALES BAR IS ONE INCH ON ORIGINAL DRAWING	JOB NO. 11572A10
0 1'	DRAWING NO. 20N01
IF NOT ONE INCH ON THIS SHEET, ADJUST SCALES ACCORDINGLY	SHEET NO. 1 OF 22

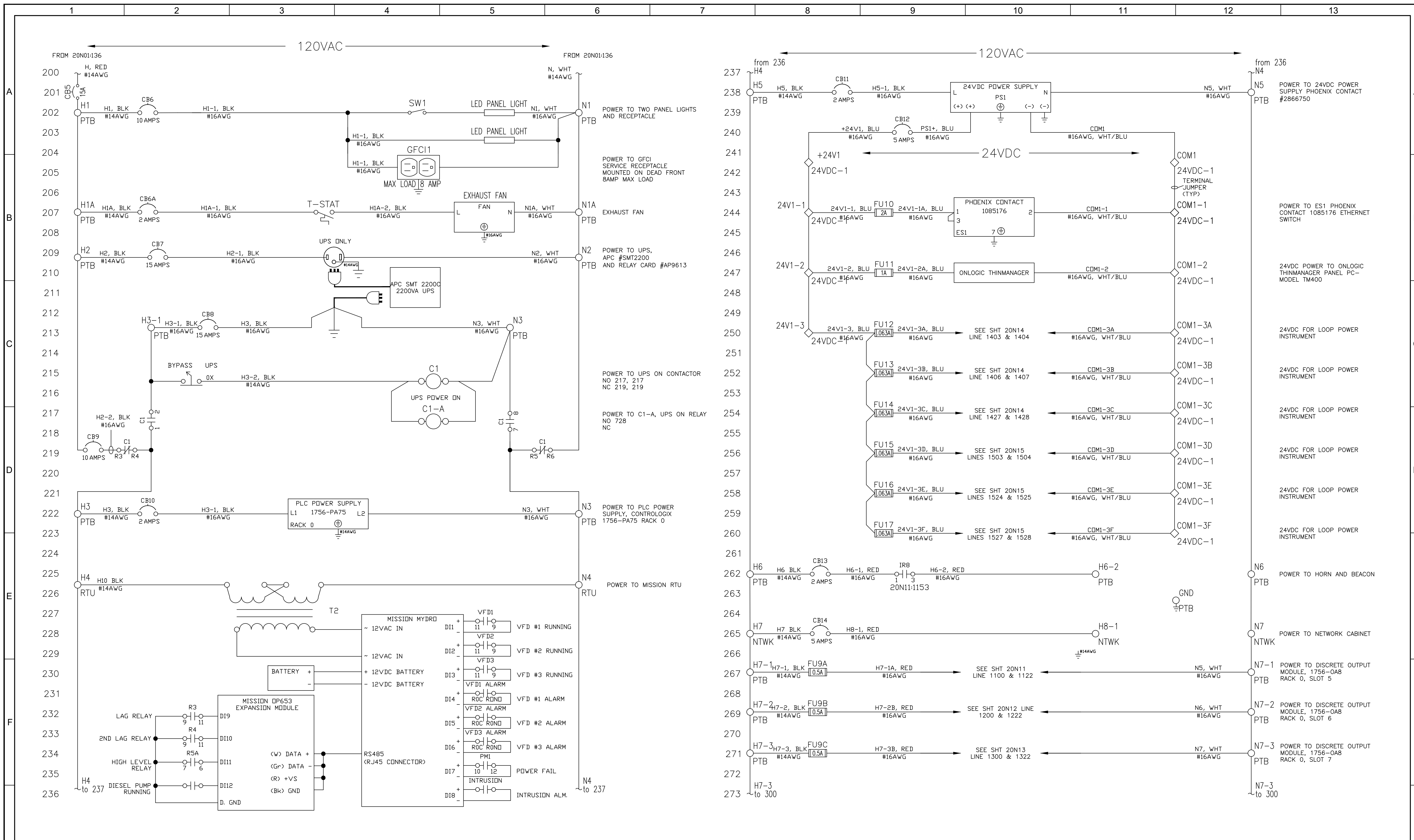

REV	DATE	BY	DESCRIPTION

DESIGNED RD  
 DRAWN RD  
 CHECKED RD  
 DATE JANUARY 2025

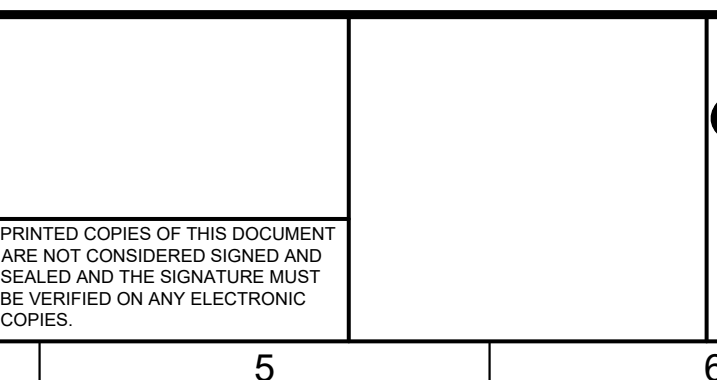

**carollo**  
 401 NORTH CATTLEMAN ROAD, SUITE 306  
 SARASOTA, FL. 34232  
 PHONE: (941) 371-9832 FAX: (941) 371-9873  
 CA 00008571



SARASOTA COUNTY  
 SCADA STANDARDS  
 INSTRUMENTATION  
 TRIPLEX ELECTRICAL BLDG.  
 CONTROL SCHEMATIC 2

VERIFY SCALES  
 BAR IS ONE INCH ON ORIGINAL DRAWING  
 0 1" 1'  
 IF NOT ONE INCH ON THIS SHEET, ADJUST SCALES ACCORDINGLY

JOB NO. 11572A10  
 DRAWING NO. 20N02  
 SHEET NO. 2 OF 22

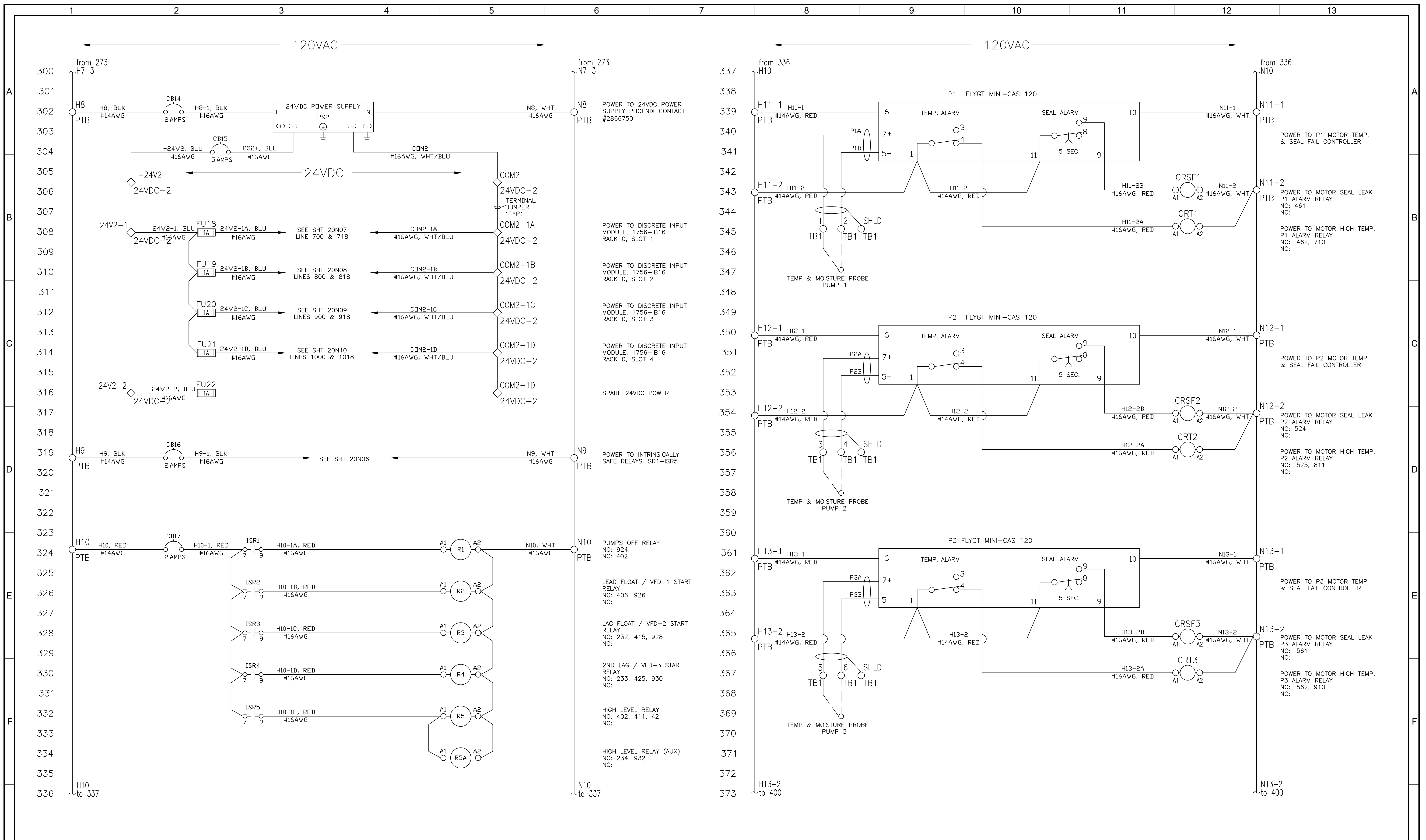

REV	DATE	BY	DESCRIPTION
1			
2			
3			
4			
5			

DESIGNED RD  
DRAWN RD  
CHECKED RD  
DATE JANUARY 2025

PRINTED COPIES OF THIS DOCUMENT ARE NOT CONSIDERED SIGNED AND SEALED AND THE SIGNATURE MUST BE VERIFIED ON ANY ELECTRONIC COPIES.

401 NORTH CATTLEMEN ROAD, SUITE 306  
SARASOTA, FL. 34232  
PHONE: (941) 371-9832 FAX: (941) 371-9873  
CA 00008571

scgov.net | 941.861.5000

SARASOTA COUNTY  
SCADA STANDARDS  
INSTRUMENTATION  
TRIPLEX ELECTRICAL BLDG.  
CONTROL SCHEMATIC 3

VERIFY SCALES  
BAR IS ONE INCH ON ORIGINAL DRAWING  
0 1'

JOB NO. 11572A10  
DRAWING NO. 20N03  
SHEET NO. 3 OF 22

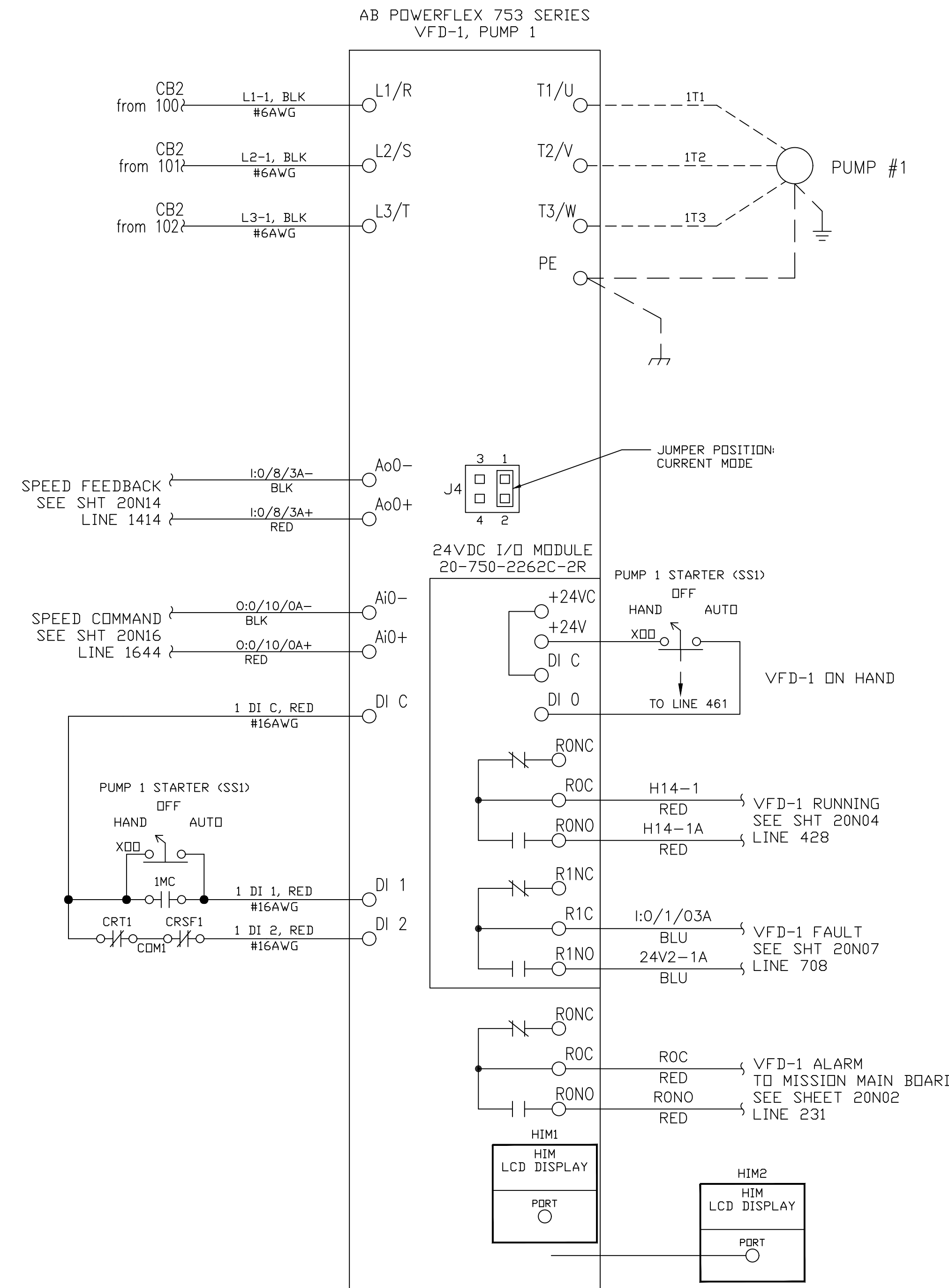
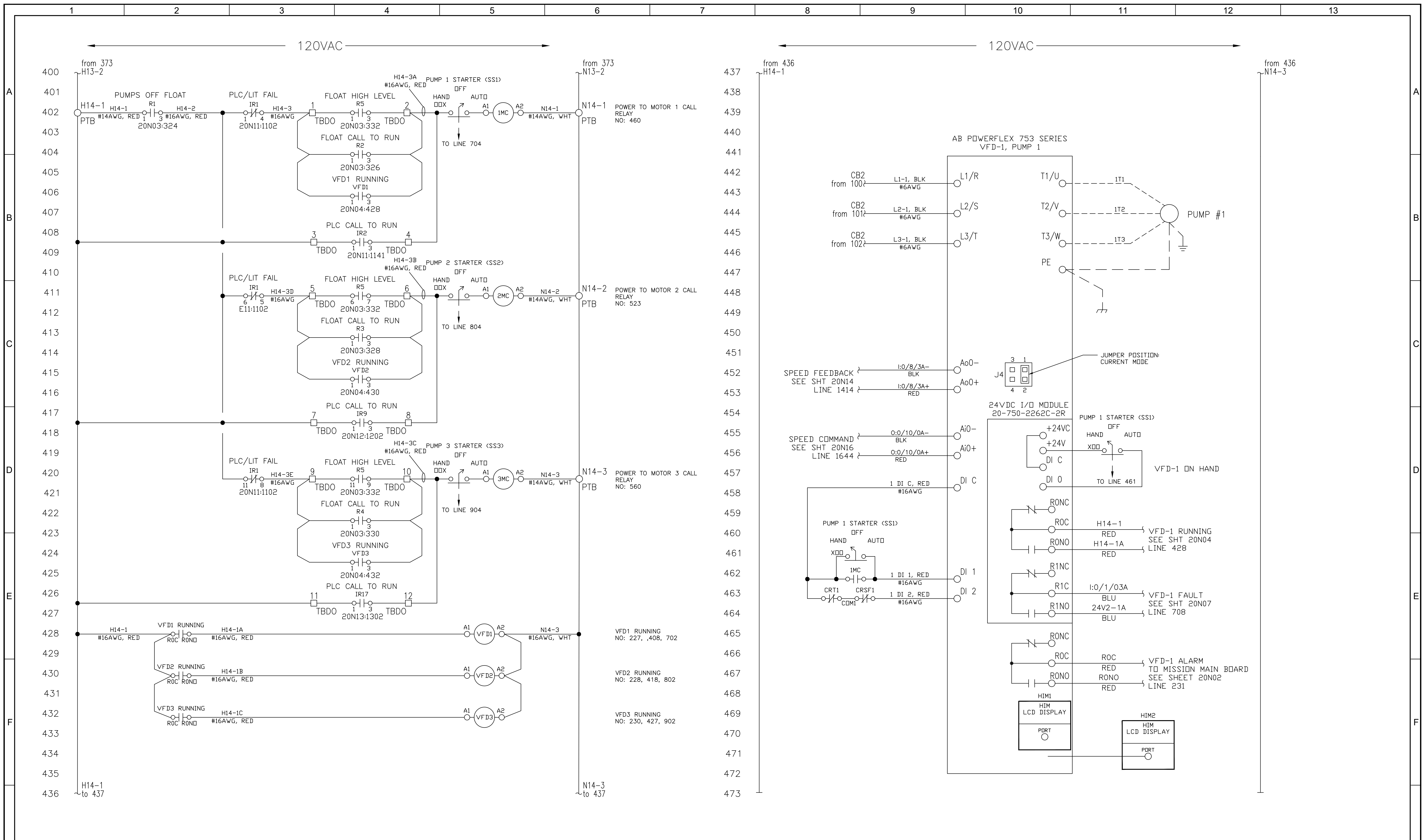

REV	DATE	BY	DESCRIPTION

DESIGNED RD	
DRAWN RD	
CHECKED RD	
DATE JANUARY 2025	

PRINTED COPIES OF THIS DOCUMENT ARE NOT CONSIDERED SIGNED AND SEALED AND THE SIGNATURE MUST BE VERIFIED ON ANY ELECTRONIC COPIES.

**carollo**  
 401 NORTH CATTLEMEN ROAD, SUITE 306  
 SARASOTA, FL. 34232  
 PHONE: (941) 371-9832 FAX: (941) 371-9873  
 CA 00008571

**Sarasota County**  
 scgov.net | 941.861.5000

SARASOTA COUNTY  
 SCADA STANDARDS  
 INSTRUMENTATION  
 TRIPLEX ELECTRICAL BLDG.  
 CONTROL SCHEMATIC 4

VERIFY SCALES  
 BAR IS ONE INCH ON ORIGINAL DRAWING  
 0 1"

JOB NO. 11572A10  
 DRAWING NO. 20N04  
 SHEET NO. 4 OF 22

IF NOT ONE INCH ON THIS SHEET, ADJUST SCALES ACCORDINGLY

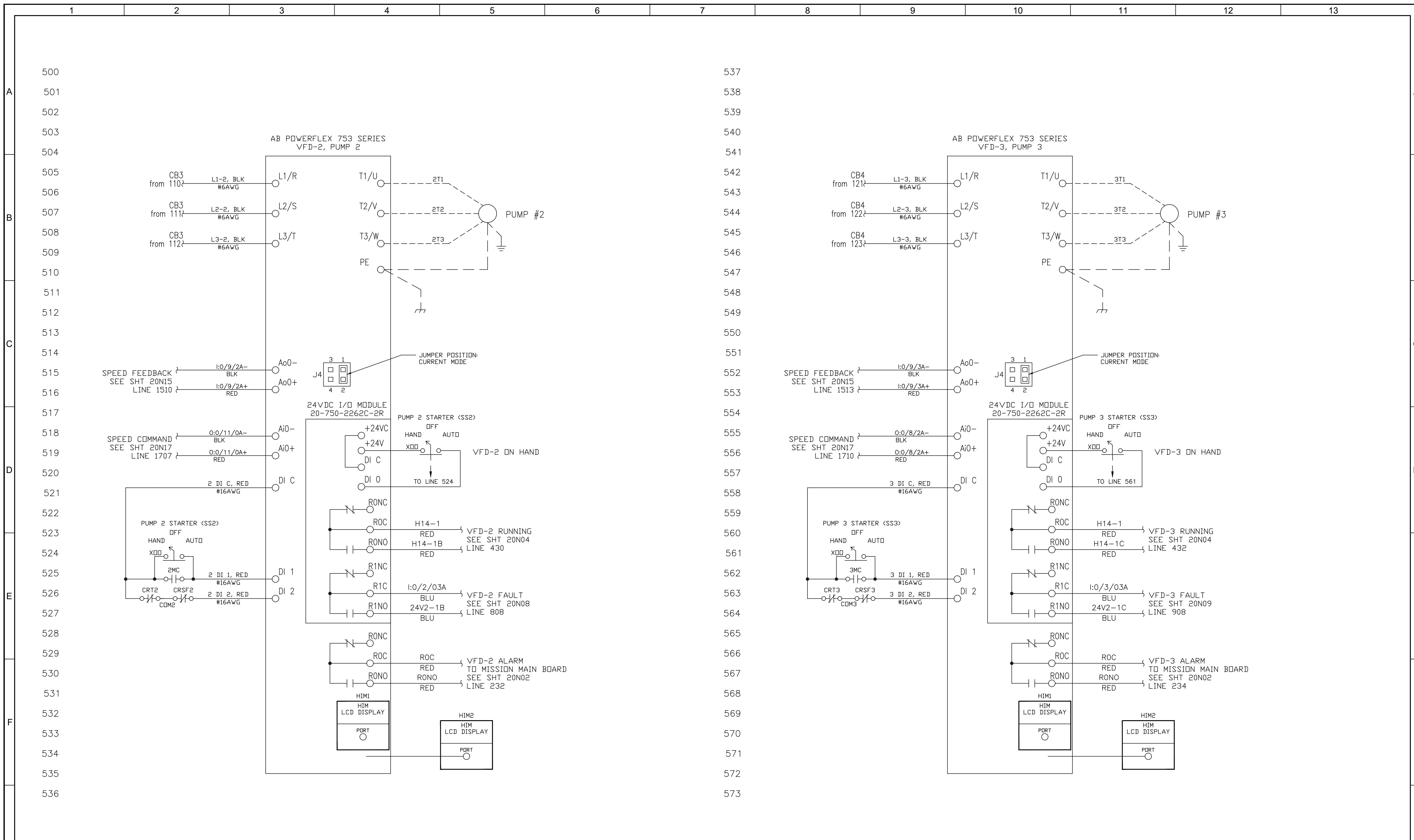

REV	DATE	BY	DESCRIPTION

DESIGNED  
RD  
DRAWN  
RD  
CHECKED  
RD  
DATE  
JANUARY 2025

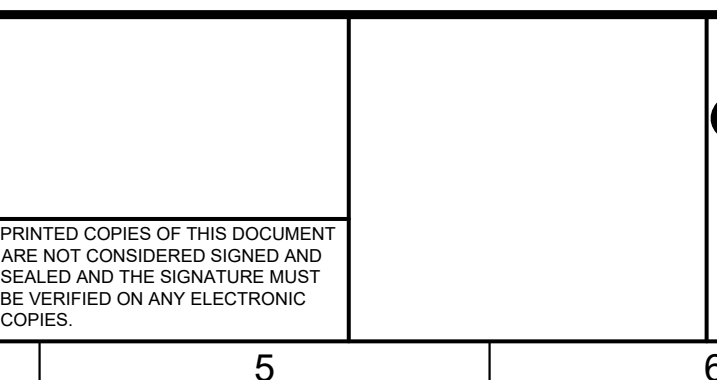

**carollo**  
401 NORTH CATTLEMEN ROAD, SUITE 306  
SARASOTA, FL. 34232  
PHONE: (941) 371-9832 FAX: (941) 371-9873  
CA 00008571



SARASOTA COUNTY  
SCADA STANDARDS  
INSTRUMENTATION  
TRIPLEX ELECTRICAL BLDG.  
CONTROL SCHEMATIC 5

VERIFY SCALES  
BAR IS ONE INCH ON ORIGINAL DRAWING  
0 1"  
IF NOT ONE INCH ON THIS SHEET, ADJUST SCALES ACCORDINGLY

JOB NO.  
11572A10  
DRAWING NO.  
20N05  
SHEET NO.  
5 OF 22

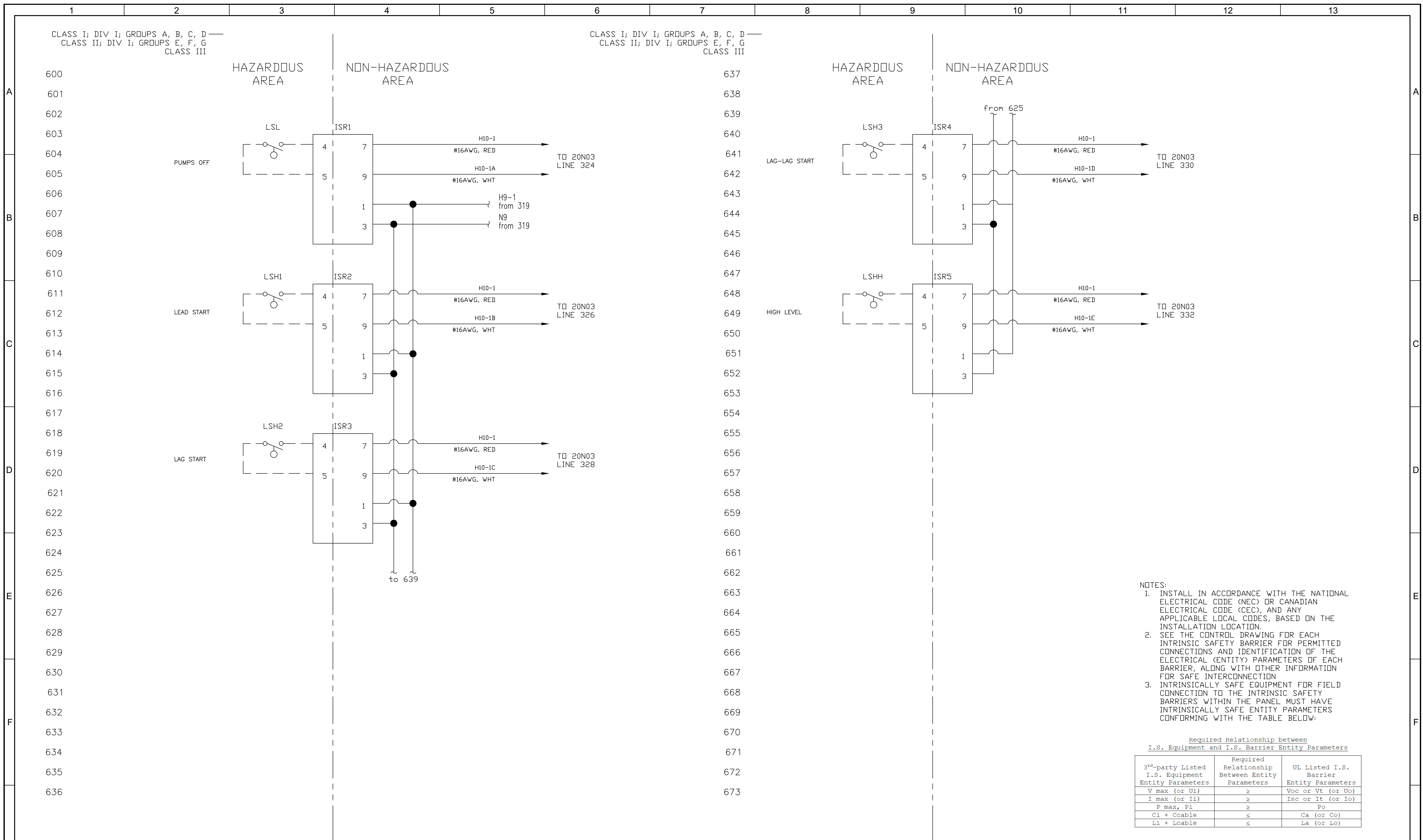

CLASS I; DIV I; GROUPS A, B, C, D  
CLASS II; DIV I; GROUPS E, F, G  
CLASS III

HAZARDOUS AREA NON-HAZARDOUS AREA

- NOTES:
- INSTALL IN ACCORDANCE WITH THE NATIONAL ELECTRICAL CODE (NEC) OR CANADIAN ELECTRICAL CODE (CEC), AND ANY APPLICABLE LOCAL CODES, BASED ON THE INSTALLATION LOCATION.
  - SEE THE CONTROL DRAWING FOR EACH INTRINSIC SAFETY BARRIER FOR PERMITTED CONNECTIONS AND IDENTIFICATION OF THE ELECTRICAL (ENTITY) PARAMETERS OF EACH BARRIER, ALONG WITH OTHER INFORMATION FOR SAFE INTERCONNECTION.
  - INTRINSICALLY SAFE EQUIPMENT FOR FIELD CONNECTION TO THE INTRINSIC SAFETY BARRIERS WITHIN THE PANEL MUST HAVE INTRINSICALLY SAFE ENTITY PARAMETERS CONFORMING WITH THE TABLE BELOW:

Required Relationship between  
I.S. Equipment and I.S. Barrier Entity Parameters

3 <sup>rd</sup> -party Listed I.S. Equipment Entity Parameters	Required Relationship Between Entity Parameters	UL Listed I.S. Barrier Entity Parameters
V max (or Ui)	≥	Voc or Vt (or Uo)
I max (or Ii)	≥	Isc or It (or Io)
P max, Pi	≥	Po
Ci + Ccable	≤	Ca (or Co)
Li + Lcable	≤	La (or Lo)

REV	DATE	BY	DESCRIPTION

DESIGNED RD  
DRAWN RD  
CHECKED RD  
DATE JANUARY 2025

PRINTED COPIES OF THIS DOCUMENT ARE NOT CONSIDERED SIGNED AND SEALED AND THE SIGNATURE MUST BE VERIFIED ON ANY ELECTRONIC COPIES.

401 NORTH CATTLEMEN ROAD, SUITE 306  
SARASOTA, FL. 34232  
PHONE: (941) 371-9832 FAX: (941) 371-9873  
CA 00008571

Sarasota County  
scgov.net | 941.861.5000

SARASOTA COUNTY  
SCADA STANDARDS  
INSTRUMENTATION  
TRIPLEX ELECTRICAL BLDG.  
CONTROL SCHEMATIC 6

VERIFY SCALES  
BAR IS ONE INCH ON ORIGINAL DRAWING  
0 1'

JOB NO. 11572A10  
DRAWING NO. 20N06  
SHEET NO. 6 OF 22

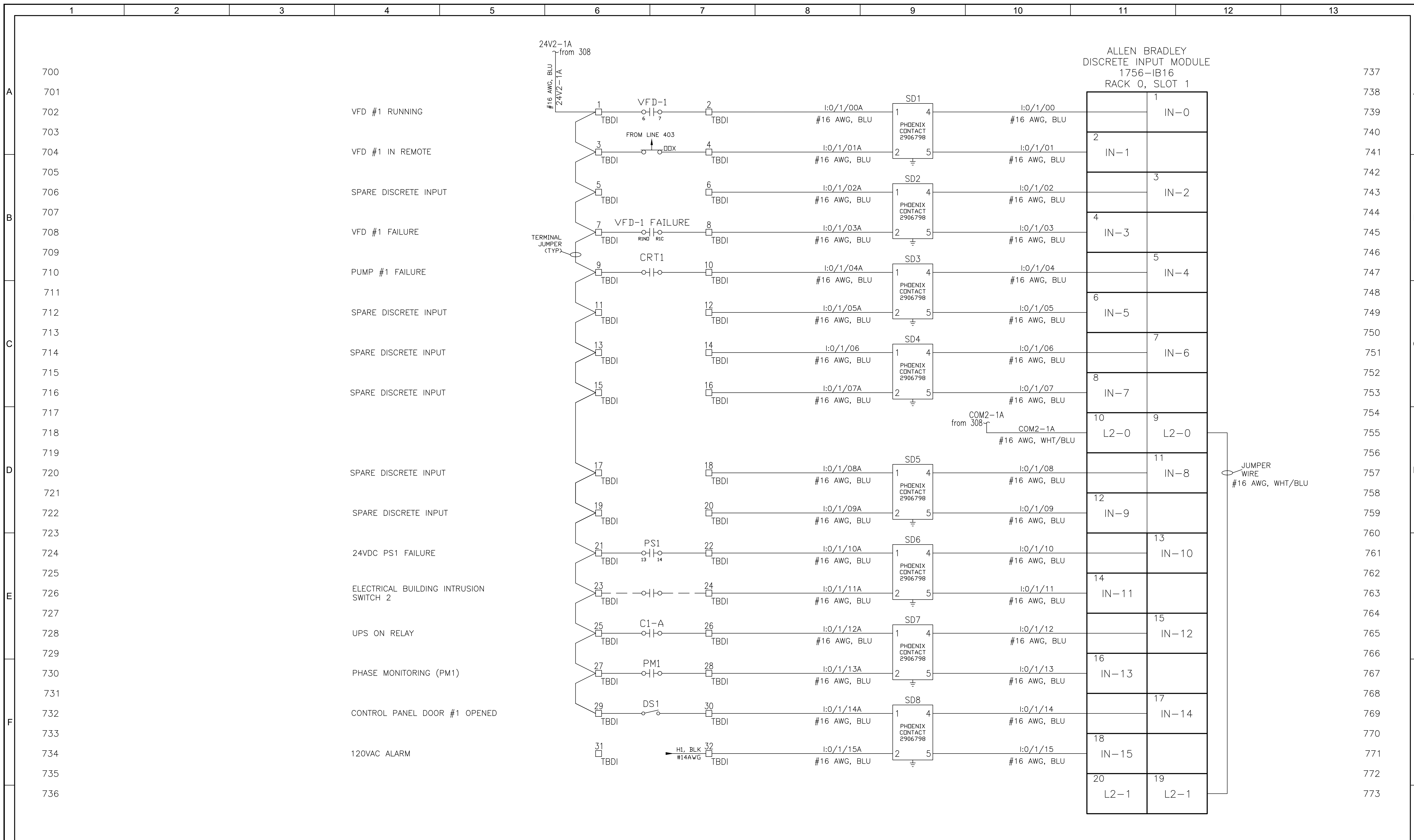

REV	DATE	BY	DESCRIPTION

DESIGNED RD  
DRAWN RD  
CHECKED RD  
DATE JANUARY 2025

PRINTED COPIES OF THIS DOCUMENT ARE NOT CONSIDERED SIGNED AND SEALED AND THE SIGNATURE MUST BE VERIFIED ON ANY ELECTRONIC COPIES.

401 NORTH CATTLEMAN ROAD, SUITE 306  
SARASOTA, FL. 34232  
PHONE: (941) 371-9832 FAX: (941) 371-9873  
CA 00008571

Sarasota County  
scgov.net | 941.861.5000

SARASOTA COUNTY  
SCADA STANDARDS  
INSTRUMENTATION  
TRIPLEX ELECTRICAL BLDG.  
CONTROL SCHEMATIC 7

VERIFY SCALES  
BAR IS ONE INCH ON ORIGINAL DRAWING  
0 1'

JOB NO. 11572A10  
DRAWING NO. 20N07  
SHEET NO. 7 OF 22

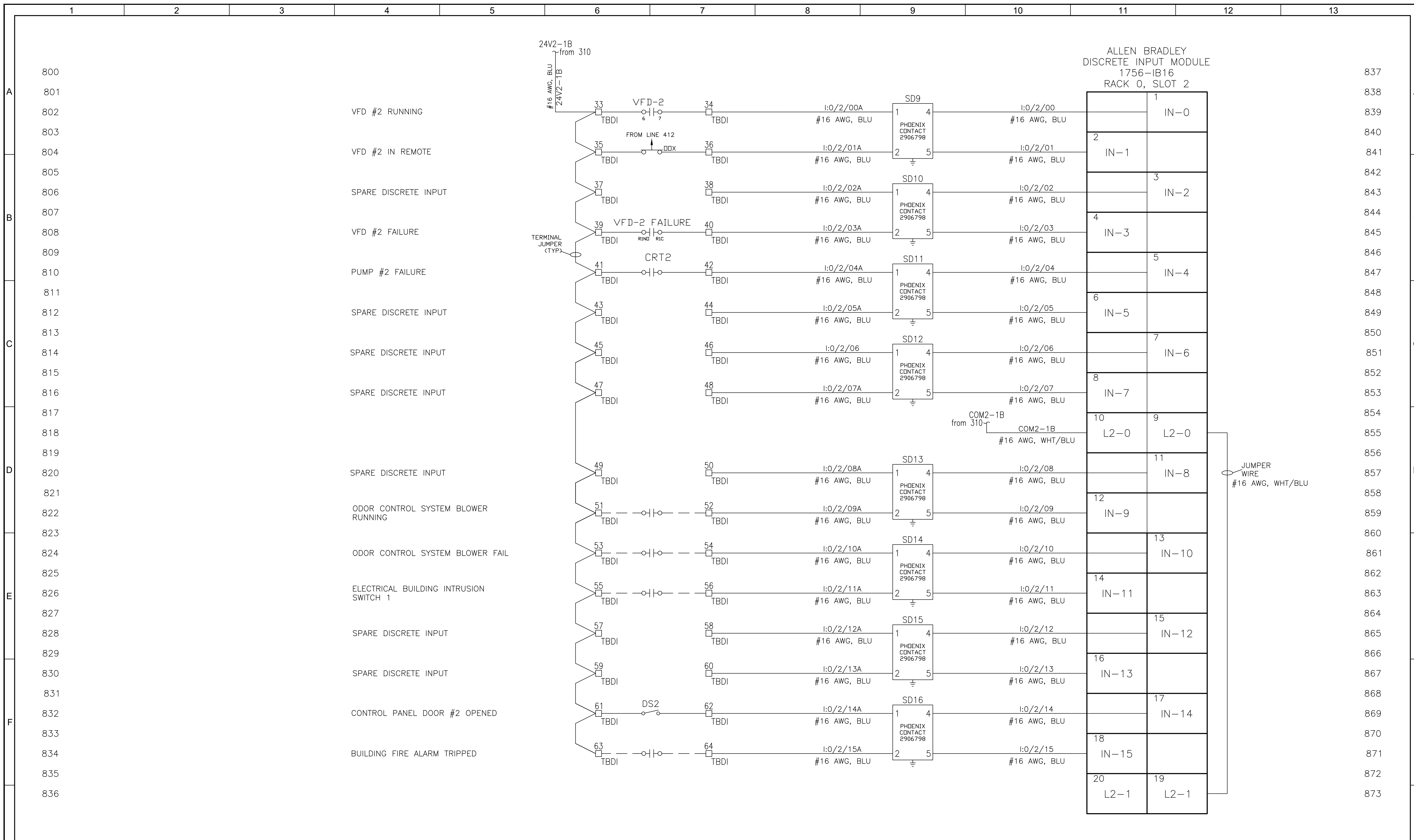

REV	DATE	BY	DESCRIPTION

DESIGNED  
RD

DRAWN  
RD

CHECKED  
RD

DATE  
JANUARY 2025

PRINTED COPIES OF THIS DOCUMENT ARE NOT CONSIDERED SIGNED AND SEALED AND THE SIGNATURE MUST BE VERIFIED ON ANY ELECTRONIC COPIES.

401 NORTH CATTLEMAN ROAD, SUITE 306  
SARASOTA, FL. 34232  
PHONE: (941) 371-9832 FAX: (941) 371-9873  
CA 00008571

Sarasota County  
scgov.net | 941.861.5000

SARASOTA COUNTY  
SCADA STANDARDS  
INSTRUMENTATION  
TRIPLEX ELECTRICAL BLDG.  
CONTROL SCHEMATIC 8

VERIFY SCALES  
BAR IS ONE INCH ON ORIGINAL DRAWING

IF NOT ONE INCH ON THIS SHEET, ADJUST SCALES ACCORDINGLY

JOB NO.  
11572A10

DRAWING NO.  
20N08

SHEET NO.  
8 OF 22

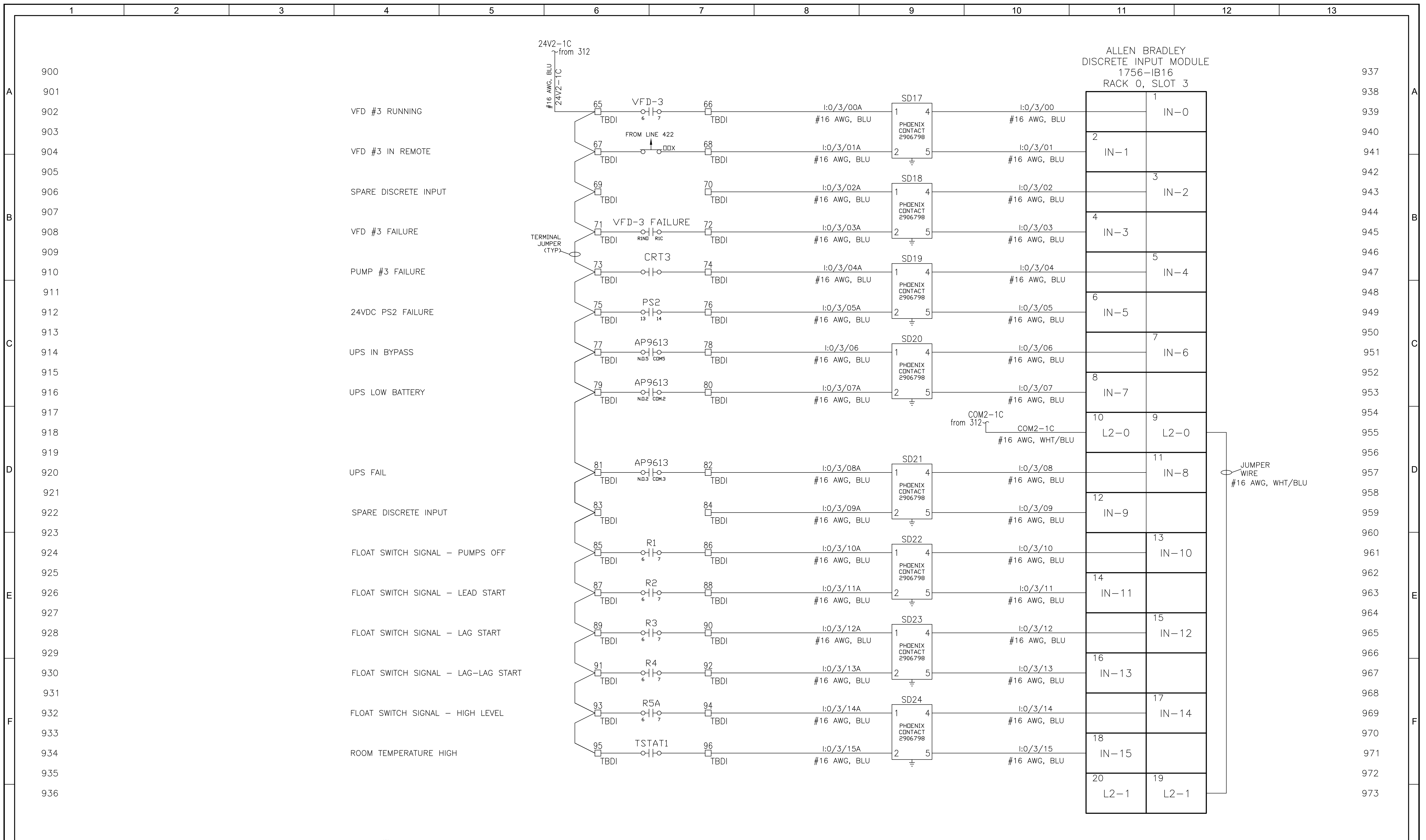

DESIGNED RD					SARASOTA COUNTY SCADA STANDARDS INSTRUMENTATION TRIPLEX ELECTRICAL BLDG. CONTROL SCHEMATIC 9	VERIFY SCALES BAR IS ONE INCH ON ORIGINAL DRAWING 	JOB NO. 11572A10 DRAWING NO. 20N09 SHEET NO. 9 OF 22
DRAWN RD							
CHECKED RD		PRINTED COPIES OF THIS DOCUMENT ARE NOT CONSIDERED SIGNED AND SEALED AND THE SIGNATURE MUST BE VERIFIED ON ANY ELECTRONIC COPIES.		401 NORTH CATTLEMEN ROAD, SUITE 306 SARASOTA, FL. 34232 PHONE: (941) 371-9832 FAX: (941) 371-9873 CA 00008571		IF NOT ONE INCH ON THIS SHEET, ADJUST SCALES ACCORDINGLY	
REV	DATE	BY	DESCRIPTION	DATE	JANUARY 2025		



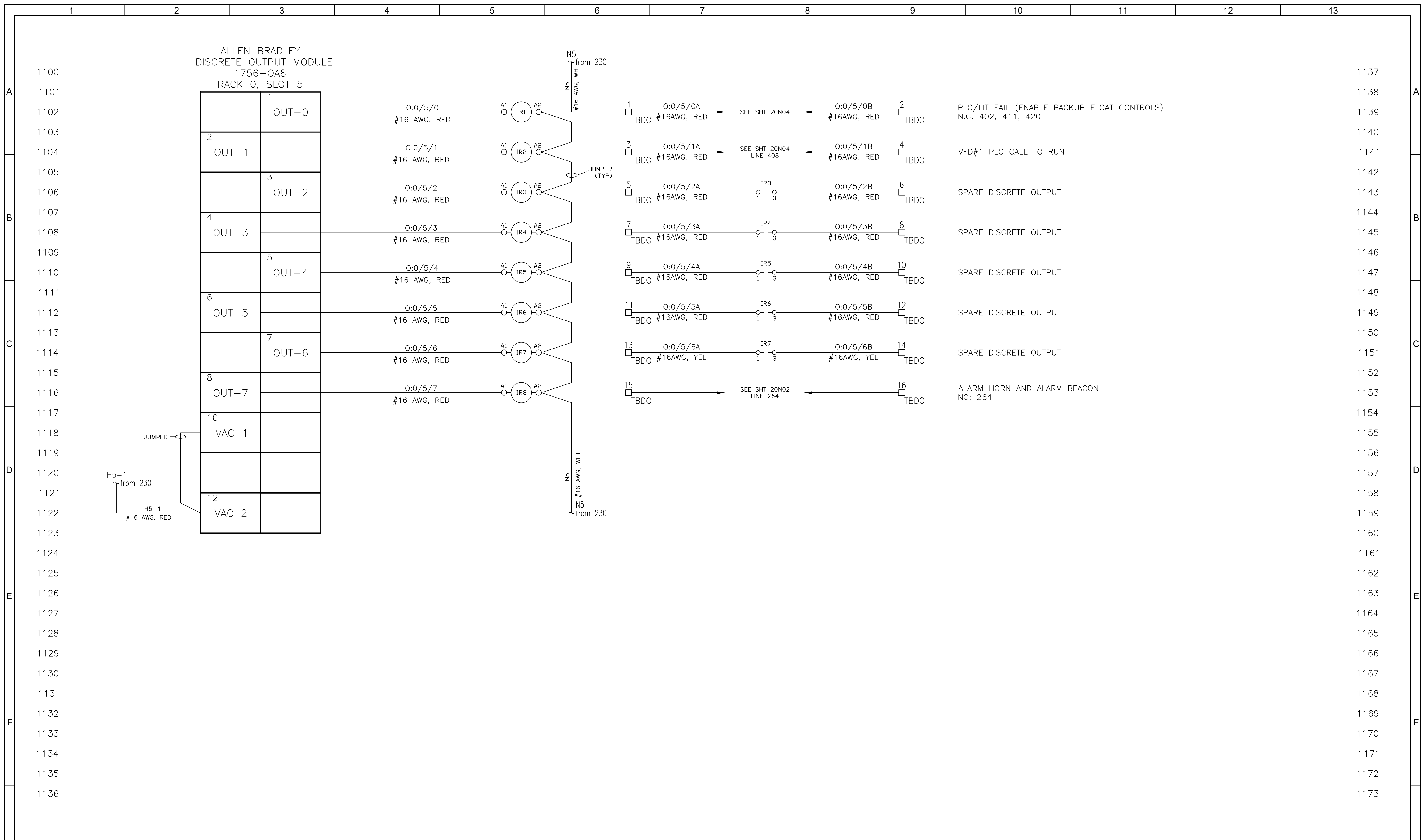

DESIGNED RD					SARASOTA COUNTY SCADA STANDARDS INSTRUMENTATION TRIPLEX ELECTRICAL BLDG. CONTROL SCHEMATIC 11	VERIFY SCALES BAR IS ONE INCH ON ORIGINAL DRAWING 0 1"	JOB NO. 11572A10
DRAWN RD						SHEET NO. 20N11	
CHECKED RD						11 OF 22	
DATE JANUARY 2025							
REV	DATE	BY	DESCRIPTION				

PRINTED COPIES OF THIS DOCUMENT ARE NOT CONSIDERED SIGNED AND SEALED AND THE SIGNATURE MUST BE VERIFIED ON ANY ELECTRONIC COPIES.

401 NORTH CATTLEMEN ROAD, SUITE 306  
SARASOTA, FL. 34232  
PHONE: (941) 371-9832 FAX: (941) 371-9873  
CA 00008571

scgov.net | 941.861.5000

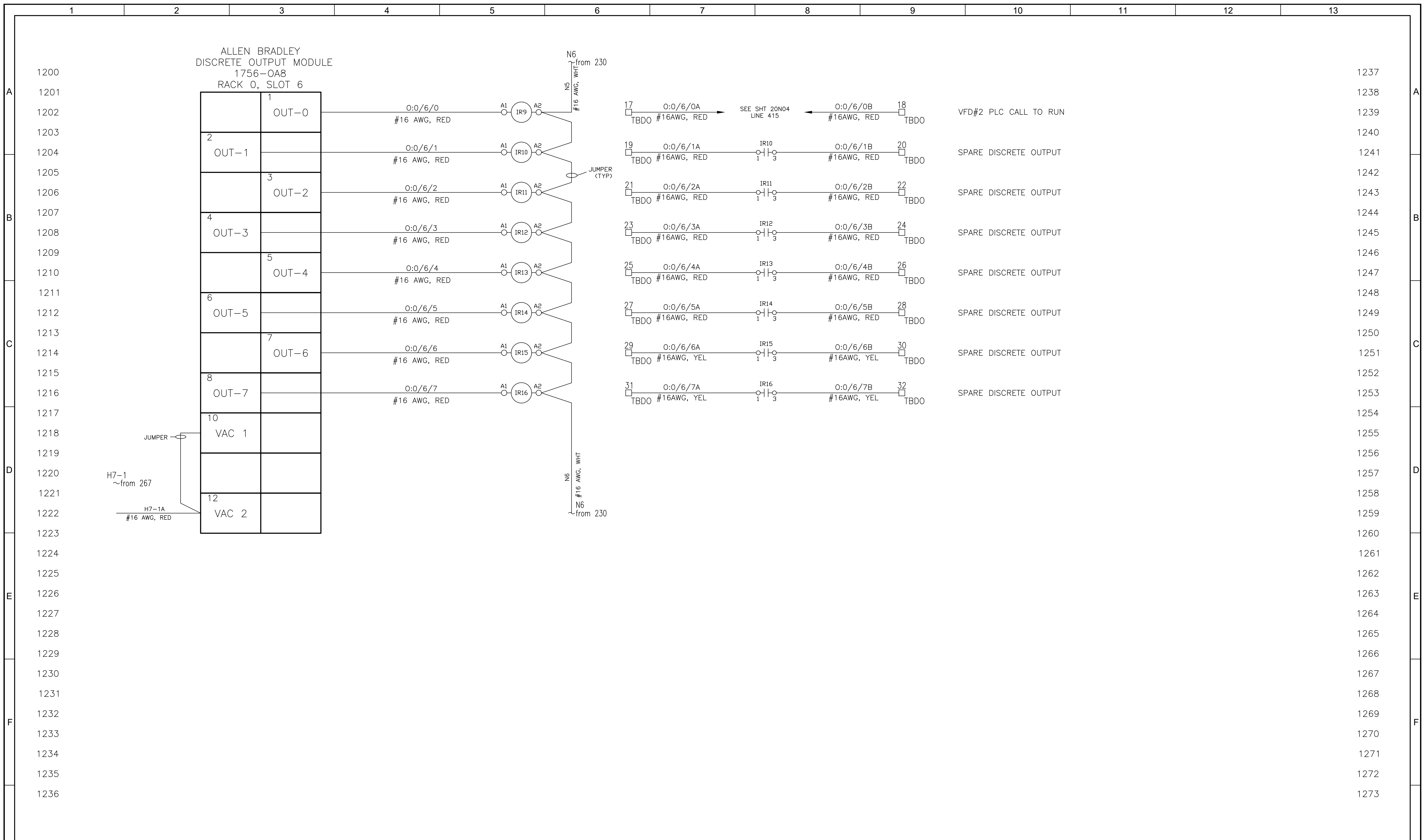

DESIGNED RD					SARASOTA COUNTY SCADA STANDARDS INSTRUMENTATION TRIPLEX ELECTRICAL BLDG. CONTROL SCHEMATIC 12	VERIFY SCALES BAR IS ONE INCH ON ORIGINAL DRAWING 	JOB NO. 11572A10
DRAWN RD						SHEET NO. 20N12	
CHECKED RD						IF NOT ONE INCH ON THIS SHEET, ADJUST SCALES ACCORDINGLY	12 OF 22
DATE JANUARY 2025							

REV	DATE	BY	DESCRIPTION

PRINTED COPIES OF THIS DOCUMENT ARE NOT CONSIDERED SIGNED AND SEALED AND THE SIGNATURE MUST BE VERIFIED ON ANY ELECTRONIC COPIES.

401 NORTH CATTLEMEN ROAD, SUITE 306  
 SARASOTA, FL. 34232  
 PHONE: (941) 371-9832 FAX: (941) 371-9873  
 CA 00008571

scgov.net | 941.861.5000

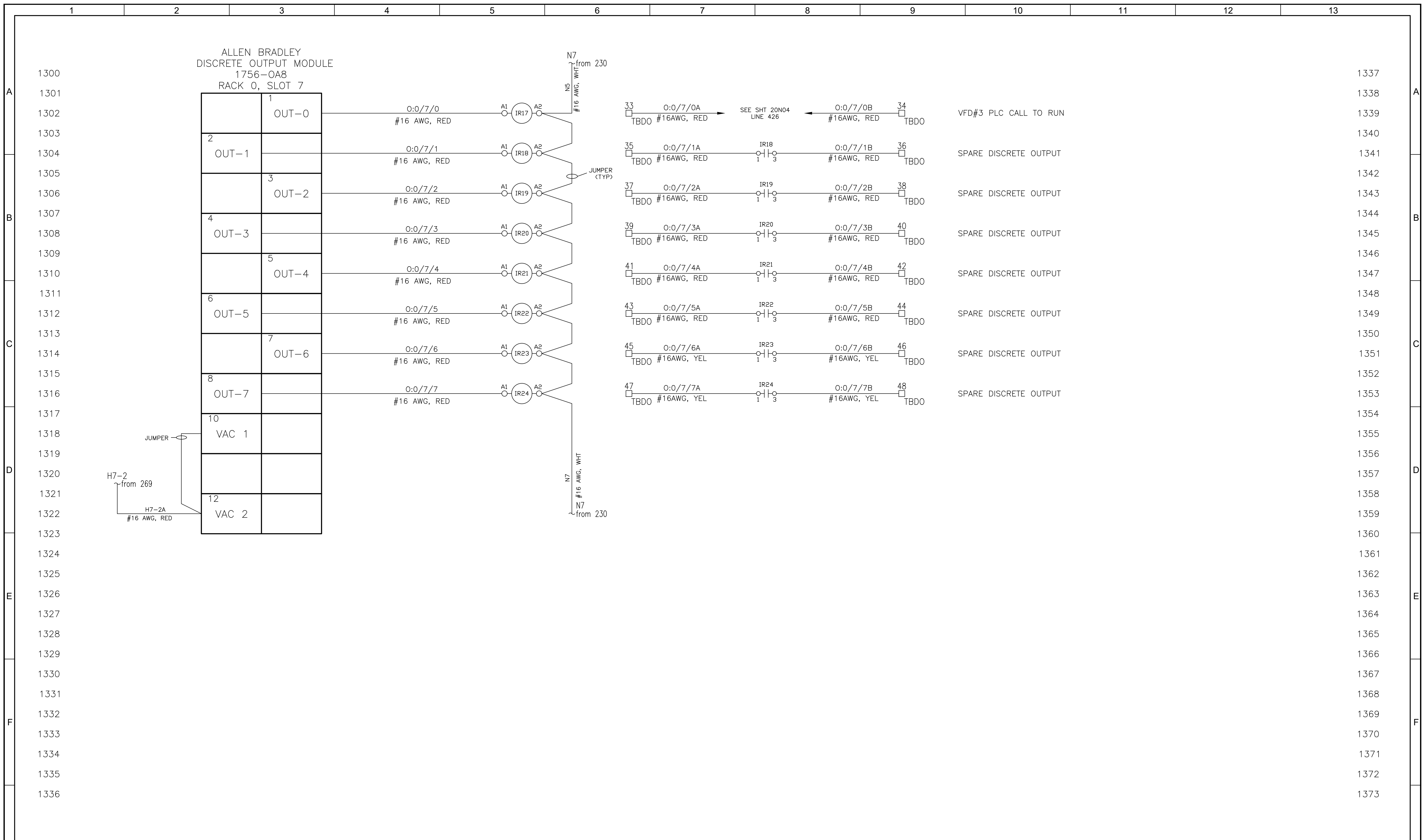

DESIGNED RD			<b>carollo</b> 401 NORTH CATTLEMEN ROAD, SUITE 306 SARASOTA, FL. 34232 PHONE: (941) 371-9832 FAX: (941) 371-9873 CA 00008571	 Sarasota County scgov.net   941.861.5000	SARASOTA COUNTY		VERIFY SCALES BAR IS ONE INCH ON ORIGINAL DRAWING 	JOB NO. 11572A10
DRAWN RD					SCADA STANDARDS			DRAWING NO. 20N13
CHECKED RD					INSTRUMENTATION			SHEET NO.
DATE JANUARY 2025					TRIPLEX ELECTRICAL BLDG. CONTROL SCHEMATIC 13			13 OF 22
REV	DATE	BY	DESCRIPTION					







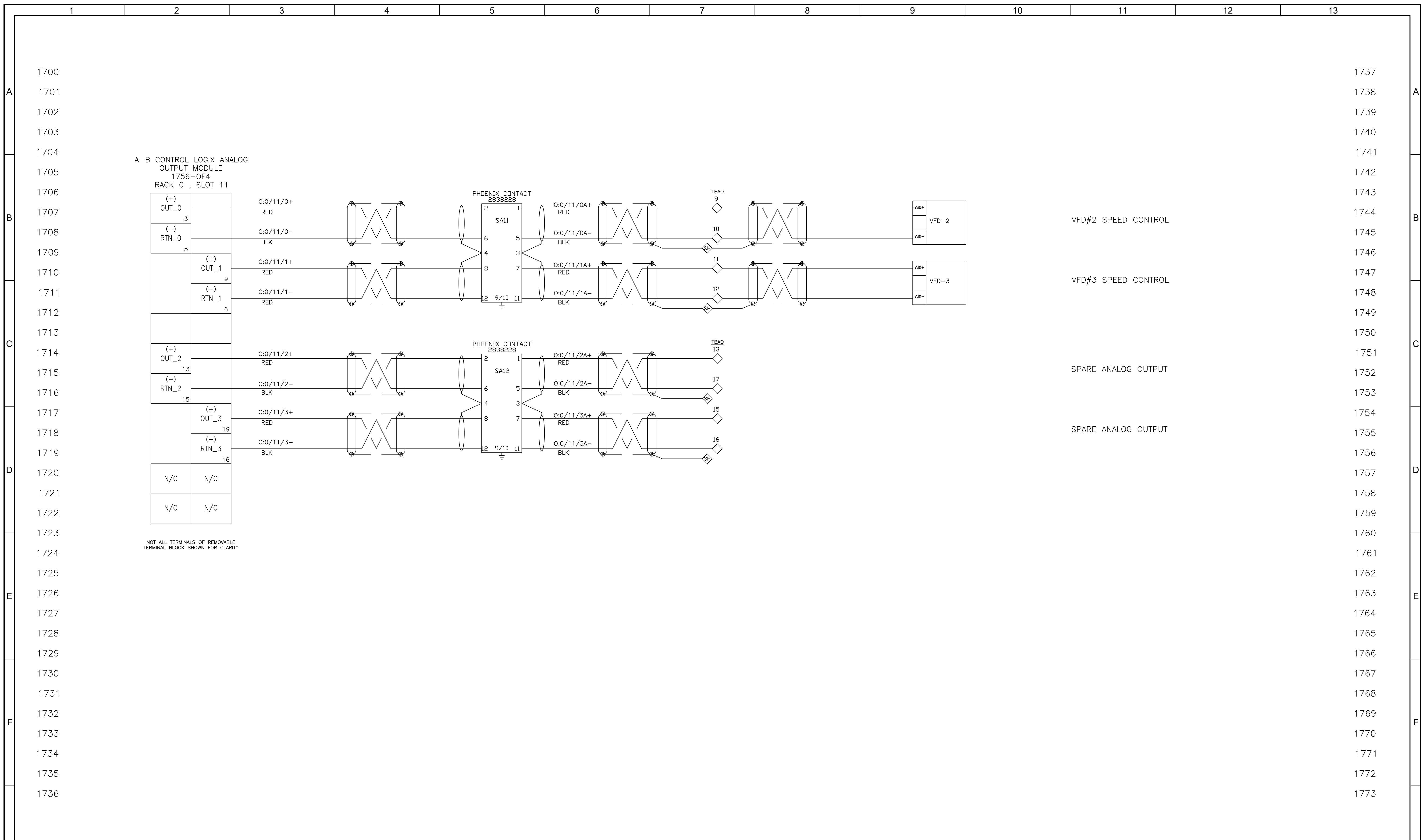

REV	DATE	BY	DESCRIPTION

DESIGNED  
RD  
DRAWN  
RD  
CHECKED  
RD  
DATE  
JANUARY 2025

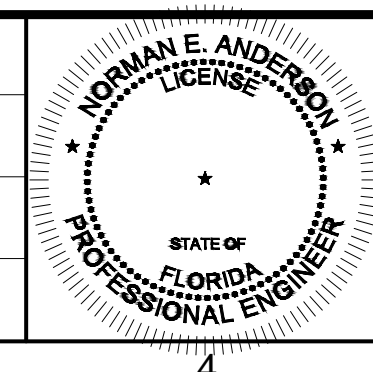

PRINTED COPIES OF THIS DOCUMENT ARE NOT CONSIDERED SIGNED AND SEALED AND THE SIGNATURE MUST BE VERIFIED ON ANY ELECTRONIC COPIES.

**carollo**  
401 NORTH CATTLEMEN ROAD, SUITE 306  
SARASOTA, FL. 34232  
PHONE: (941) 371-9832 FAX: (941) 371-9873  
CA 00008571

**Sarasota County**  
scgov.net | 941.861.5000

SARASOTA COUNTY  
SCADA STANDARDS  
INSTRUMENTATION  
TRIPLEX ELECTRICAL BLDG.  
CONTROL SCHEMATIC 17

VERIFY SCALES  
BAR IS ONE INCH ON ORIGINAL DRAWING  
0 1'  
IF NOT ONE INCH ON THIS SHEET, ADJUST SCALES ACCORDINGLY

JOB NO.  
11572A10  
DRAWING NO.  
20N17  
SHEET NO.  
17 OF 22

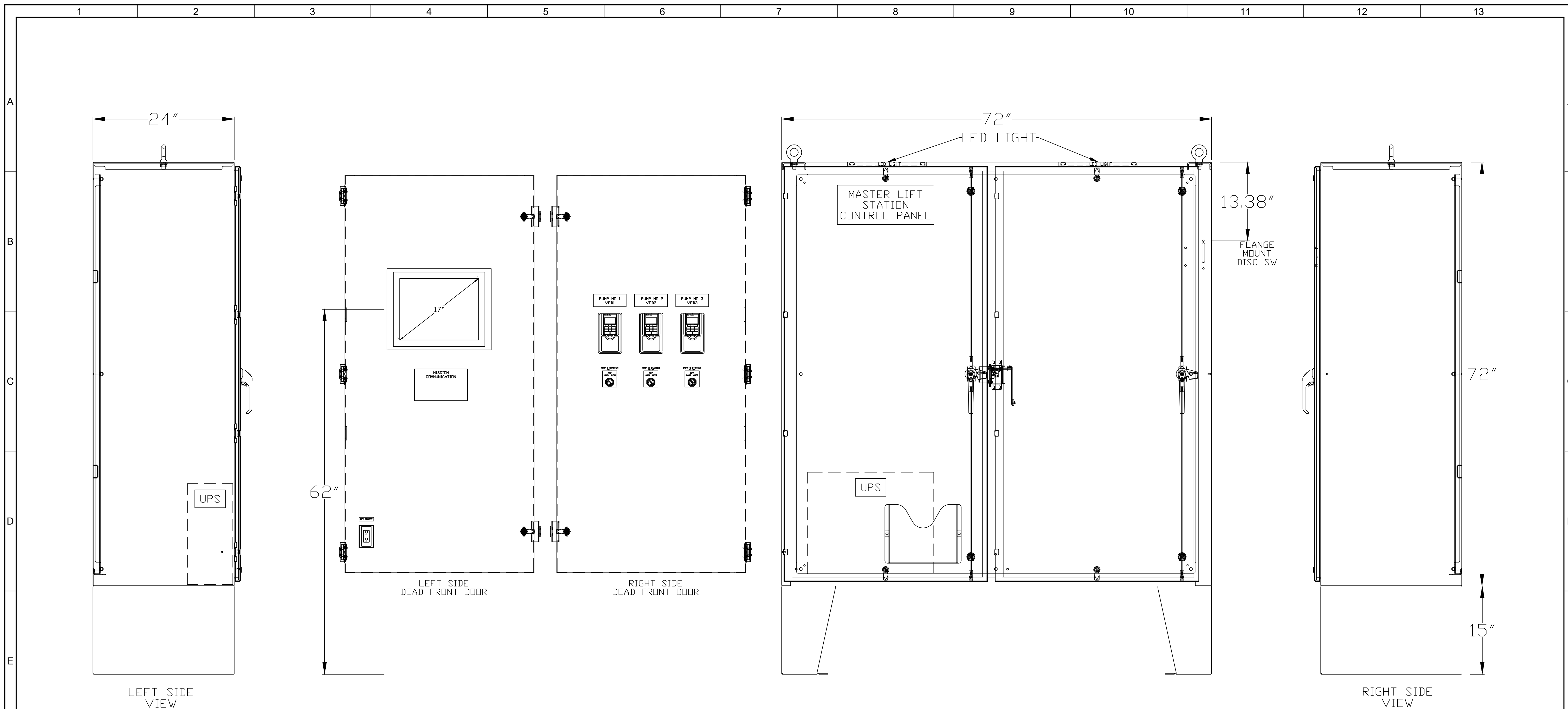

72"H X 72"W X 24"D ENCLOSURE, DISCONNECT TYPE, FLOOR MOUNT WITH 15" LEG KIT, TWO DOOR, CARBON STEEL. NEMA12, INNER DEAD FRONT DOOR FOR EACH OF THE TWO DOORS, MINIMUM OF 3" BACK FROM THE OUTER DOORS

DESIGNED RD			PRINTED COPIES OF THIS DOCUMENT ARE NOT CONSIDERED SIGNED AND SEALED AND THE SIGNATURE MUST BE VERIFIED ON ANY ELECTRONIC COPIES.	 401 NORTH CATTLEMEN ROAD, SUITE 306 SARASOTA, FL. 34232 PHONE: (941) 371-9832 FAX: (941) 371-9873 CA 00008571	 scgov.net   941.861.5000	SARASOTA COUNTY SCADA STANDARDS INSTRUMENTATION TRIPLEX ELECTRICAL BLDG. EXTERNAL ELEVATION	VERIFY SCALES BAR IS ONE INCH ON ORIGINAL DRAWING 	JOB NO. 11572A10 DRAWING NO. 20N18 SHEET NO. 18 OF 22
DRAWN RD								
CHECKED RD								
DATE JANUARY 2025								
REV	DATE	BY	DESCRIPTION					

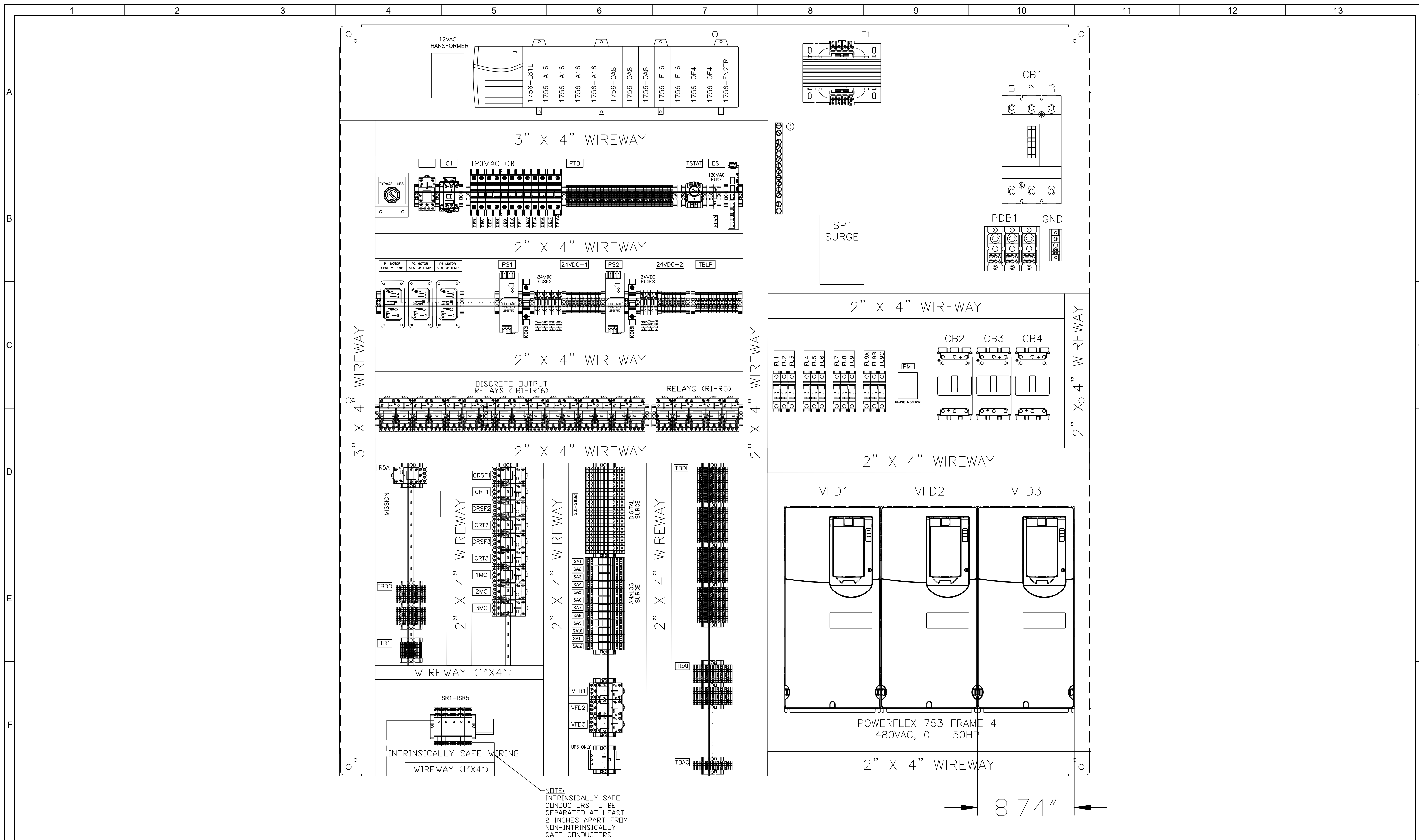

NOTE:  
INTRINSICALLY SAFE  
CONDUCTORS TO BE  
SEPARATED AT LEAST  
2 INCHES APART FROM  
NON-INTRINSICALLY  
SAFE CONDUCTORS

8.74"

REV	DATE	BY	DESCRIPTION

DESIGNED  
RD  
DRAWN  
RD  
CHECKED  
RD  
DATE  
JANUARY 2025

PRINTED COPIES OF THIS DOCUMENT  
ARE NOT CONSIDERED SIGNED AND  
SEALED AND THE SIGNATURE MUST  
BE VERIFIED ON ANY ELECTRONIC  
COPIES.

**carollo**  
401 NORTH CATTLEMEN ROAD, SUITE 306  
SARASOTA, FL. 34232  
PHONE: (941) 371-9832 FAX: (941) 371-9873  
CA 00008571

Sarasota County  
scgov.net | 941.861.5000

SARASOTA COUNTY  
SCADA STANDARDS  
INSTRUMENTATION  
TRIPLEX ELECTRICAL BLDG.  
INTERNAL ELEVATION

VERIFY SCALES  
BAR IS ONE INCH ON  
ORIGINAL DRAWING  
0 1"

JOB NO.  
11572A10  
DRAWING NO.  
20N19  
SHEET NO.  
19 OF 22

- GENERAL NOTES:**
1. ELECTRICAL BUILDING SHALL BE LEESBURG CONCRETE COMPANY INC., MODEL NUMBER CJ 818.
  2. ALL ELECTRICAL CABINETS SHALL BE 316 STAINLESS STEEL.
  3. ALL ELECTRICAL PIPING SHALL BE ALUMINUM WITH THE EXCEPTION OF THE METER BASE HALO PIPING, WHICH SHALL BE PVC.
  4. NO SIDE PENETRATIONS SHALL BE PERMITTED AT THE JUNCTION BOX, DISCONNECTS, METER BASE, OR SERVICE DISCONNECT.



**BACK SECTION - NORTH**  
SCALE: NO SCALE

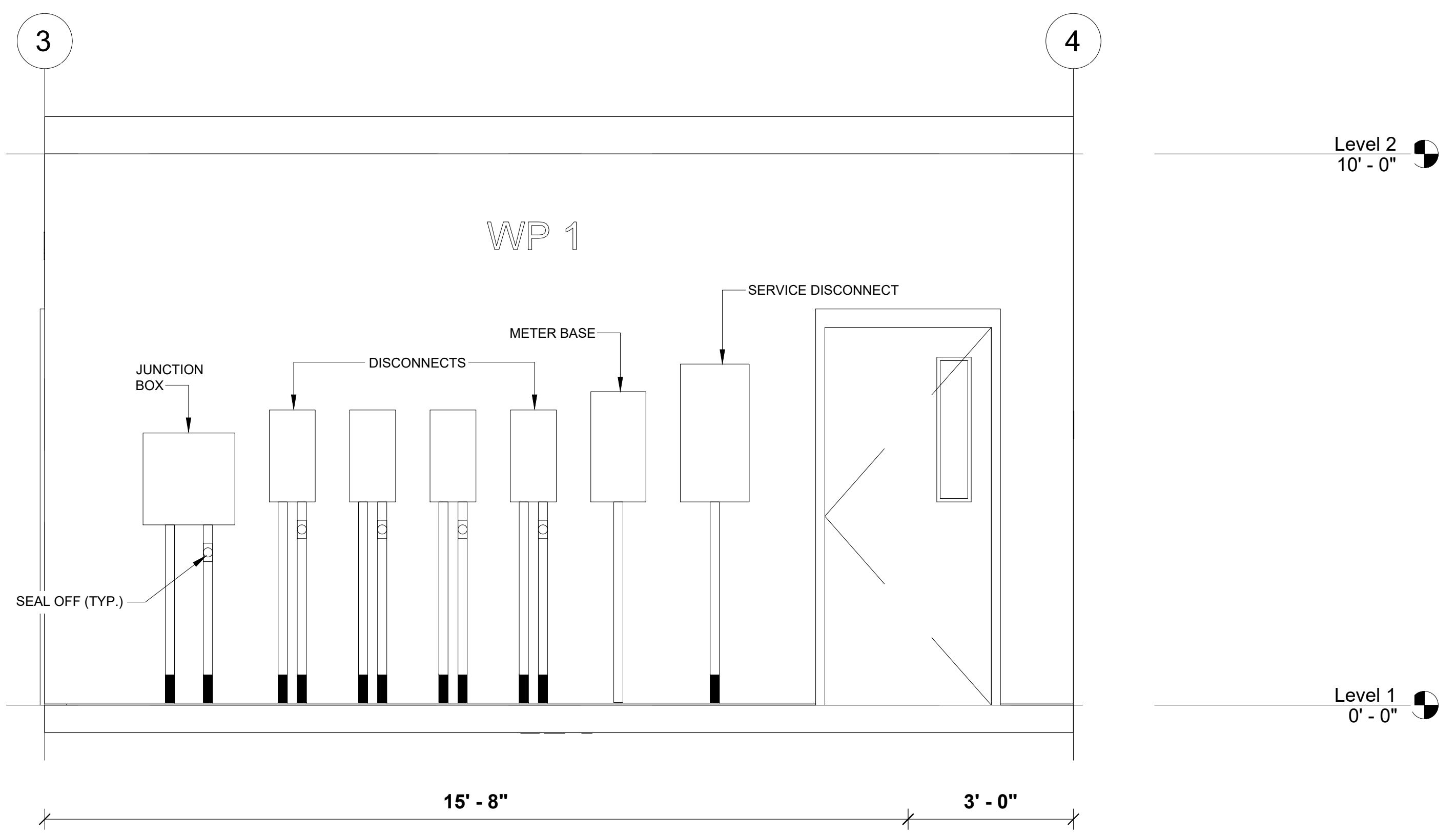

**FRONT SECTION - SOUTH**  
SCALE: NO SCALE

REV	DATE	BY	DESCRIPTION

DESIGNED  
RD  
DRAWN  
RD  
CHECKED  
RD  
DATE  
JANUARY 2025

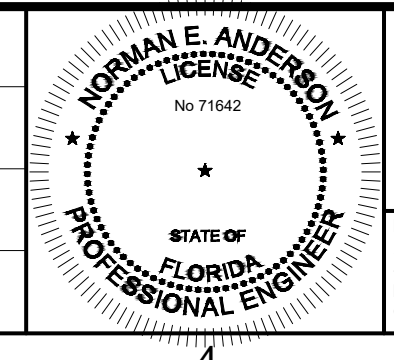

PRINTED COPIES OF THIS DOCUMENT ARE NOT CONSIDERED SIGNED AND SEALED AND THE SIGNATURE MUST BE VERIFIED ON ANY ELECTRONIC COPIES.

**carollo**  
401 NORTH CATTLEMEN ROAD, SUITE 306  
SARASOTA, FL. 34232  
PHONE: (941) 371-9832 FAX: (941) 371-9873  
CA 00008571

**Sarasota County**  
scgov.net | 941.861.5000

SARASOTA COUNTY  
SCADA STANDARDS  
DISCP  
TRIPLEX ELECTRICAL BLDG.  
EXTERIOR - FRONT AND BACK SECTIONS

VERIFY SCALES  
BAR IS ONE INCH ON ORIGINAL DRAWING  
0 1"  
IF NOT ONE INCH ON THIS SHEET, ADJUST SCALES ACCORDINGLY

JOB NO. 11572A10  
DRAWING NO. 20N20  
SHEET NO. 20 OF 22

GENERAL NOTES:

- SPLIT AC UNIT TO BE SUPPLIED BY SARASOTA COUNTY PUBLIC UTILITIES AT DEVELOPER'S EXPENSE. IN THE PRESENCE OF A SARASOTA COUNTY PUBLIC UTILITIES' REPRESENTATIVE, THE SPLIT AC UNIT SHALL BE FIELD INSTALLED WITH WALL PENETRATIONS CORED IN THE FIELD.

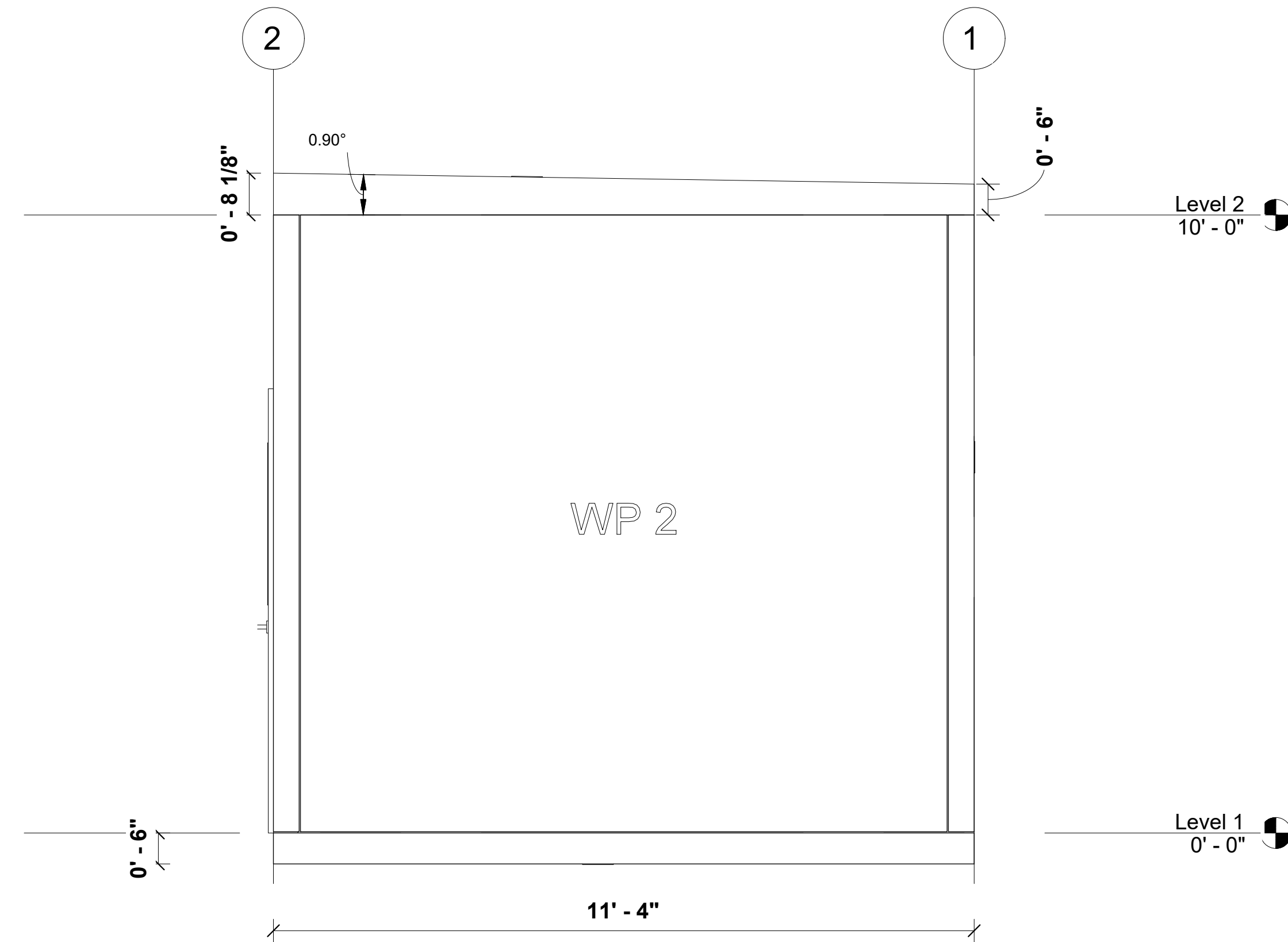

**SIDE SECTION - EAST**  
SCALE: NO SCALE

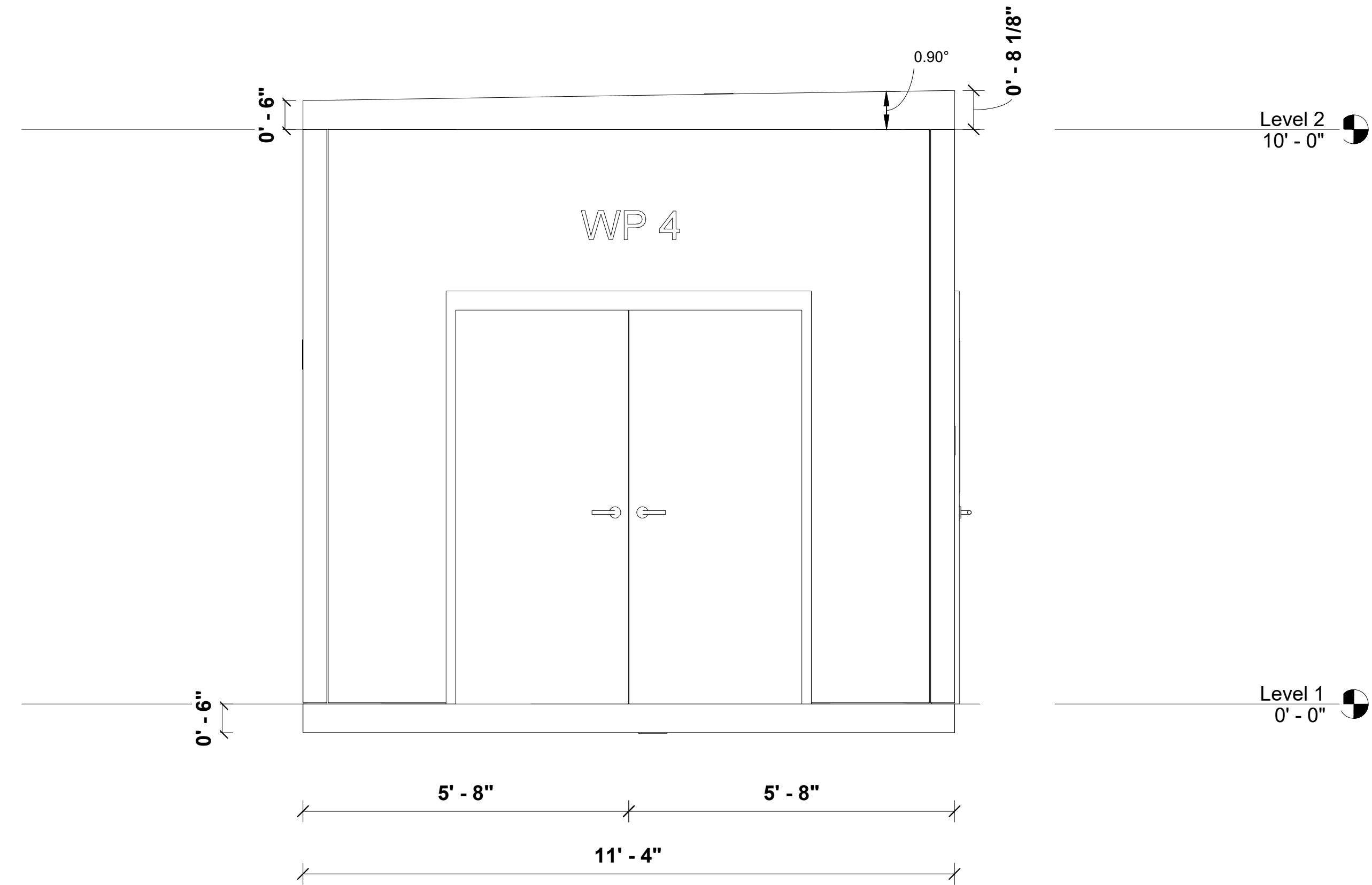

**SIDE SECTION - WEST**  
SCALE: NO SCALE

REV	DATE	BY	DESCRIPTION

DESIGNED  
RD

DRAWN  
RD

CHECKED  
RD

DATE  
JANUARY 2025

PRINTED COPIES OF THIS DOCUMENT ARE NOT CONSIDERED SIGNED AND SEALED AND THE SIGNATURE MUST BE VERIFIED ON ANY ELECTRONIC COPIES.

401 NORTH CATTLEMEN ROAD, SUITE 306  
SARASOTA, FL. 34232  
PHONE: (941) 371-9832 FAX: (941) 371-9873  
CA 00008571

scgov.net | 941.861.5000

SARASOTA COUNTY  
SCADA STANDARDS  
DISCP  
TRIPLEX ELECTRICAL BLDG.  
EXTERIOR - SIDE SECTIONS

VERIFY SCALES  
BAR IS ONE INCH ON ORIGINAL DRAWING

IF NOT ONE INCH ON THIS SHEET, ADJUST SCALES ACCORDINGLY

JOB NO.  
11572A10

DRAWING NO.  
20N21

SHEET NO.  
21 OF 22

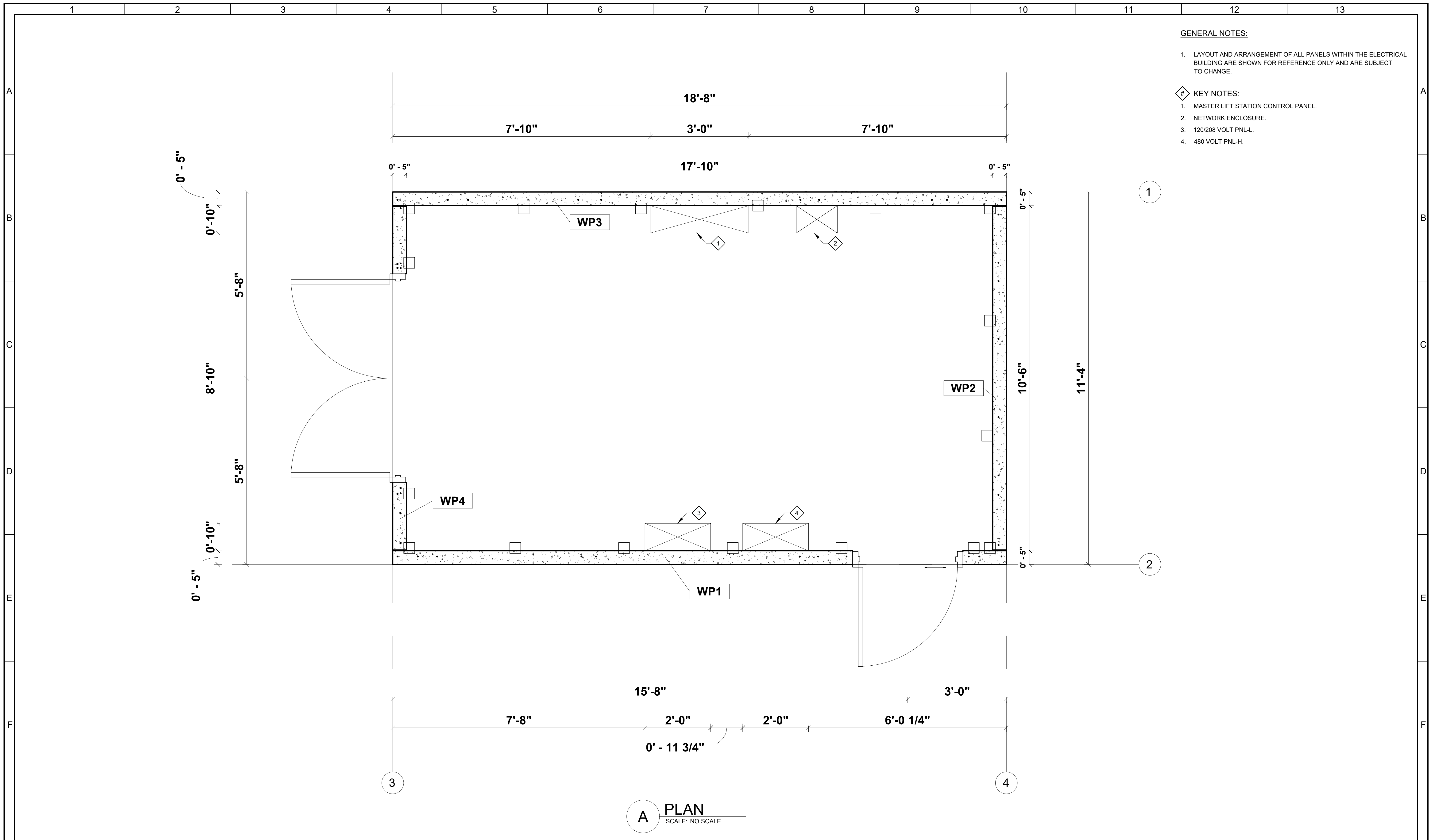

**GENERAL NOTES:**

- LAYOUT AND ARRANGEMENT OF ALL PANELS WITHIN THE ELECTRICAL BUILDING ARE SHOWN FOR REFERENCE ONLY AND ARE SUBJECT TO CHANGE.

**KEY NOTES:**

- MASTER LIFT STATION CONTROL PANEL.
- NETWORK ENCLOSURE.
- 120/208 VOLT PNL-L.
- 480 VOLT PNL-H.

**A PLAN**  
SCALE: NO SCALE

REV	DATE	BY	DESCRIPTION

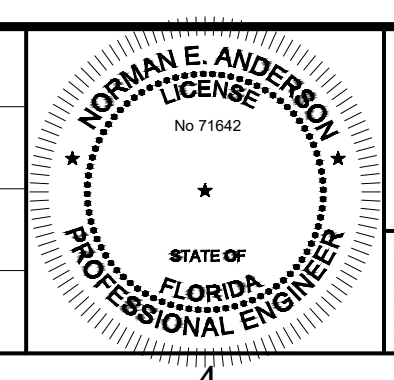

PRINTED COPIES OF THIS DOCUMENT ARE NOT CONSIDERED SIGNED AND SEALED AND THE SIGNATURE MUST BE VERIFIED ON ANY ELECTRONIC COPIES.

**carollo**  
401 NORTH CATTLEMEN ROAD, SUITE 306  
SARASOTA, FL. 34232  
PHONE: (941) 371-9832 FAX: (941) 371-9873  
CA 00008571

**Sarasota County**  
scgov.net | 941.861.5000

SARASOTA COUNTY  
SCADA STANDARDS  
DISCP  
TRIPLEX ELECTRICAL BLDG.  
INTERIOR FOOTPRINT

VERIFY SCALES  
BAR IS ONE INCH ON ORIGINAL DRAWING  
0 1"  
IF NOT ONE INCH ON THIS SHEET, ADJUST SCALES ACCORDINGLY

JOB NO. 11572A10  
DRAWING NO. 20N22  
SHEET NO. 22 OF 22