

GENERAL NOTES:

1. EACH SERVICE OR DOUBLE WYE SERVICE SHALL HAVE A CLEAN-OUT BROUGHT INTO THE PROPERTY OR CLEAN-OUTS SHALL BE INSTALLED ACCORDING TO THE APPLICABLE SPECIFICATIONS.
2. LOCATION OF CLEAN-OUT TO BE ETCHED PERPENDICULAR AT CURB OR EDGE OF ASPHALT WITH BRASS DISC WITH NUMBER OF FEET. REFER TO THE SARASOTA COUNTY UTILITY STANDARDS MANUAL.
3. THE WASTEWATER SERVICE LATERAL SHALL NOT BE DEEPER THAN 5 FEET FROM FINISHED (FINAL) GRADE, TOP BACK OF CURB, OR EDGE OF PAVEMENT.
4. WHEN THE WASTEWATER SERVICE LATERAL CLEAN-OUT IS IN PAVED AREAS (CONCRETE OR ASPHALT) A TRAFFIC BEARING POURED IN PLACE CONCRETE PAD AND VALVE BOX AND COVER SHALL BE USED AS SHOWN IN SEWER DRAWING DETAIL NO. 11.
5. SERVICE CLEAN-OUT TO SERVICE CLEAN-OUT TO EXTEND 2-FEET MIN ABOVE FINISH GRADE AT PRELIMINARY UTILITY INSPECTION. SET TO FINAL GRADE AT TIME OF PLUMBER'S TIE-IN, REQUIRED FOR C.O.

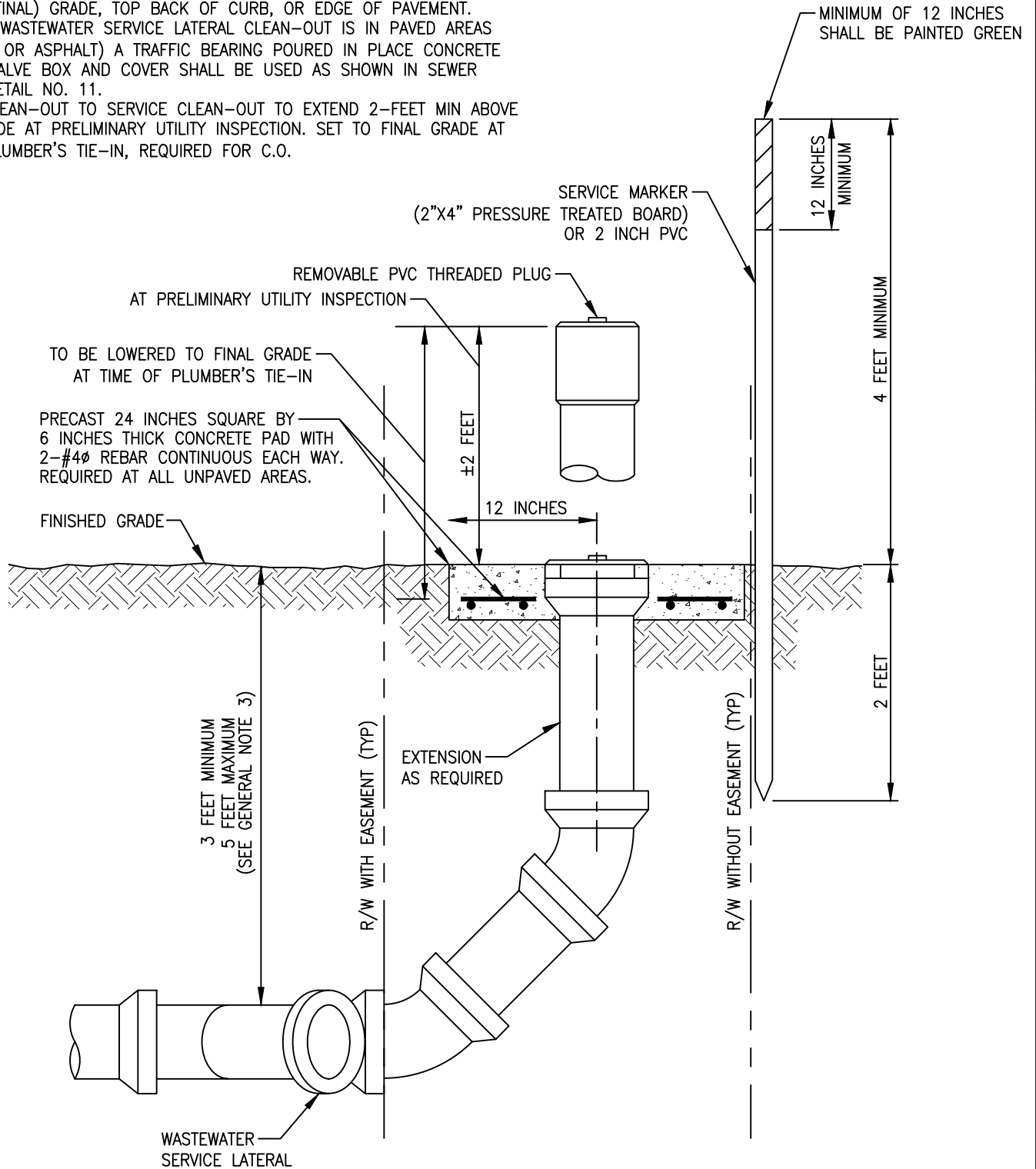

N.T.S.